

First Floor

Approx. 38.5 sq. metres (414.7 sq. feet)

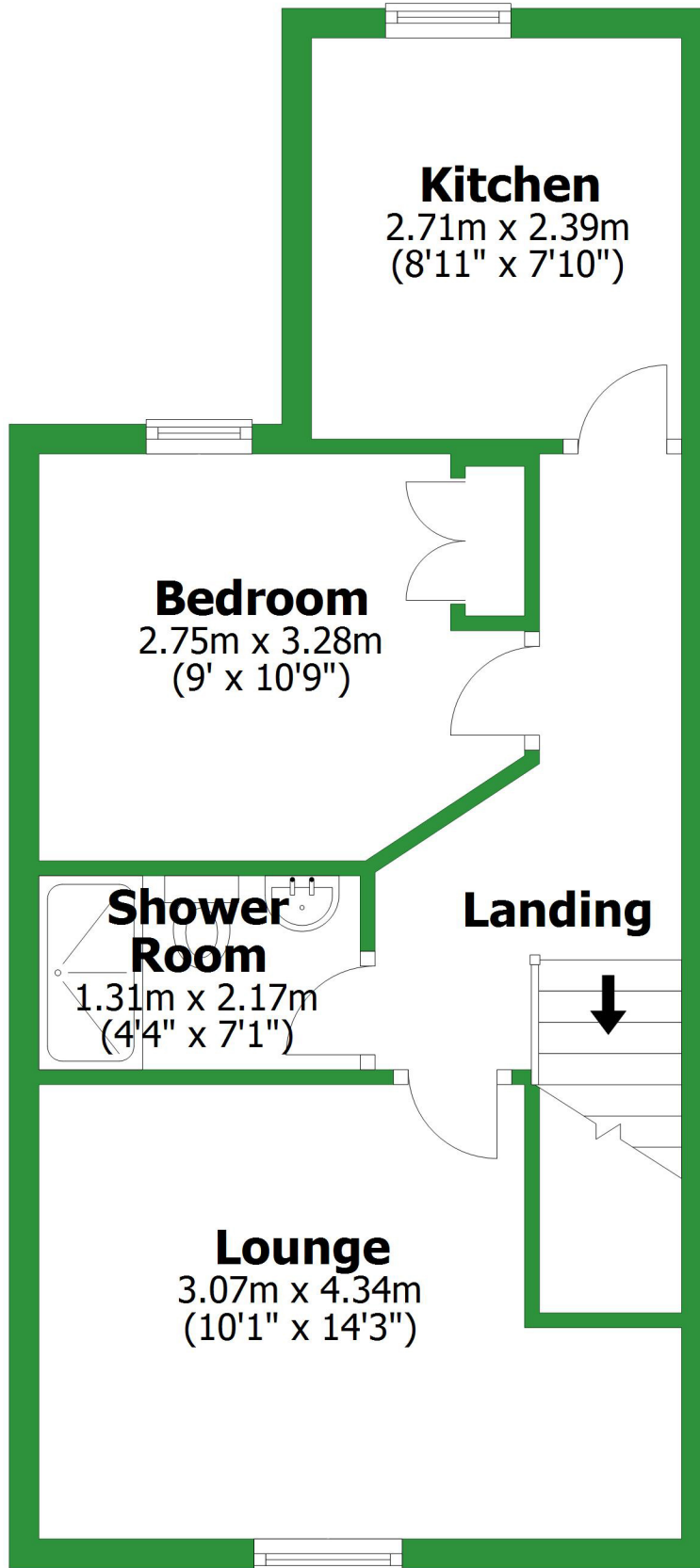

Total area: approx. 38.5 sq. metres (414.7 sq. feet)

For illustrative purposes only. Not to scale. All sizes are approximate.

Plan produced using PlanUp.

First Floor

Approx. 38.5 sq. metres (414.7 sq. feet)

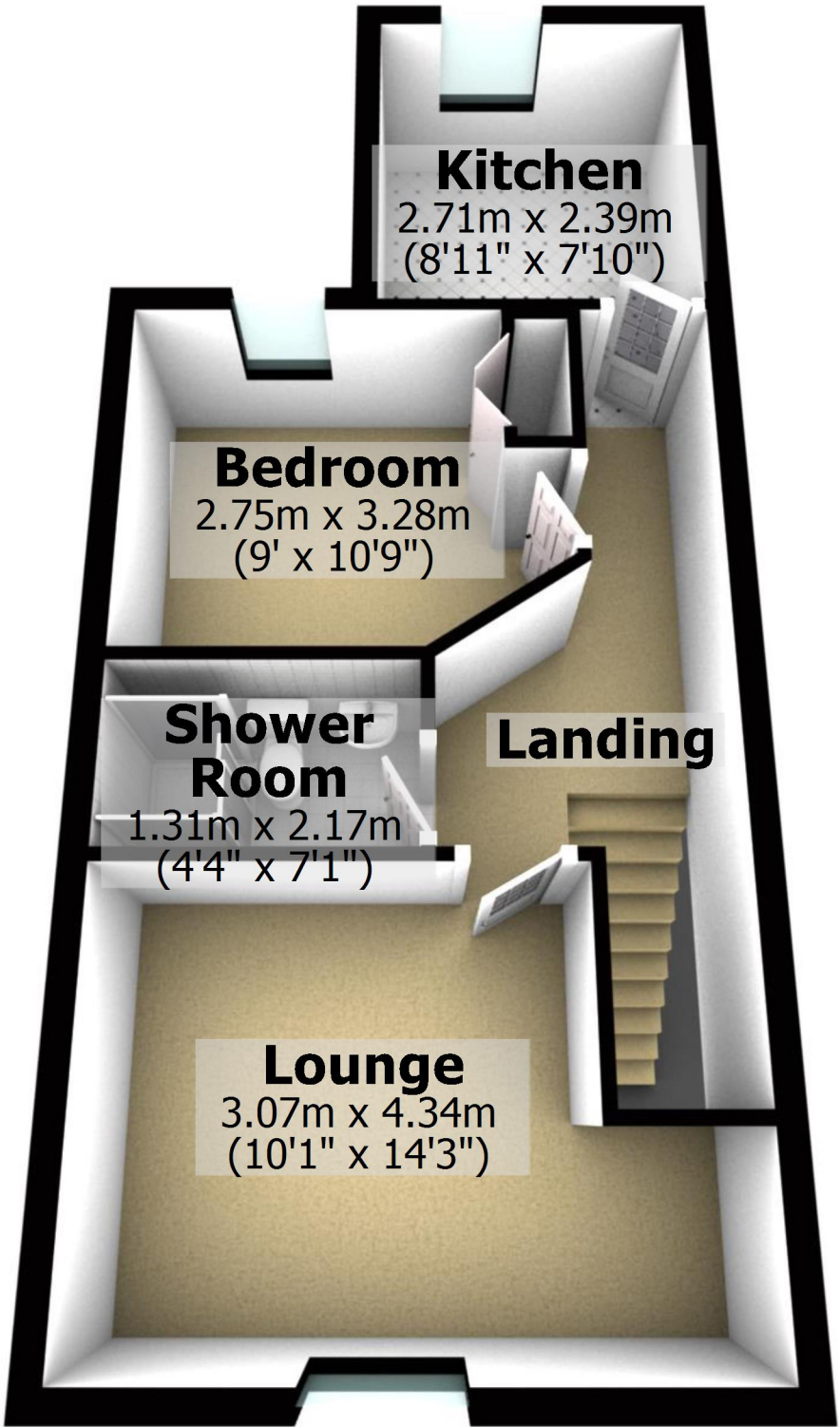

Kitchen

2.71m x 2.39m
(8'11" x 7'10")

Bedroom

2.75m x 3.28m
(9' x 10'9")

Shower Room

1.31m x 2.17m
(4'4" x 7'1")

Landing

Lounge

3.07m x 4.34m
(10'1" x 14'3")