

# Ground Floor

Approx. 105.6 sq. metres (1136.9 sq. feet)

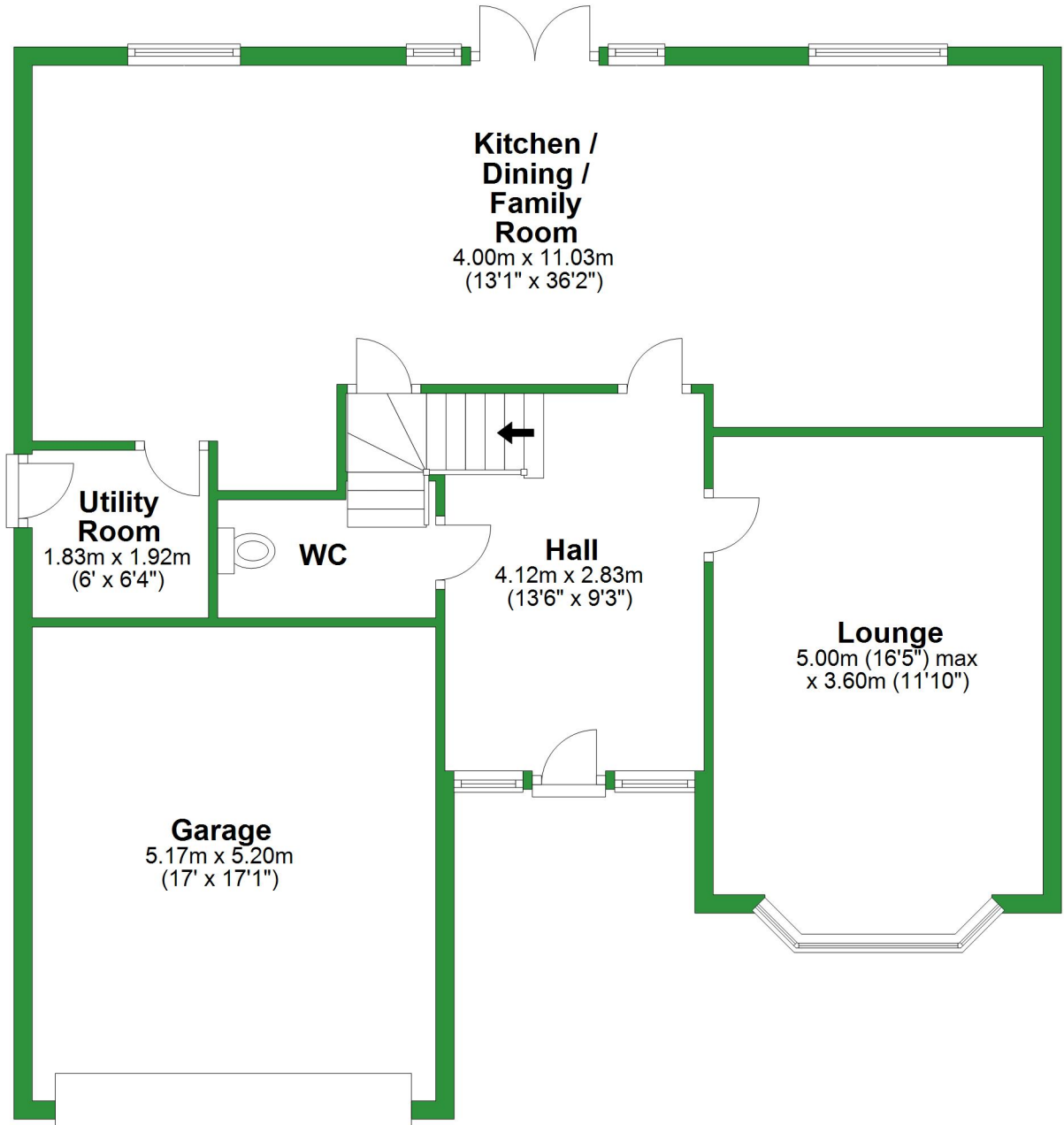

Total area: approx. 183.1 sq. metres (1970.8 sq. feet)

For illustrative purposes only. Not to scale. All sizes are approximate.  
Plan produced using PlanUp.

# First Floor

Approx. 77.5 sq. metres (833.9 sq. feet)

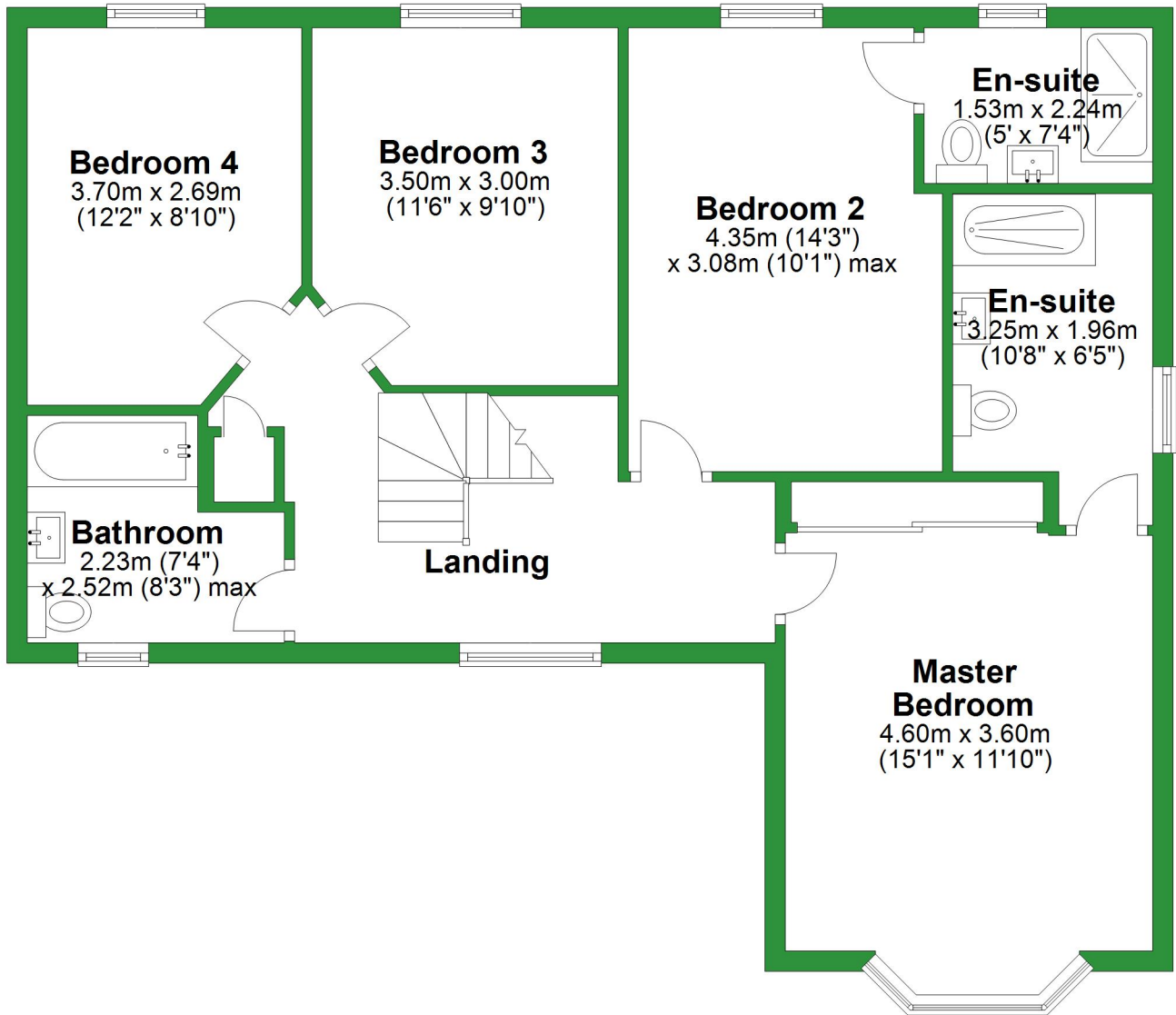

# Ground Floor

Approx. 105.6 sq. metres (1136.9 sq. feet)

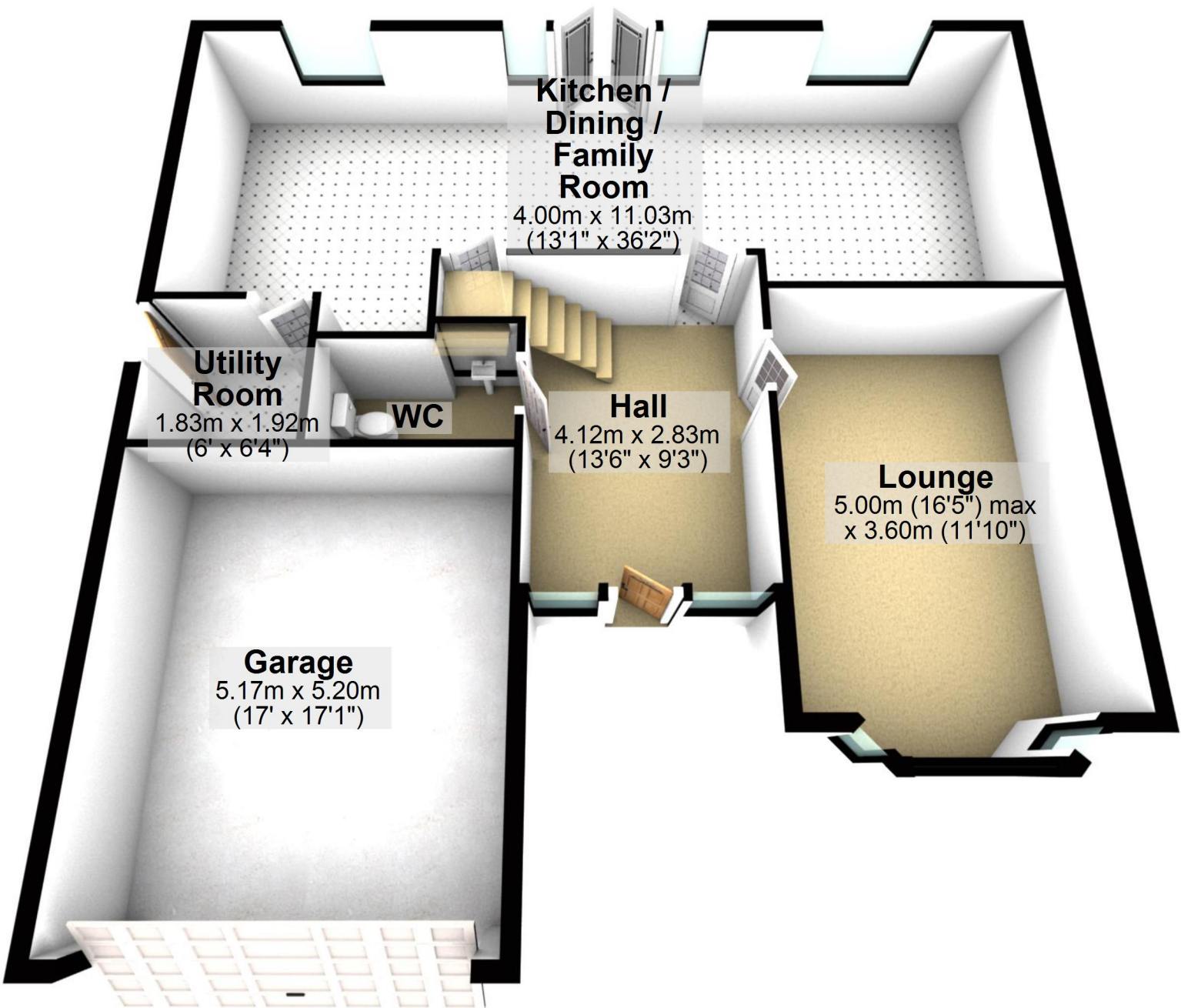

Total area: approx. 183.1 sq. metres (1970.8 sq. feet)

For illustrative purposes only. Not to scale. All sizes are approximate.  
Plan produced using PlanUp.

# First Floor

Approx. 77.5 sq. metres (833.9 sq. feet)

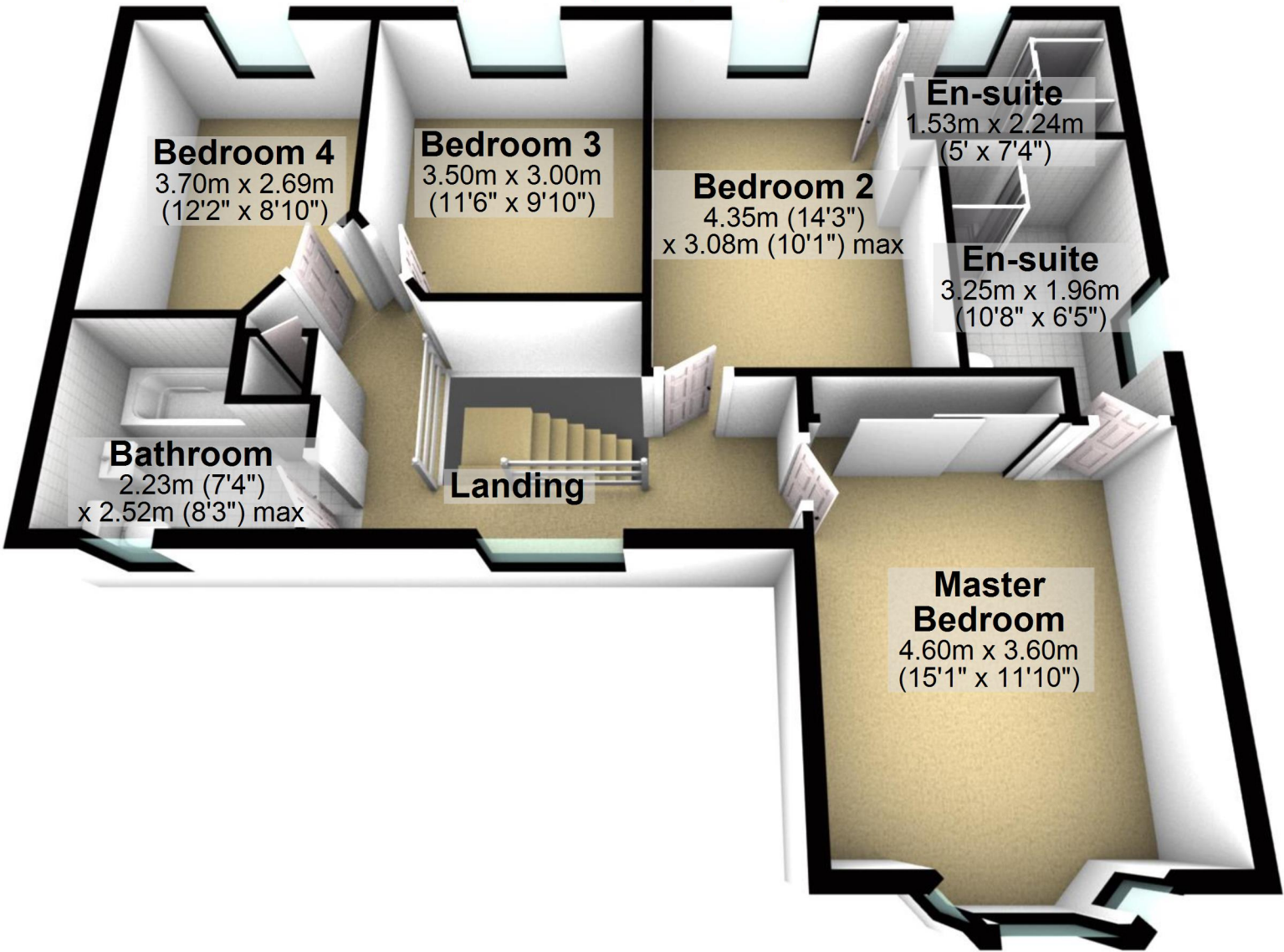

**Bedroom 4**  
3.70m x 2.69m  
(12'2" x 8'10")

**Bedroom 3**  
3.50m x 3.00m  
(11'6" x 9'10")

**Bedroom 2**  
4.35m (14'3")  
x 3.08m (10'1") max

**En-suite**  
1.53m x 2.24m  
(5' x 7'4")

**En-suite**  
3.25m x 1.96m  
(10'8" x 6'5")

**Bathroom**  
2.23m (7'4")  
x 2.52m (8'3") max

**Landing**

**Master  
Bedroom**  
4.60m x 3.60m  
(15'1" x 11'10")