

# Ground Floor

Approx. 48.8 sq. metres (524.9 sq. feet)

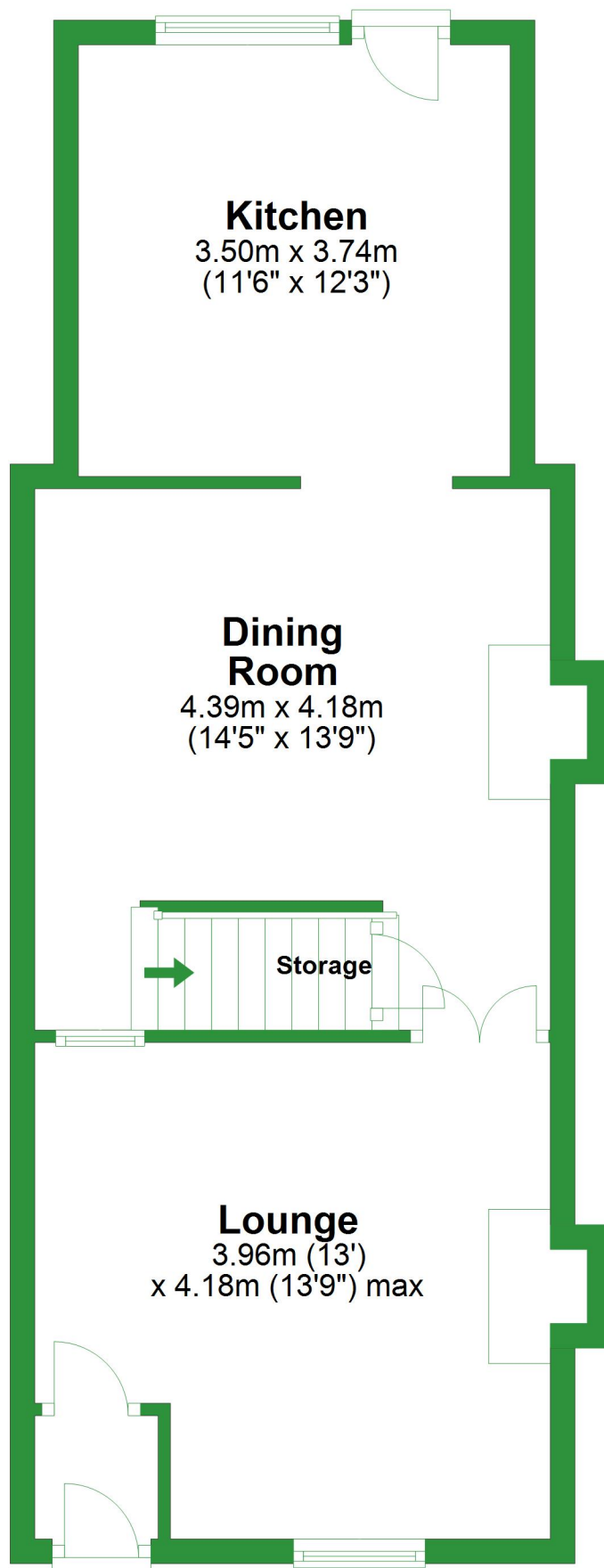

Total area: approx. 84.2 sq. metres (906.4 sq. feet)

For illustrative purposes only. Not to scale. All sizes are approximate.  
Plan produced using PlanUp.

# First Floor

Approx. 35.4 sq. metres (381.5 sq. feet)



# Ground Floor

Approx. 48.8 sq. metres (524.9 sq. feet)

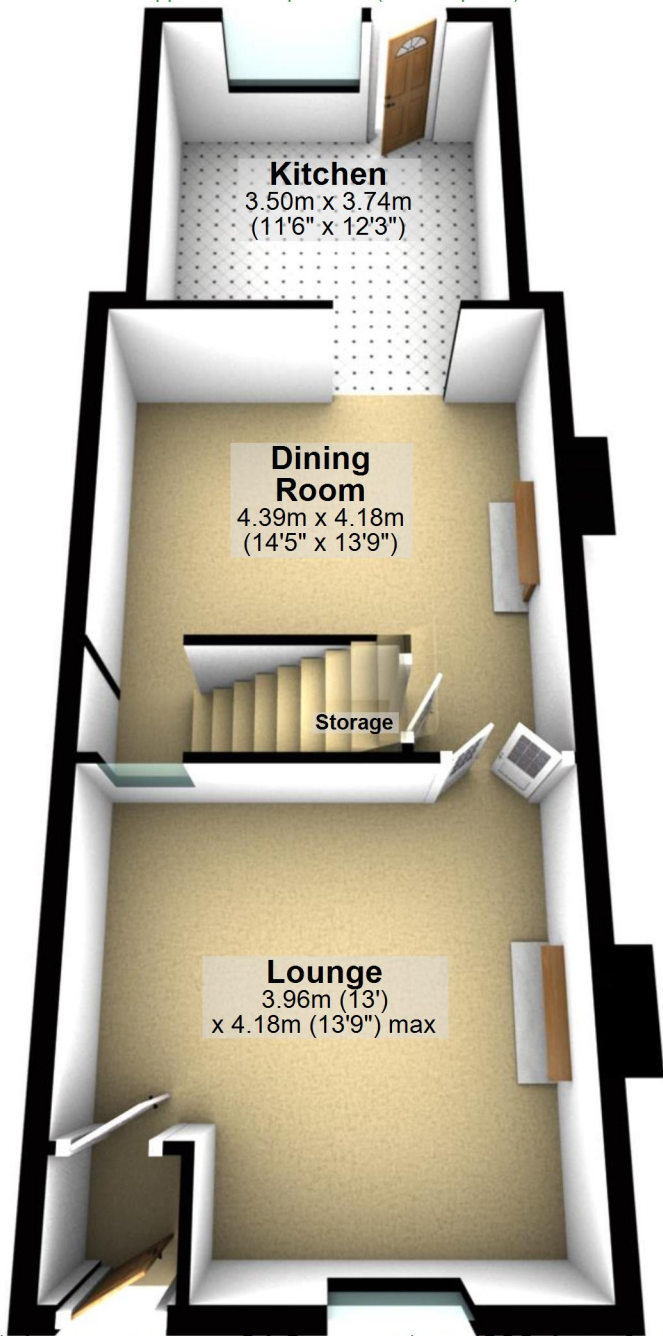

Total area: approx. 84.2 sq. metres (906.4 sq. feet)

For illustrative purposes only. Not to scale. All sizes are approximate.

Plan produced using PlanUp.

## First Floor

Approx. 35.4 sq. metres (381.5 sq. feet)

