

# Ground Floor

Approx. 35.8 sq. metres (385.8 sq. feet)

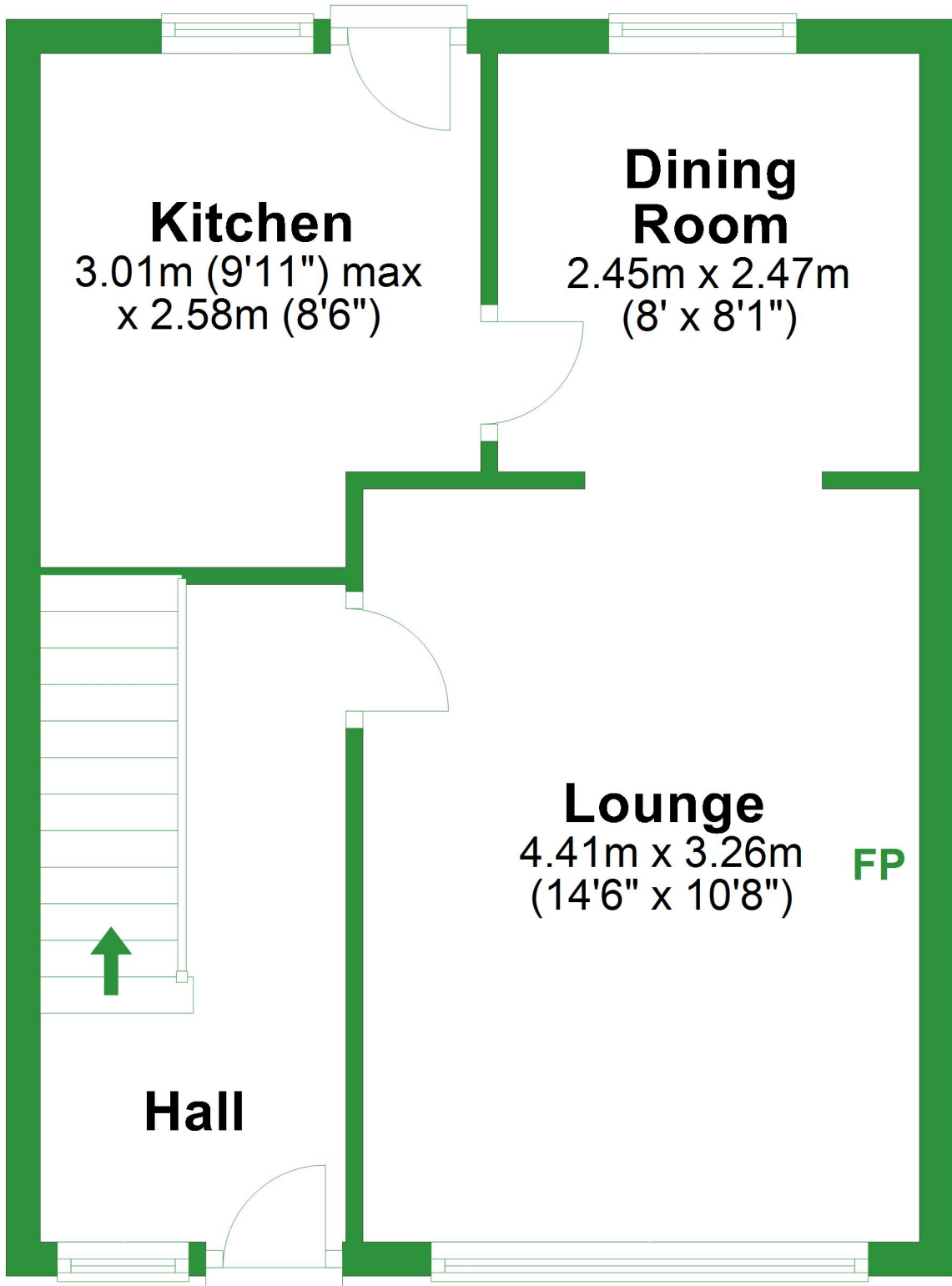

Total area: approx. 71.6 sq. metres (770.7 sq. feet)

For illustrative purposes only. Not to scale. All sizes are approximate.

Plan produced using PlanUp.

# First Floor

Approx. 35.8 sq. metres (384.8 sq. feet)

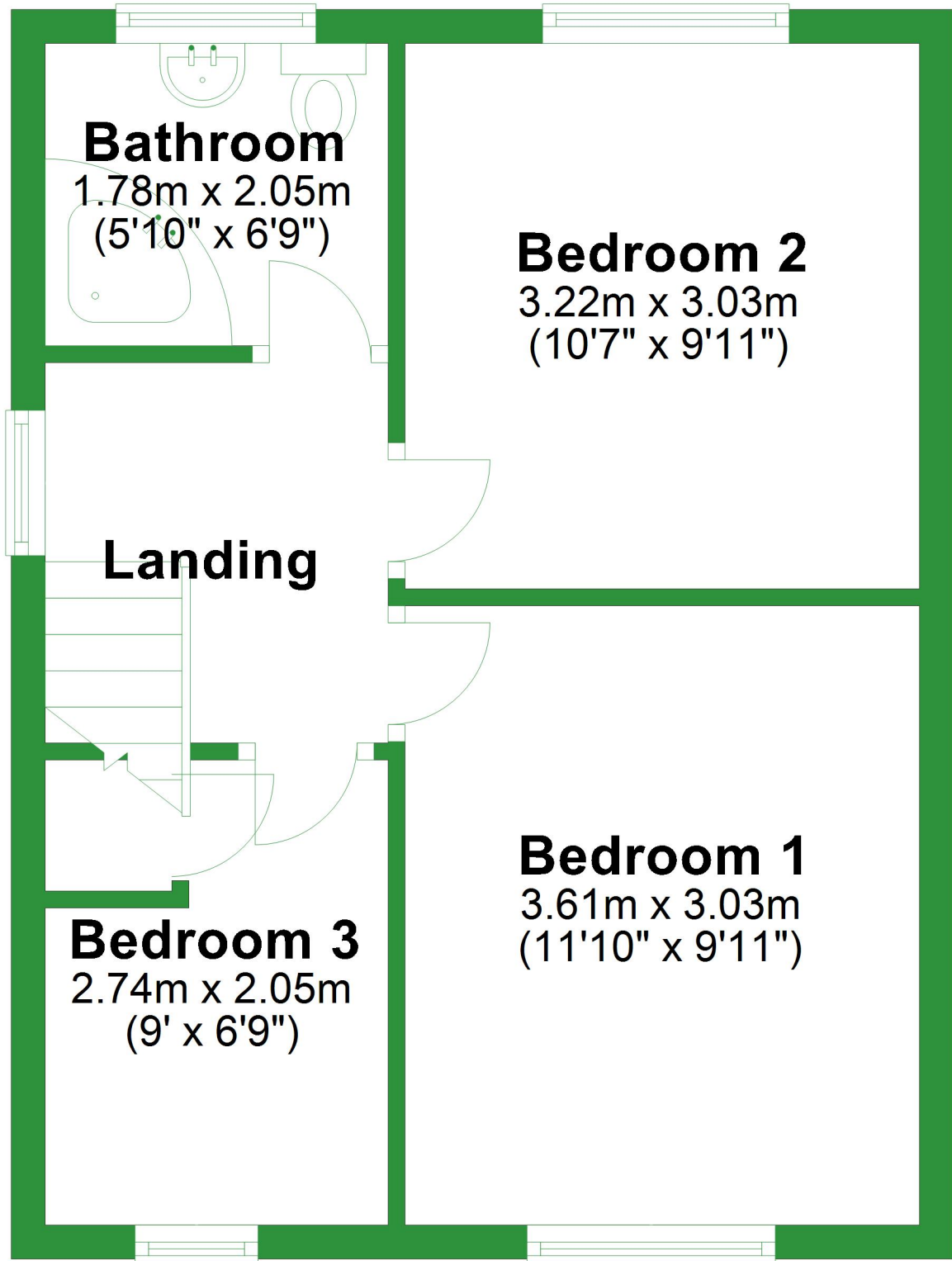

# Ground Floor

Approx. 35.8 sq. metres (385.8 sq. feet)

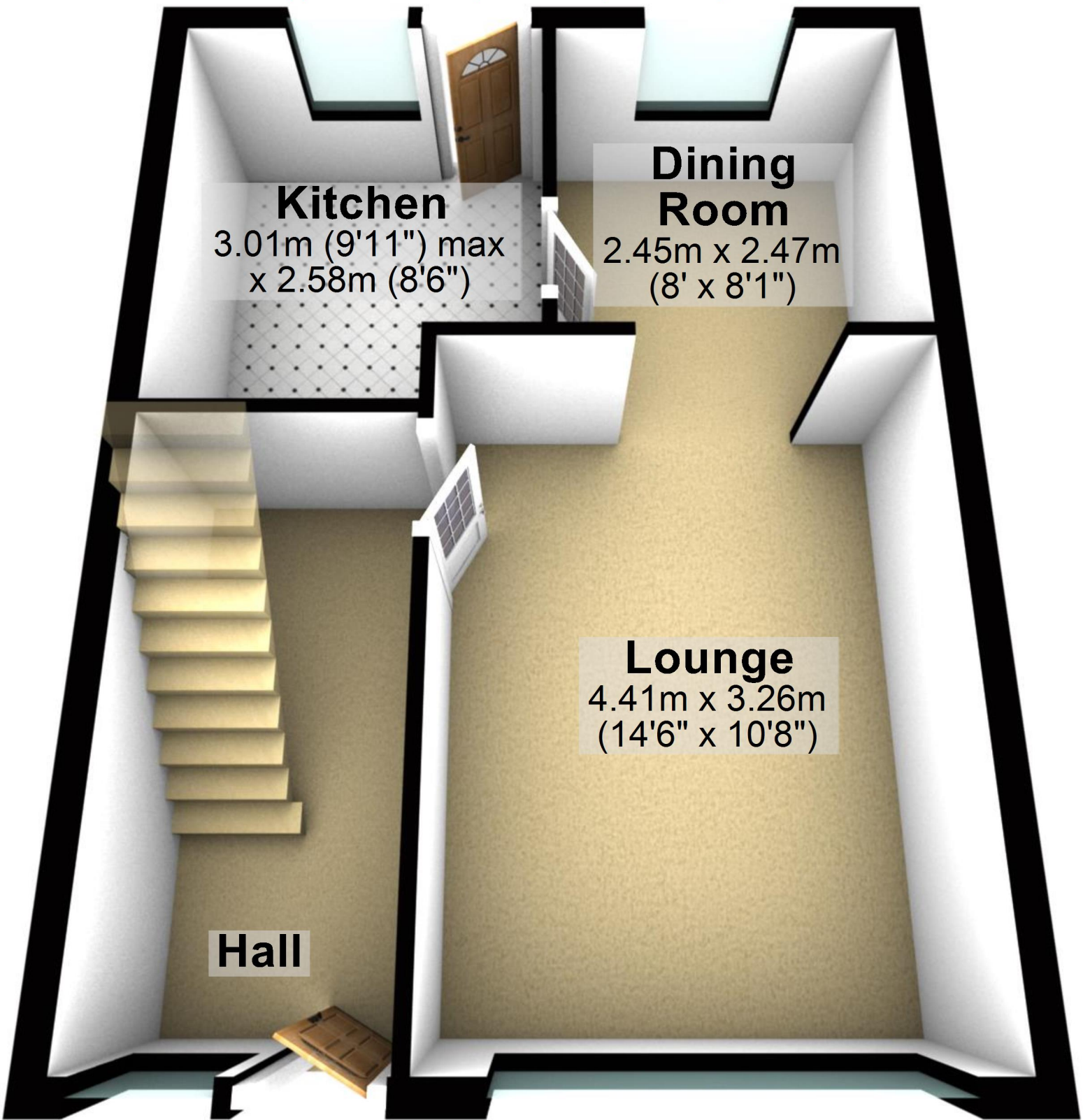

**Kitchen**  
3.01m (9'11") max  
x 2.58m (8'6")

**Dining Room**  
2.45m x 2.47m  
(8' x 8'1")

**Lounge**  
4.41m x 3.26m  
(14'6" x 10'8")

**Hall**

Total area: approx. 71.6 sq. metres (770.7 sq. feet)

For illustrative purposes only. Not to scale. All sizes are approximate.

Plan produced using PlanUp.

# First Floor

Approx. 35.8 sq. metres (384.8 sq. feet)

## Bathroom

1.78m x 2.05m  
(5'10" x 6'9")

## Bedroom 2

3.22m x 3.03m  
(10'7" x 9'11")

## Landing

## Bedroom 1

3.61m x 3.03m  
(11'10" x 9'11")

## Bedroom 3

2.74m x 2.05m  
(9' x 6'9")

