

# Ground Floor

Approx. 106.9 sq. metres (1150.4 sq. feet)

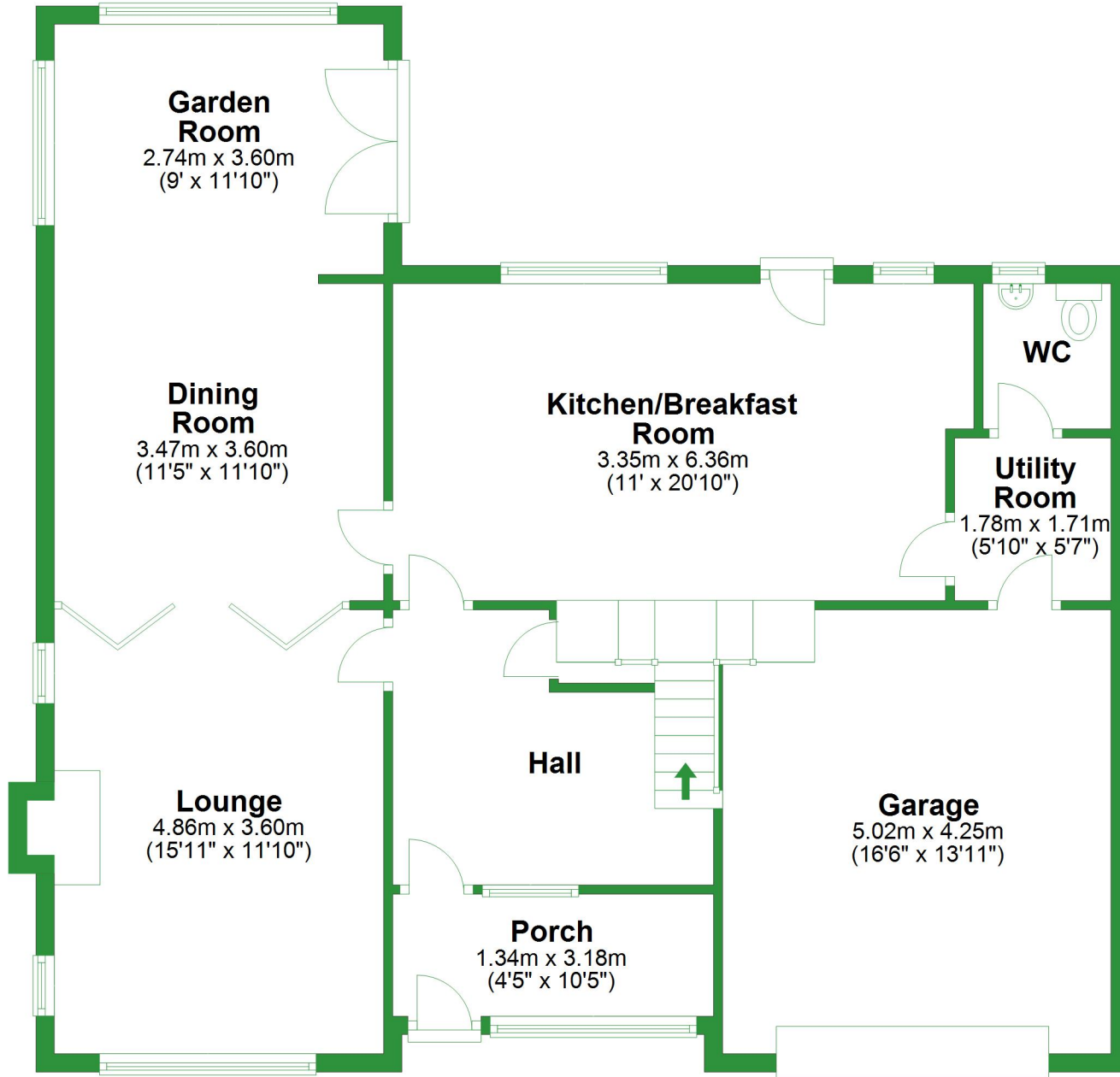

Total area: approx. 195.8 sq. metres (2107.9 sq. feet)

For illustrative purposes only. Not to scale. All sizes are approximate.  
Plan produced using PlanUp.

## First Floor

Approx. 89.0 sq. metres (957.5 sq. feet)

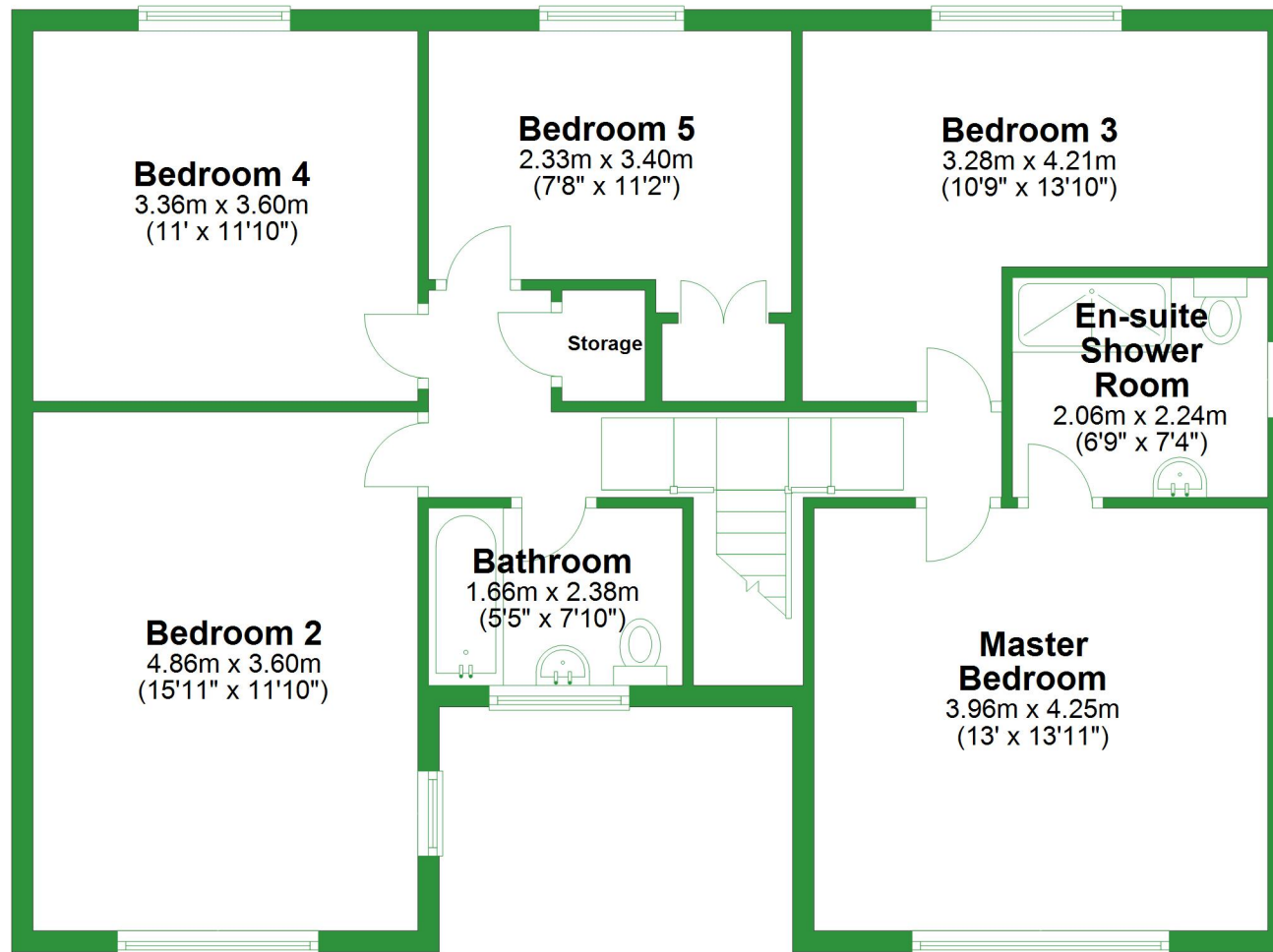

## Ground Floor

Approx. 106.9 sq. metres (1150.4 sq. feet)

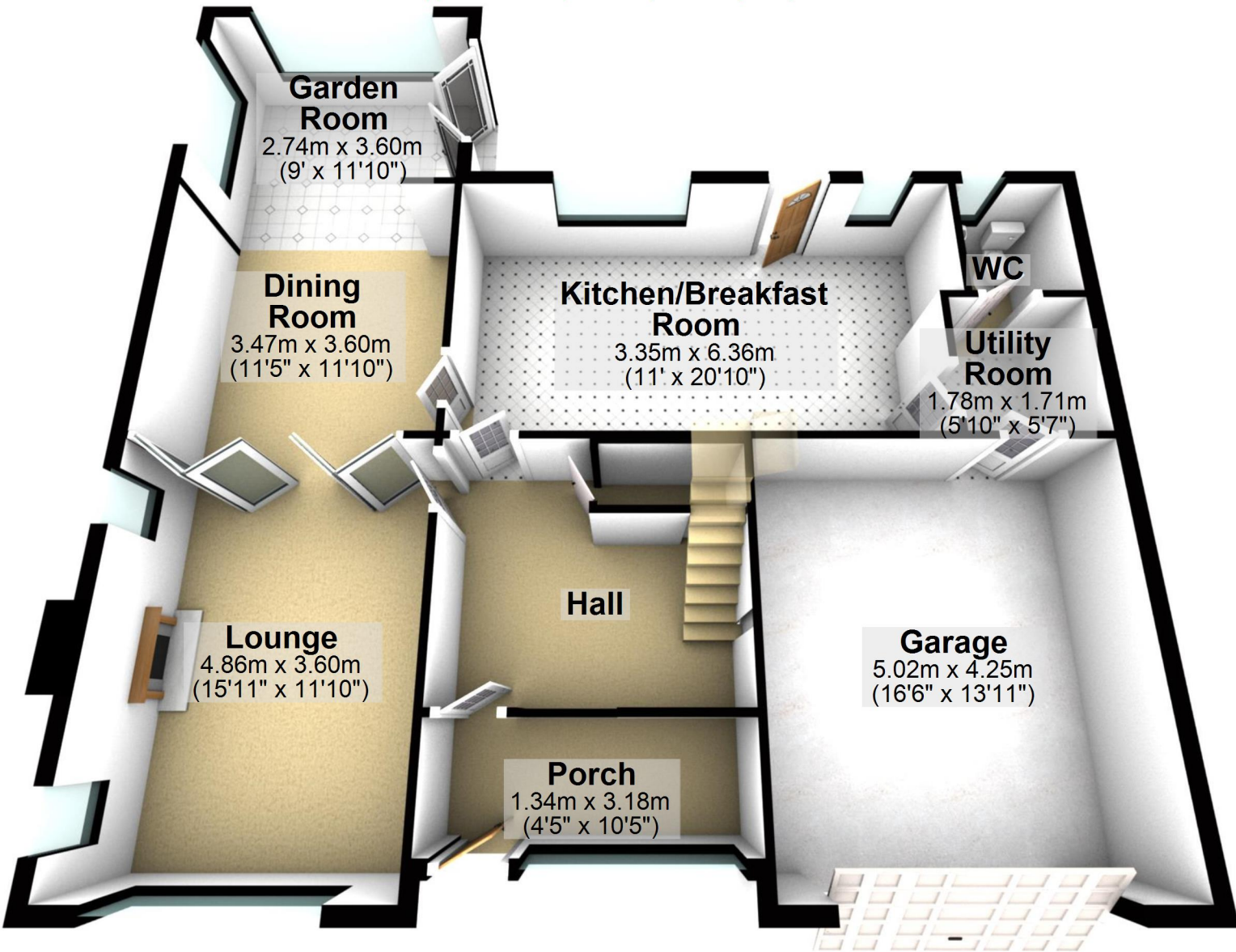

Total area: approx. 195.8 sq. metres (2107.9 sq. feet)

For illustrative purposes only. Not to scale. All sizes are approximate.

Plan produced using PlanUp.

## First Floor

Approx. 89.0 sq. metres (957.5 sq. feet)

