

# Ground Floor

Approx. 44.5 sq. metres (478.6 sq. feet)

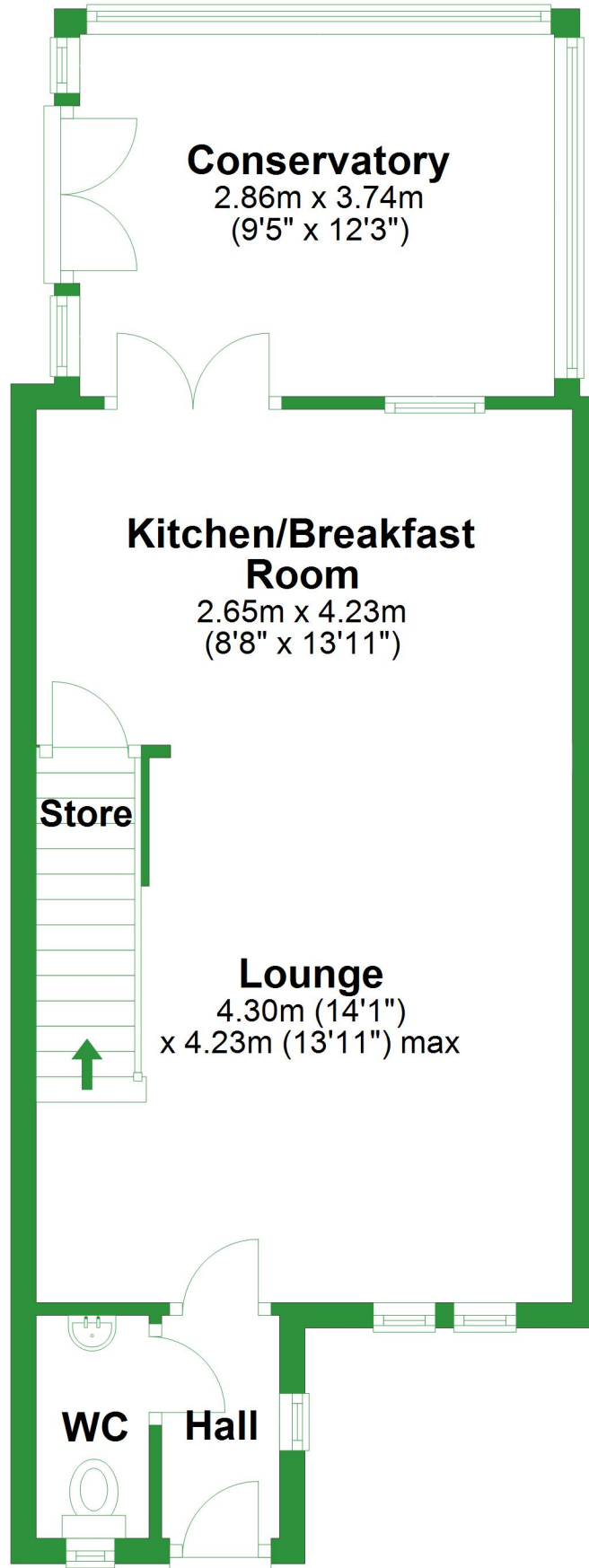

Total area: approx. 69.5 sq. metres (747.6 sq. feet)

For illustrative purposes only. Not to scale. All sizes are approximate.  
Plan produced using PlanUp.

# First Floor

Approx. 25.0 sq. metres (269.0 sq. feet)

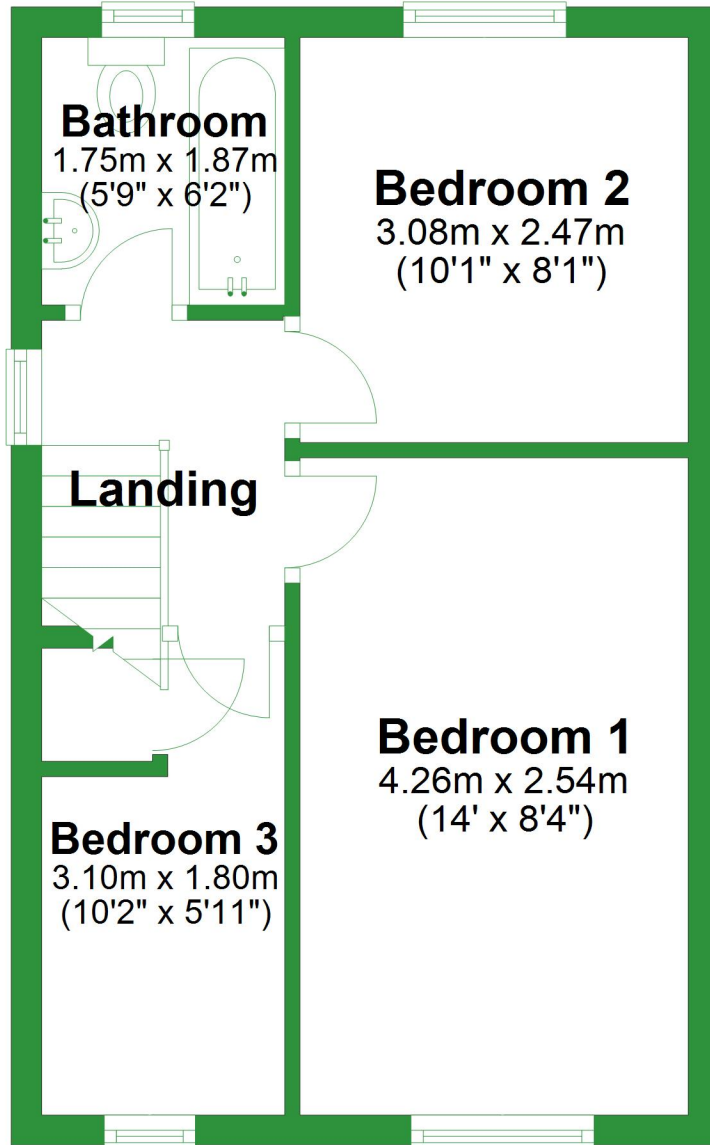

# Ground Floor

Approx. 44.5 sq. metres (478.6 sq. feet)

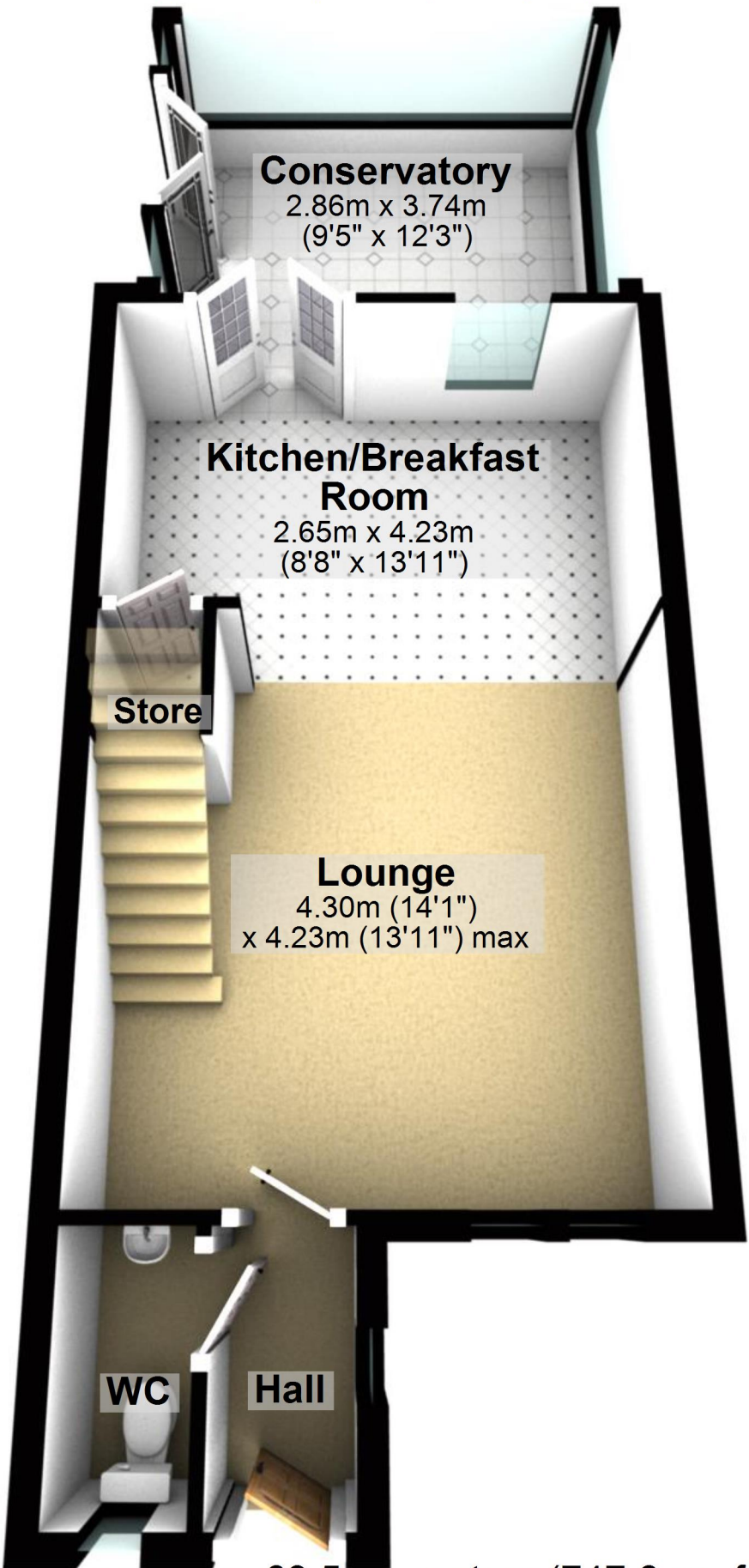

## Conservatory

2.86m x 3.74m  
(9'5" x 12'3")

## Kitchen/Breakfast Room

2.65m x 4.23m  
(8'8" x 13'11")

Store

## Lounge

4.30m (14'1")  
x 4.23m (13'11") max

WC

Hall

Total area: approx. 69.5 sq. metres (747.6 sq. feet)

For illustrative purposes only. Not to scale. All sizes are approximate.

Plan produced using PlanUp.

## First Floor

Approx. 25.0 sq. metres (269.0 sq. feet)

