

# Ground Floor

Approx. 55.3 sq. metres (595.8 sq. feet)

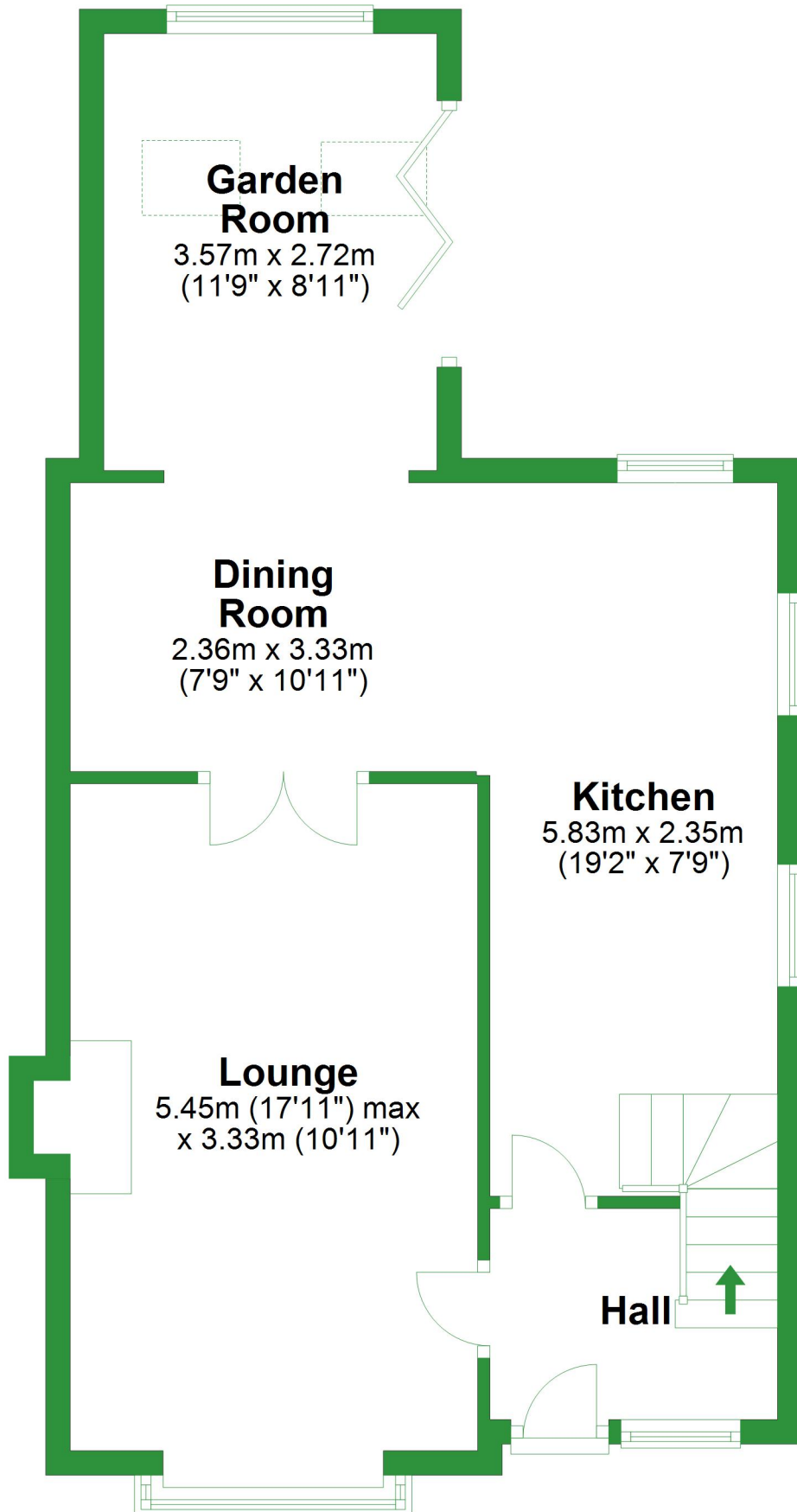

Total area: approx. 87.1 sq. metres (937.7 sq. feet)

For illustrative purposes only. Not to scale. All sizes are approximate.  
Plan produced using PlanUp.

# First Floor

Approx. 31.8 sq. metres (342.0 sq. feet)

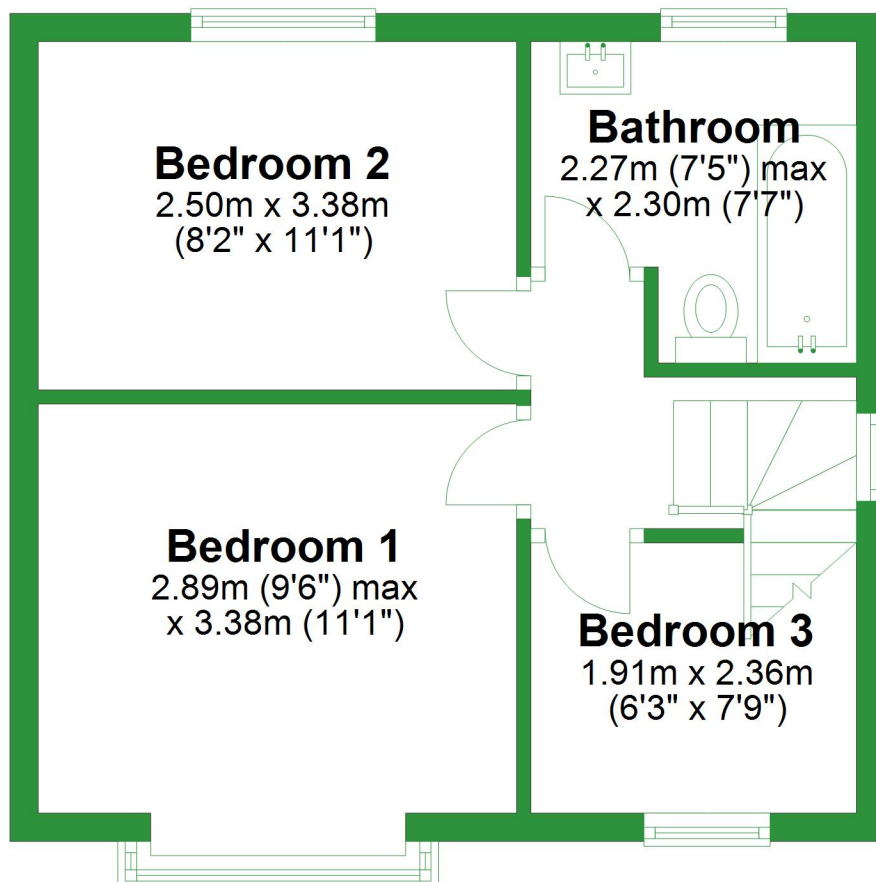

# Ground Floor

Approx. 55.3 sq. metres (595.8 sq. feet)

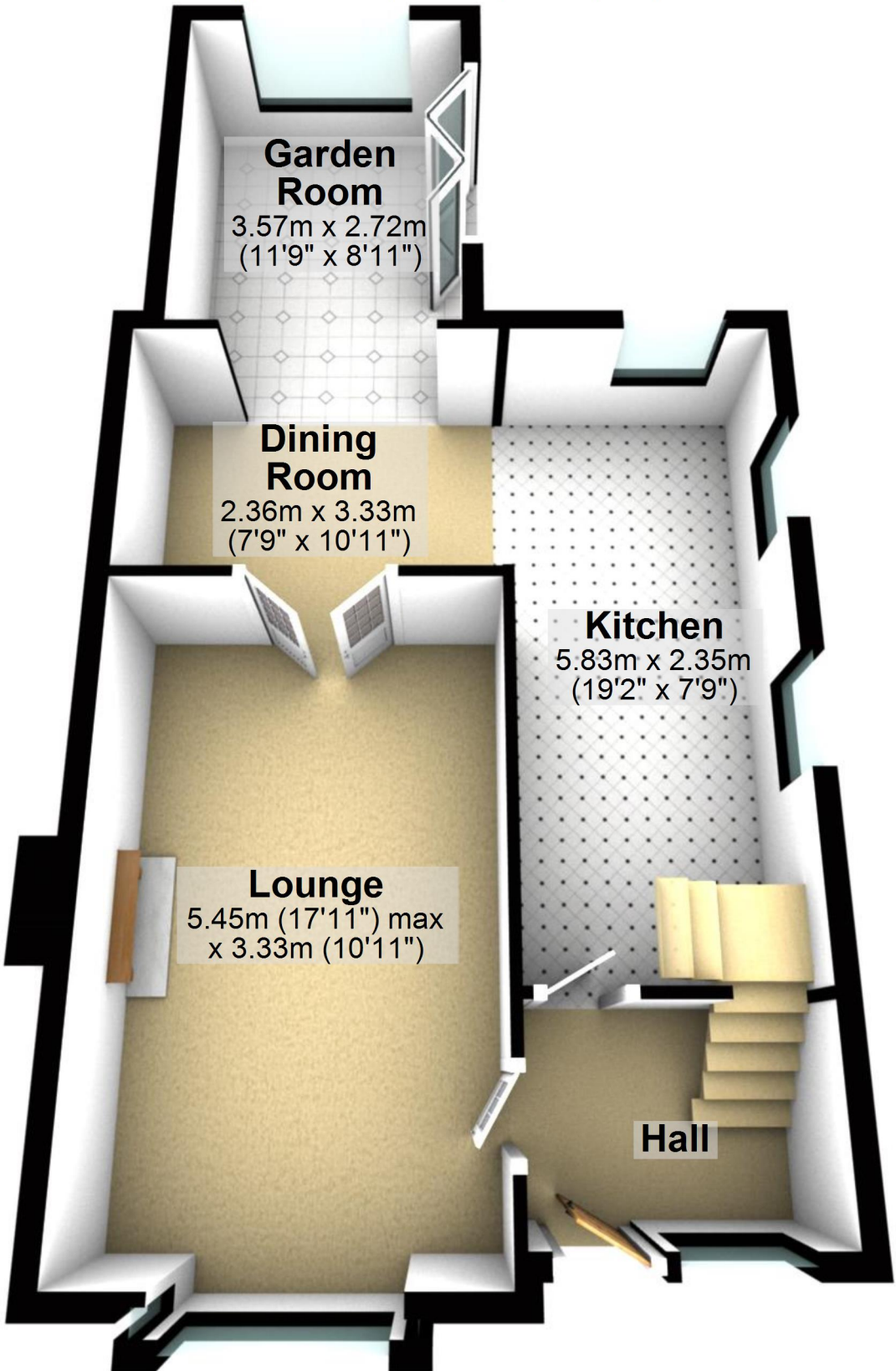

Total area: approx. 87.1 sq. metres (937.7 sq. feet)

For illustrative purposes only. Not to scale. All sizes are approximate.

Plan produced using PlanUp.

## First Floor

Approx. 31.8 sq. metres (342.0 sq. feet)

