

# Ground Floor

Approx. 48.3 sq. metres (519.5 sq. feet)

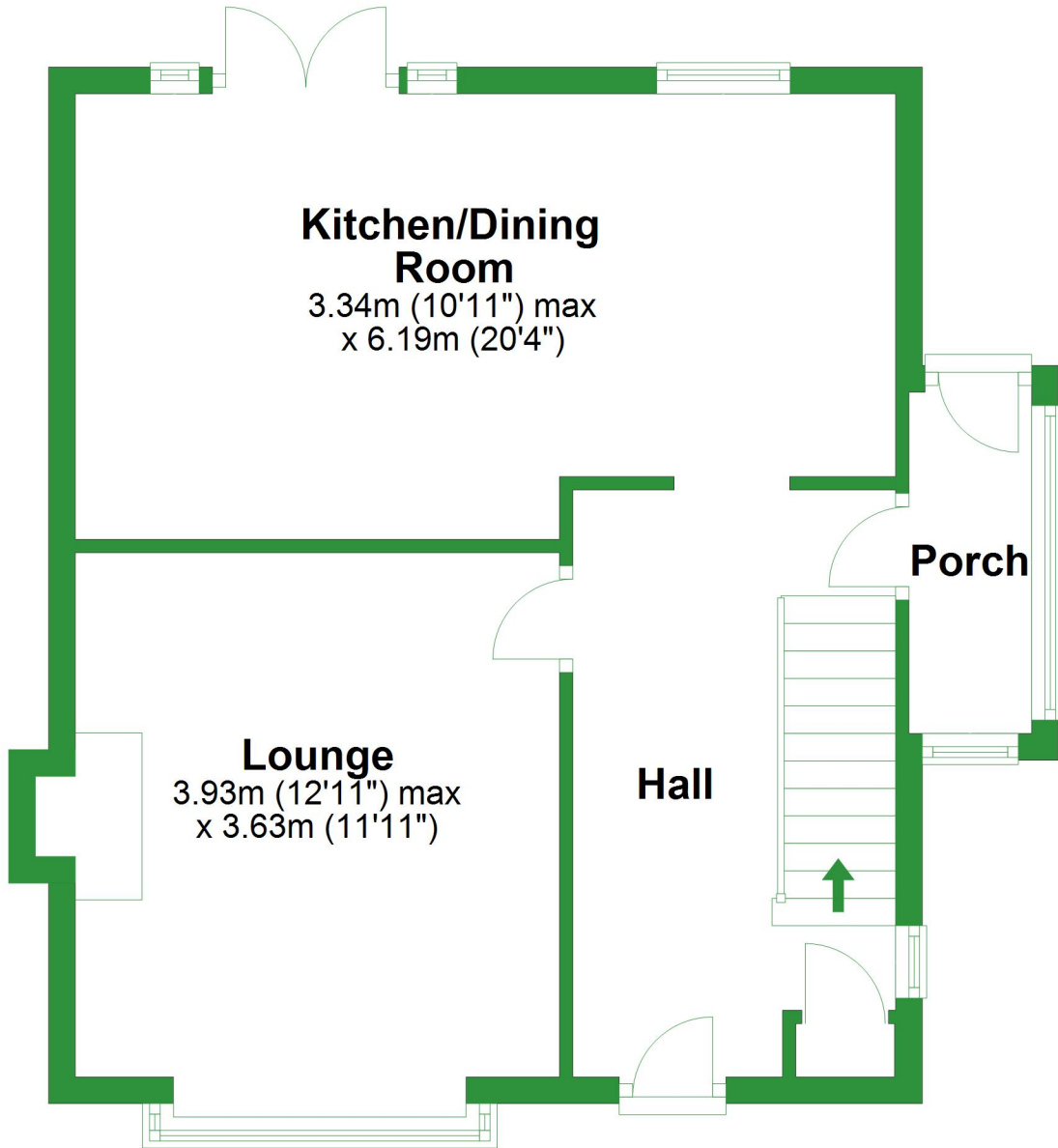

Total area: approx. 93.7 sq. metres (1008.4 sq. feet)

For illustrative purposes only. Not to scale. All sizes are approximate.  
Plan produced using PlanUp.

# First Floor

Approx. 45.4 sq. metres (488.8 sq. feet)

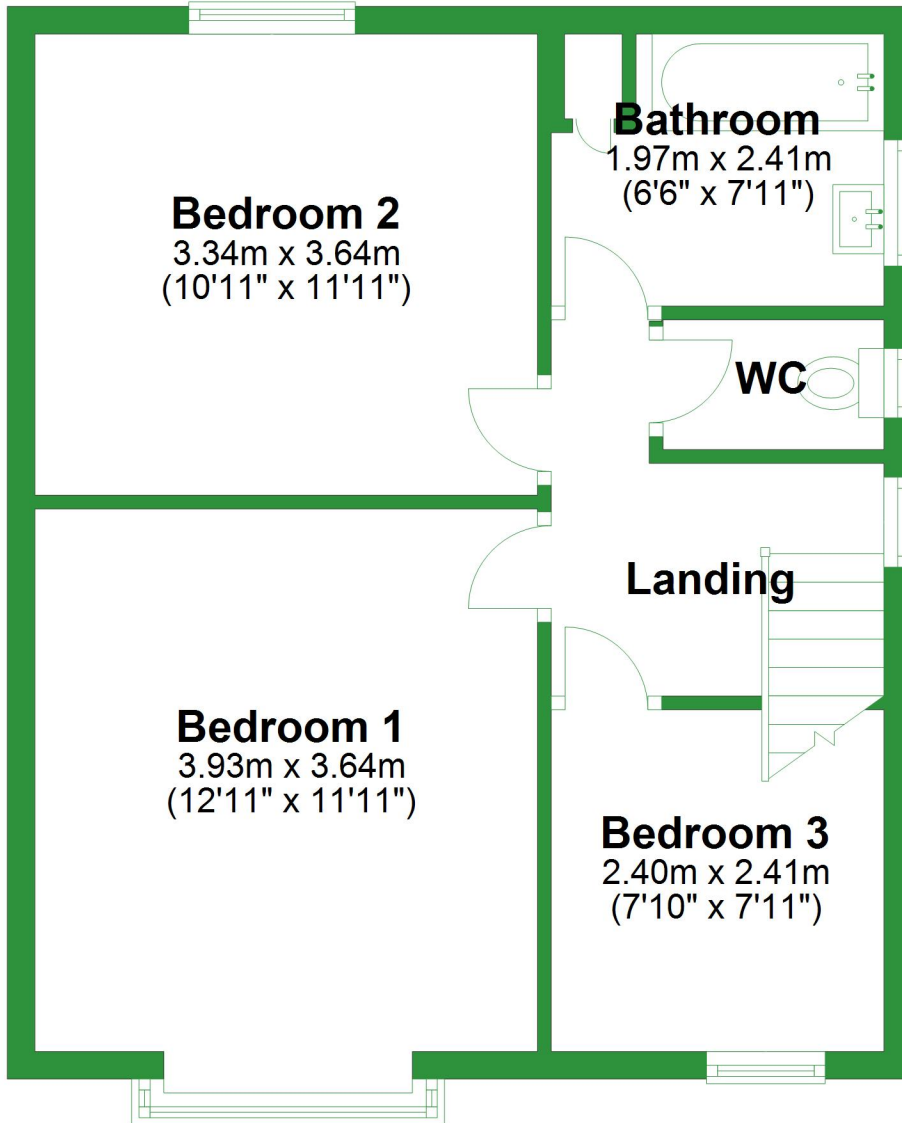

# Ground Floor

Approx. 48.3 sq. metres (519.5 sq. feet)

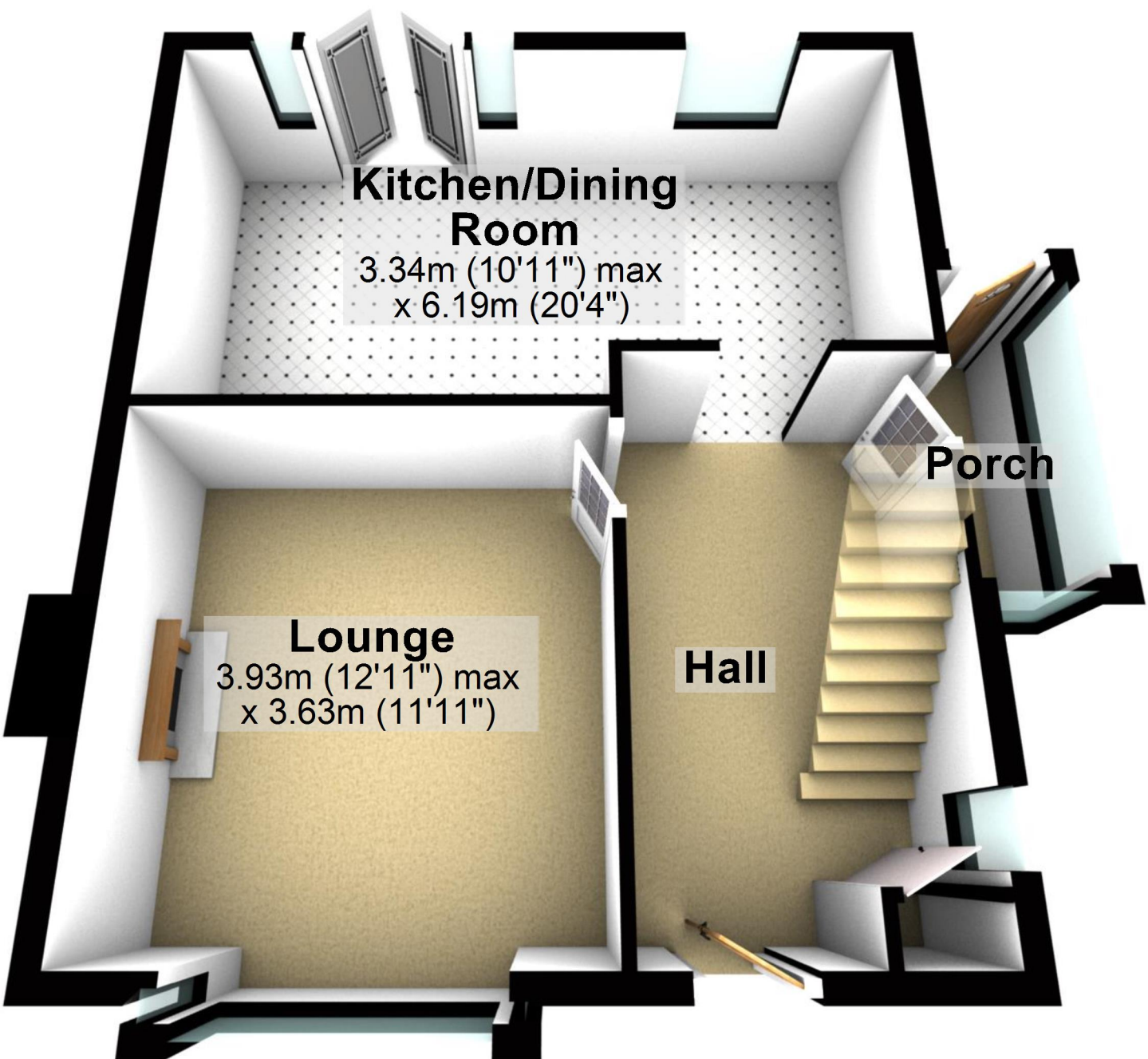

## Kitchen/Dining Room

3.34m (10'11") max  
x 6.19m (20'4")

## Lounge

3.93m (12'11") max  
x 3.63m (11'11")

## Hall

## Porch

Total area: approx. 93.7 sq. metres (1008.4 sq. feet)

For illustrative purposes only. Not to scale. All sizes are approximate.

Plan produced using PlanUp.

# First Floor

Approx. 45.4 sq. metres (488.8 sq. feet)

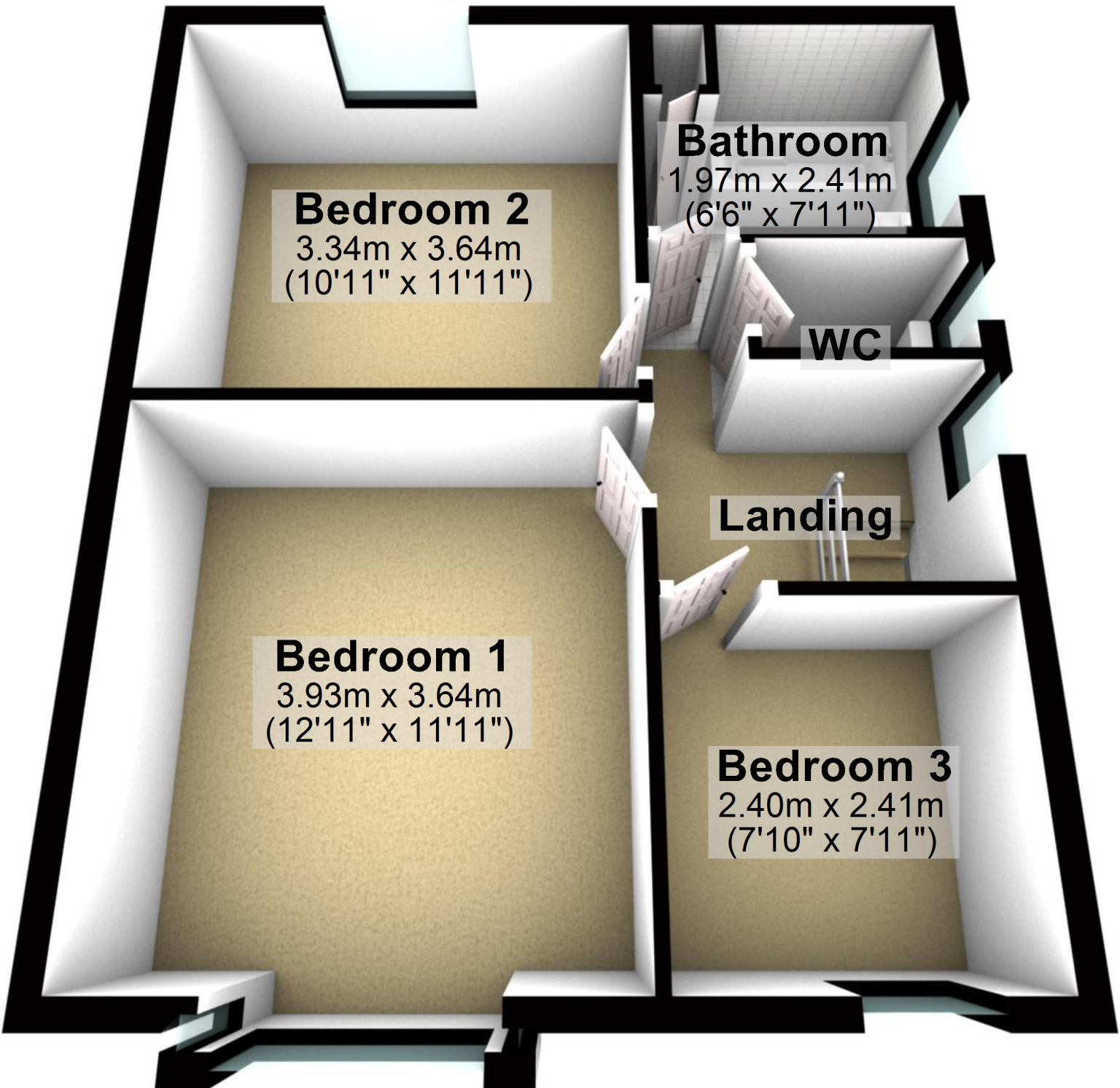

## Bedroom 2

3.34m x 3.64m  
(10'11" x 11'11")

## Bathroom

1.97m x 2.41m  
(6'6" x 7'11")

## WC

## Landing

## Bedroom 1

3.93m x 3.64m  
(12'11" x 11'11")

## Bedroom 3

2.40m x 2.41m  
(7'10" x 7'11")