

# Ground Floor

Approx. 82.1 sq. metres (883.8 sq. feet)

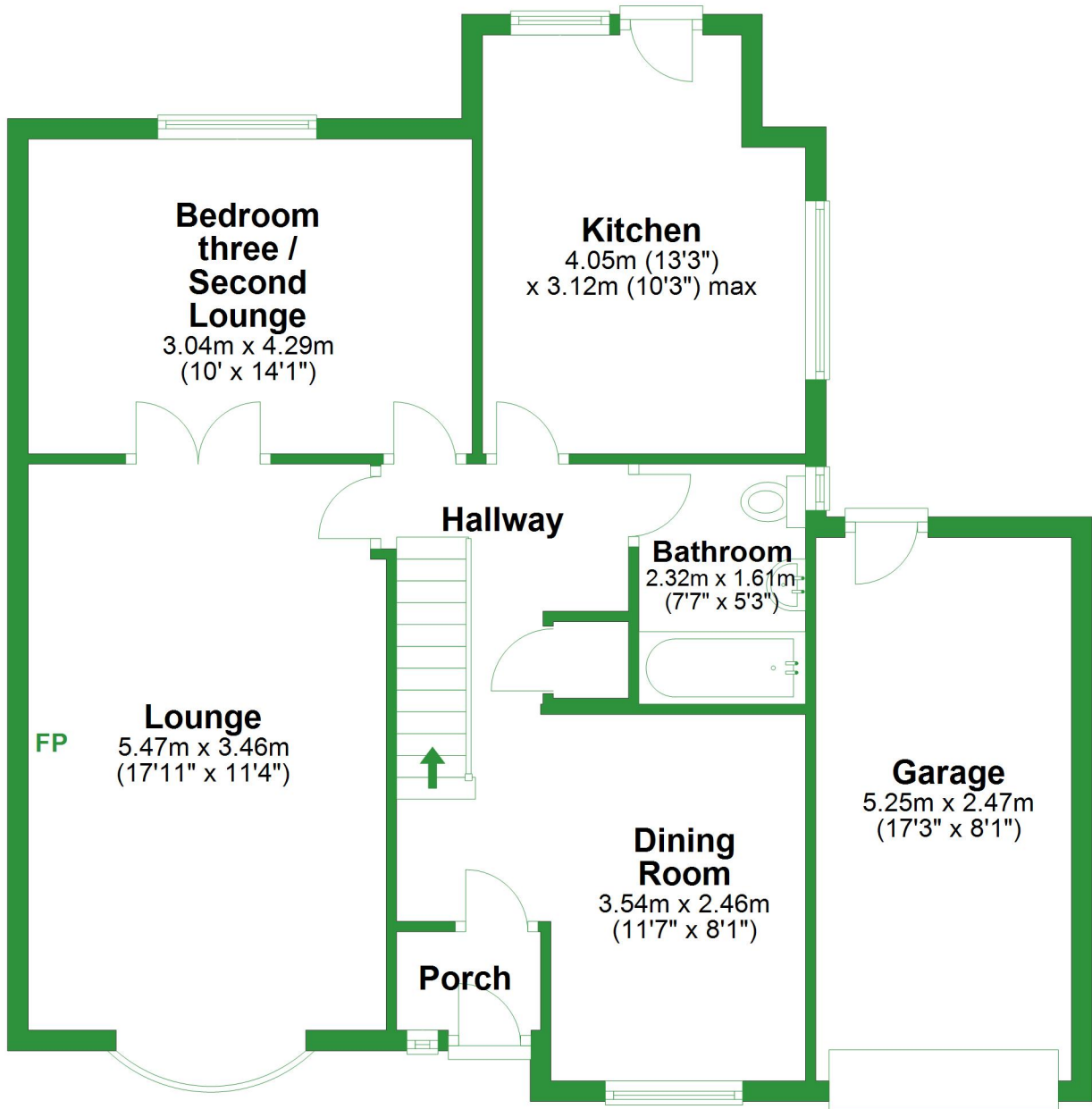

Total area: approx. 128.6 sq. metres (1384.2 sq. feet)

For illustrative purposes only. Not to scale. All sizes are approximate.

Plan produced using PlanUp.

# First Floor

Approx. 46.5 sq. metres (500.4 sq. feet)

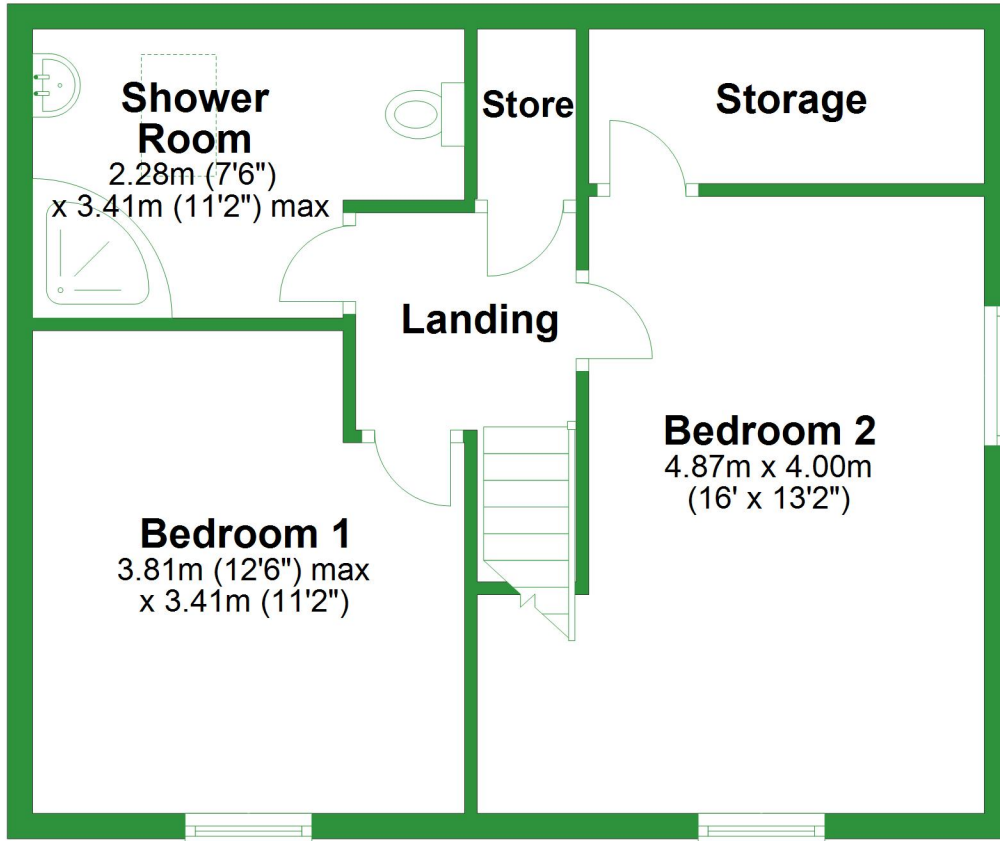

## Ground Floor

Approx. 82.1 sq. metres (883.8 sq. feet)

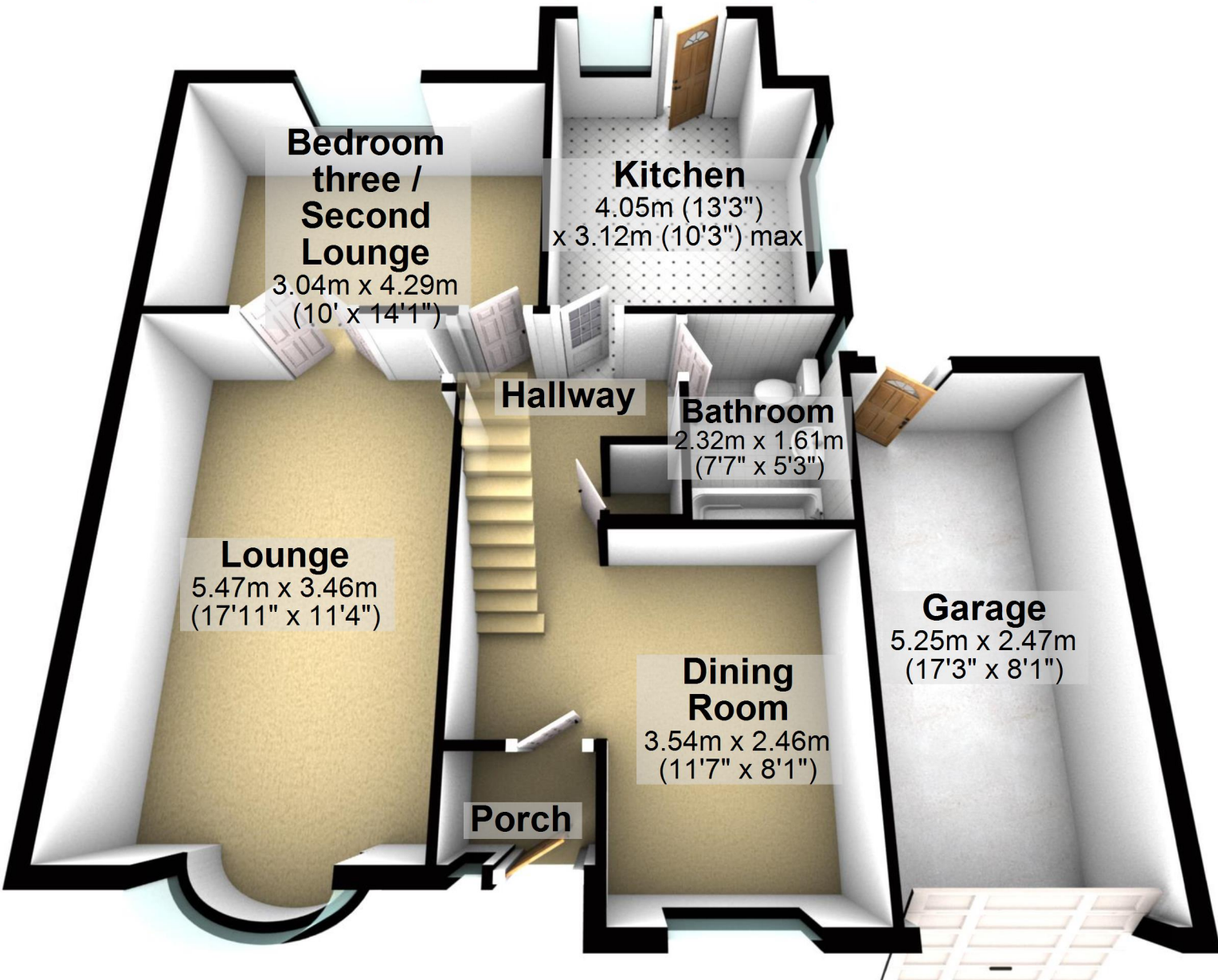

Total area: approx. 128.6 sq. metres (1384.2 sq. feet)

For illustrative purposes only. Not to scale. All sizes are approximate.

Plan produced using PlanUp.

## First Floor

Approx. 46.5 sq. metres (500.4 sq. feet)

