

# Ground Floor

Approx. 54.7 sq. metres (589.0 sq. feet)

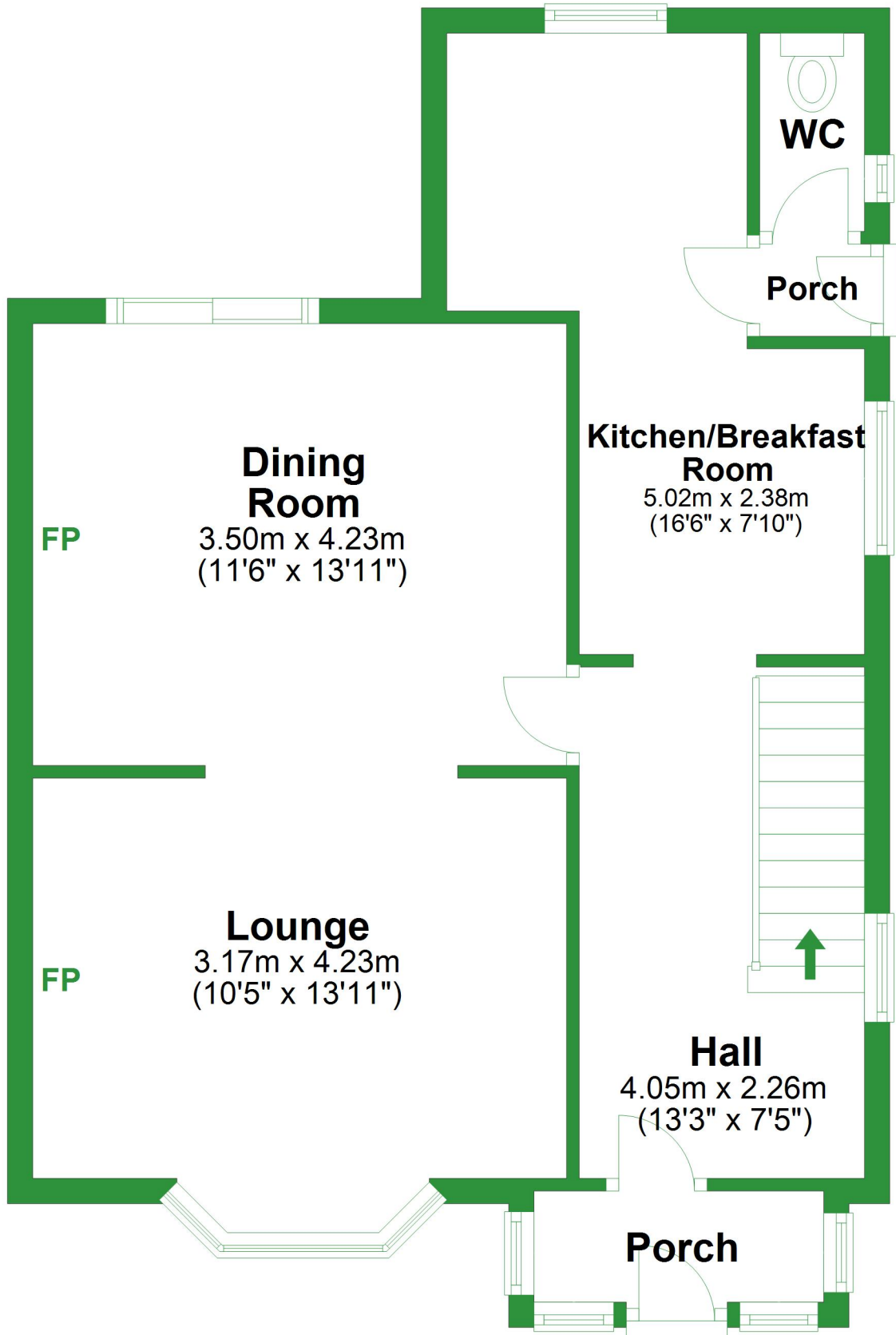

Total area: approx. 99.4 sq. metres (1069.4 sq. feet)

For illustrative purposes only. Not to scale. All sizes are approximate.

Plan produced using PlanUp.

# First Floor

Approx. 44.6 sq. metres (480.4 sq. feet)

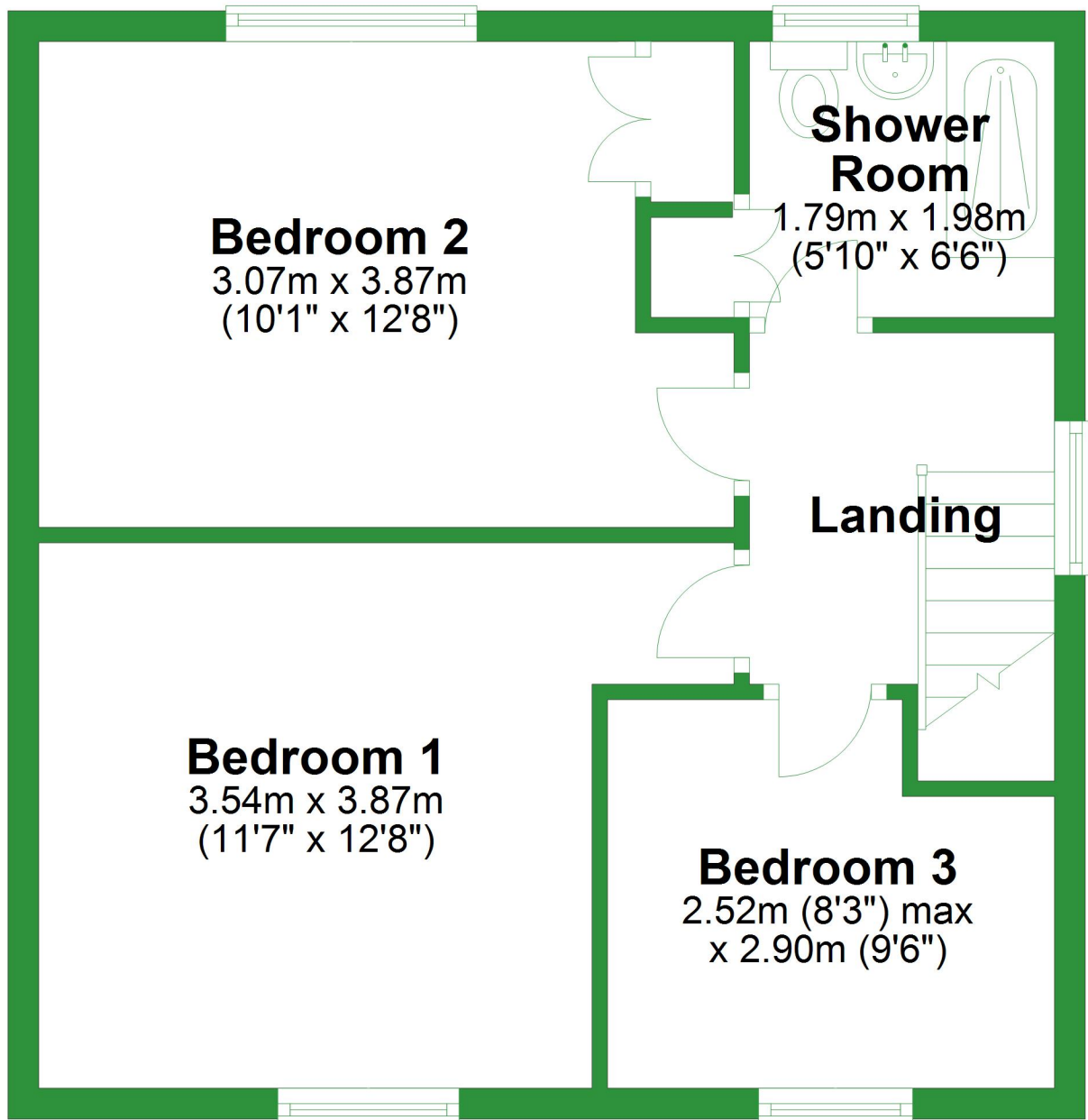

# Ground Floor

Approx. 54.7 sq. metres (589.0 sq. feet)

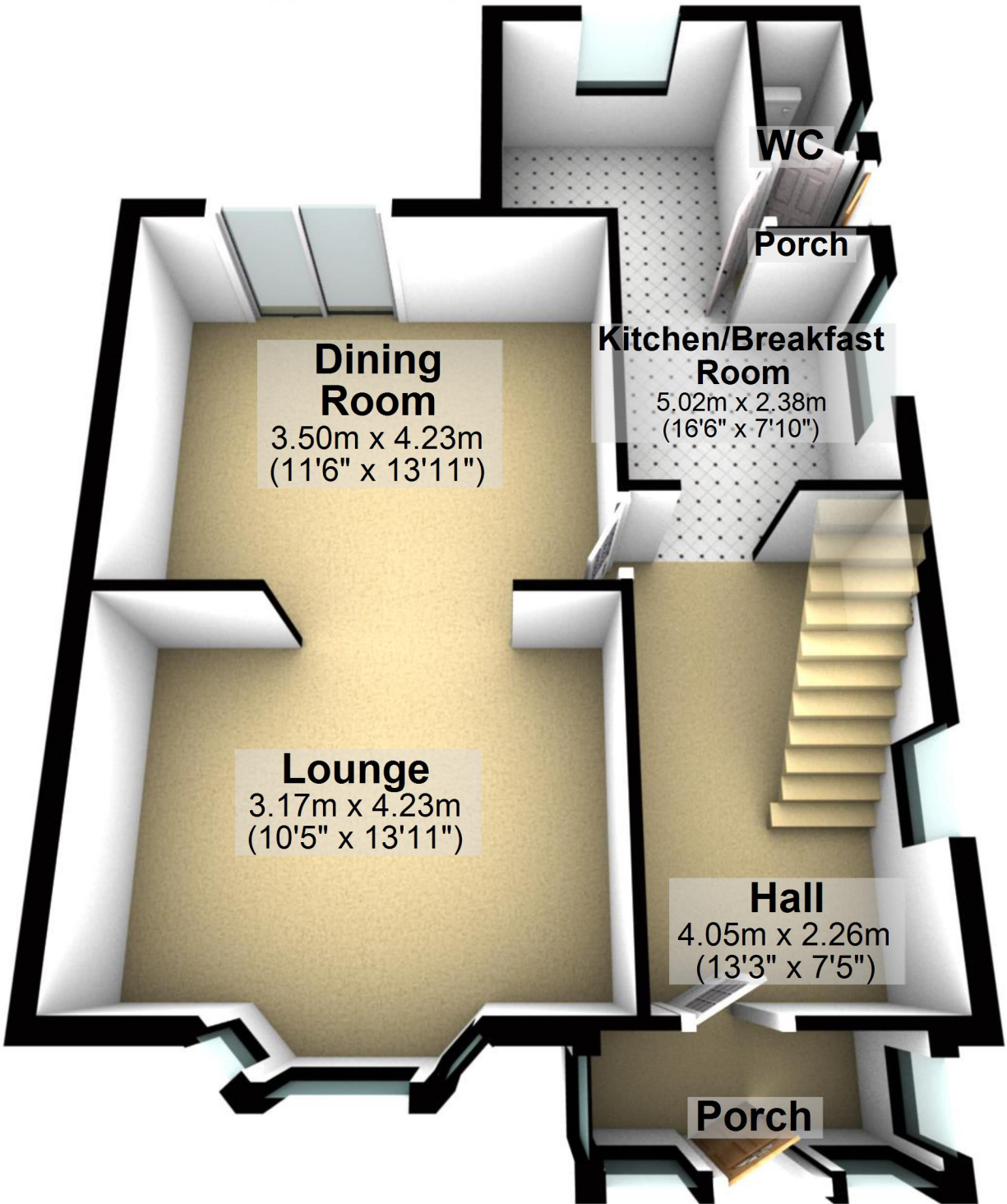

Total area: approx. 99.4 sq. metres (1069.4 sq. feet)

For illustrative purposes only. Not to scale. All sizes are approximate.

Plan produced using PlanUp.

# First Floor

Approx. 44.6 sq. metres (480.4 sq. feet)

