

# Ground Floor

Approx. 39.9 sq. metres (429.0 sq. feet)

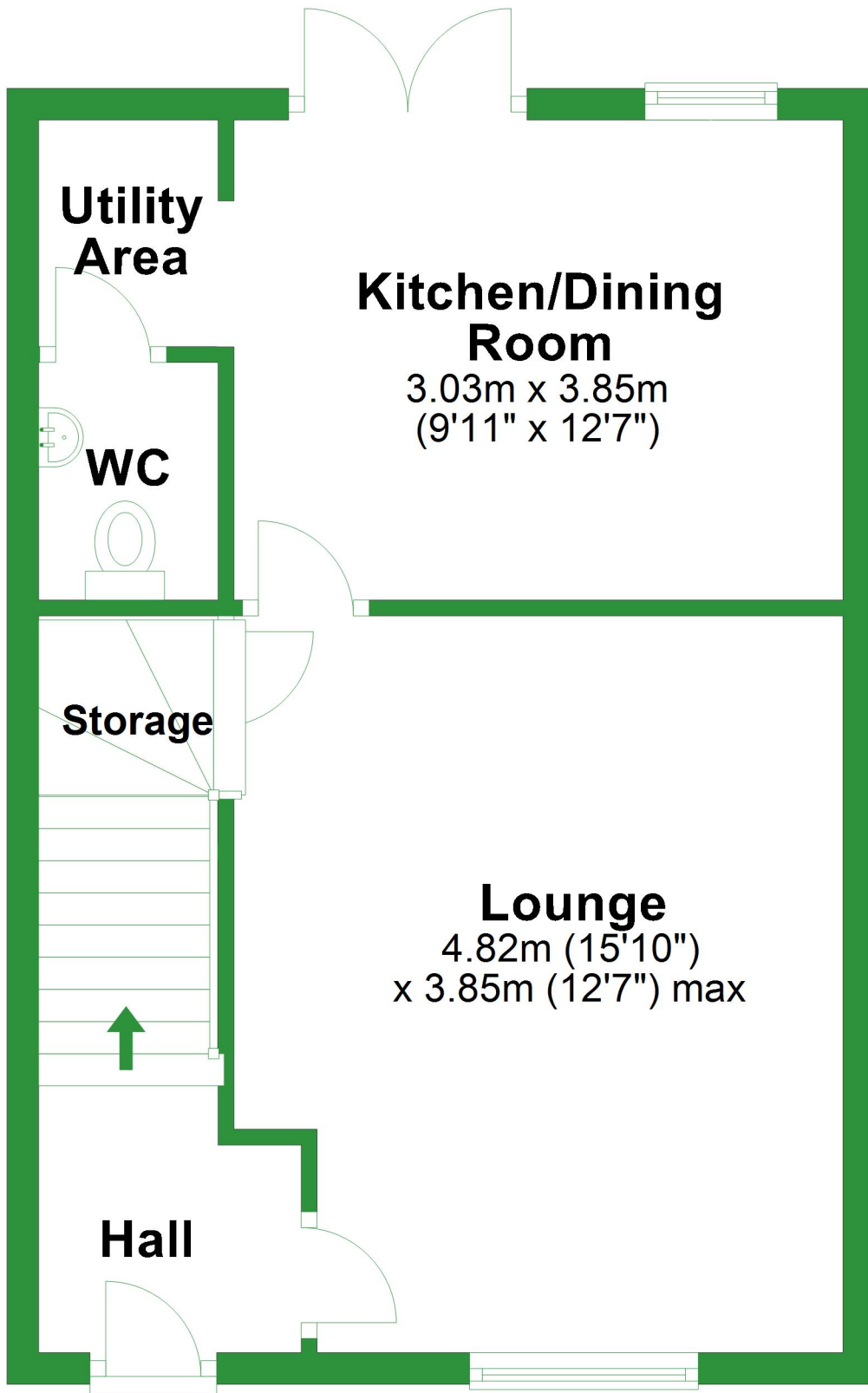

Total area: approx. 79.3 sq. metres (854.1 sq. feet)

For illustrative purposes only. Not to scale. All sizes are approximate.

Plan produced using PlanUp.

# First Floor

Approx. 39.5 sq. metres (425.1 sq. feet)

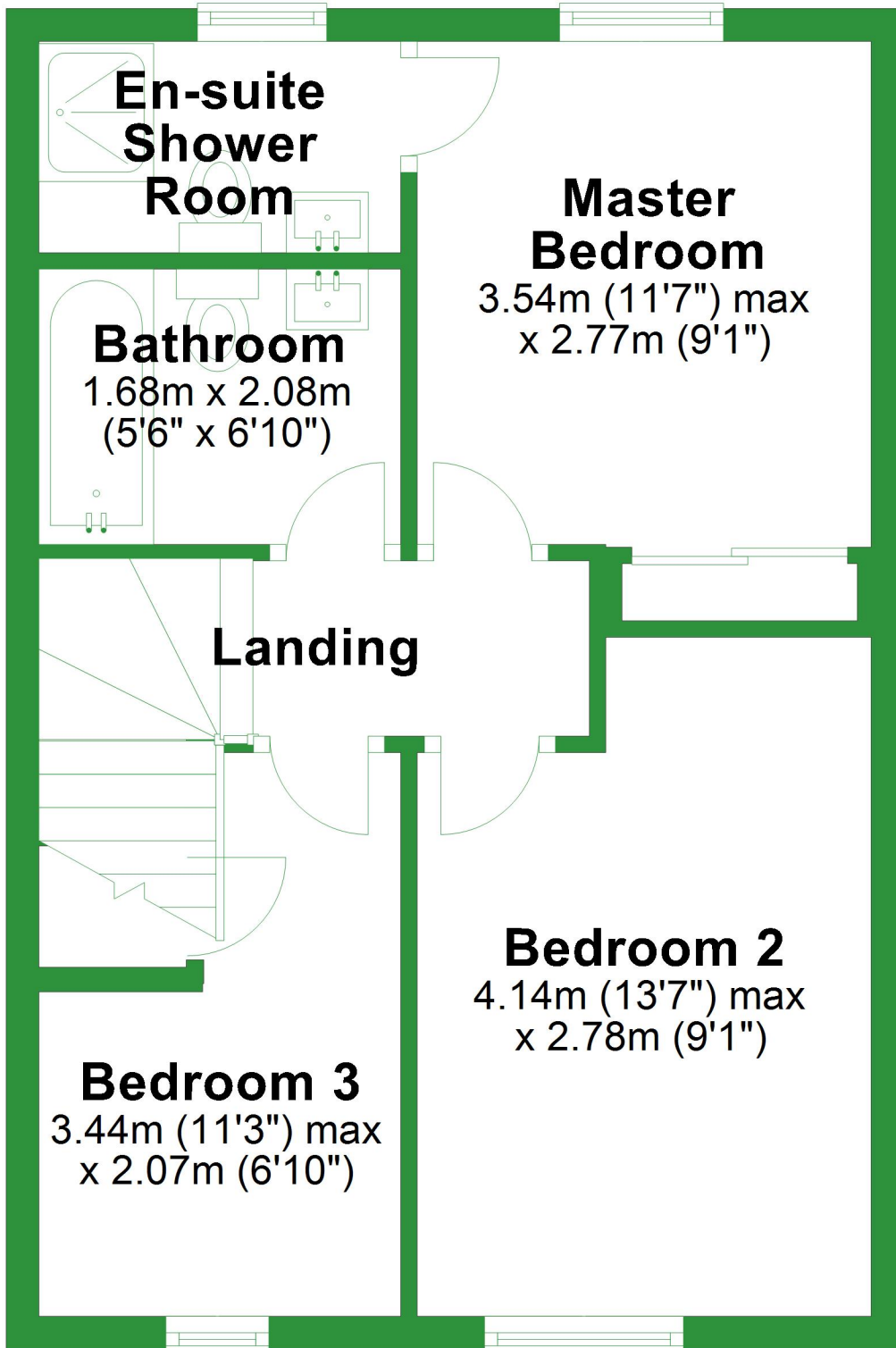

# Ground Floor

Approx. 39.9 sq. metres (429.0 sq. feet)

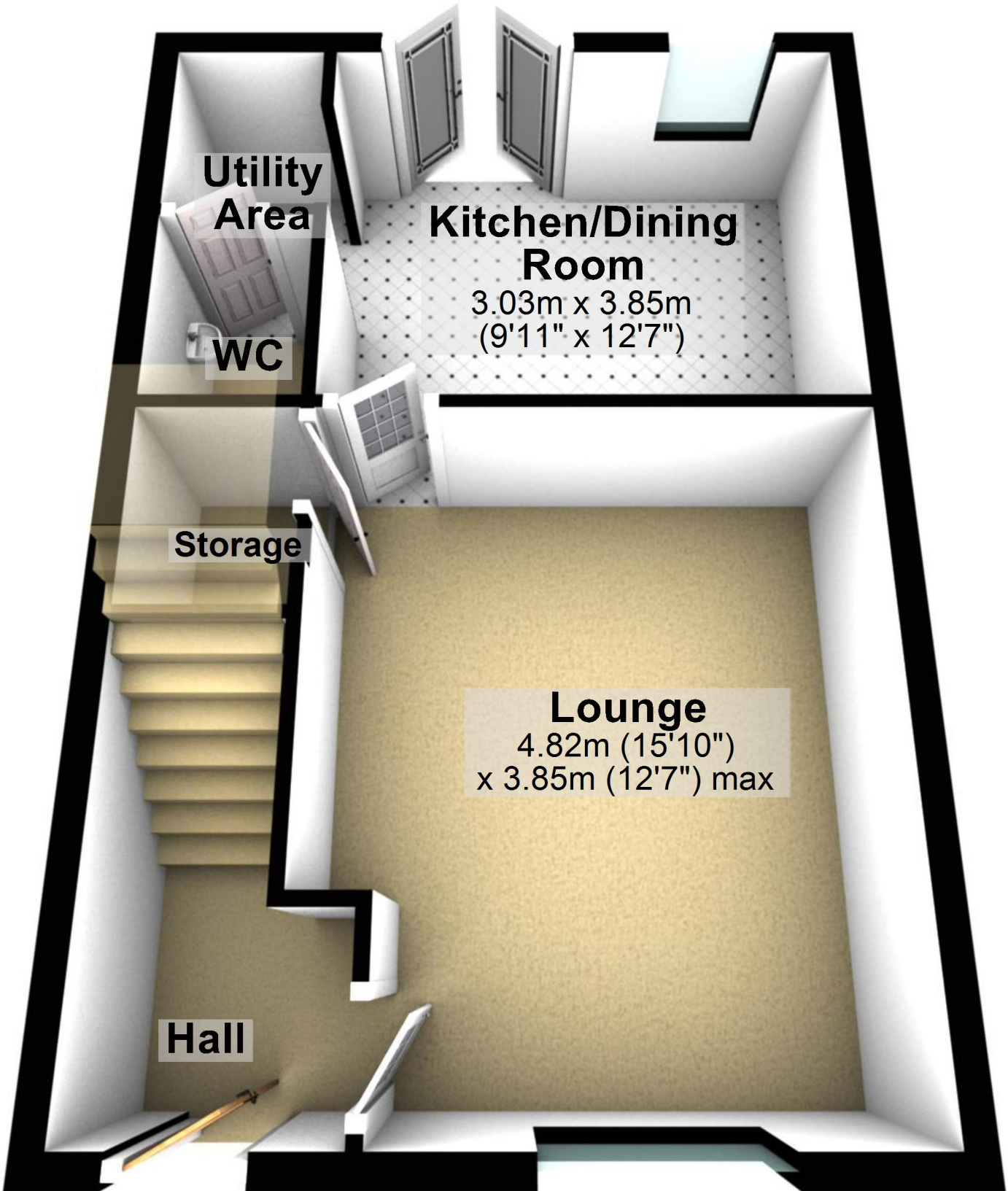

Total area: approx. 79.3 sq. metres (854.1 sq. feet)

For illustrative purposes only. Not to scale. All sizes are approximate.

Plan produced using PlanUp.

# First Floor

Approx. 39.5 sq. metres (425.1 sq. feet)

