

# Ground Floor

Approx. 54.8 sq. metres (589.6 sq. feet)

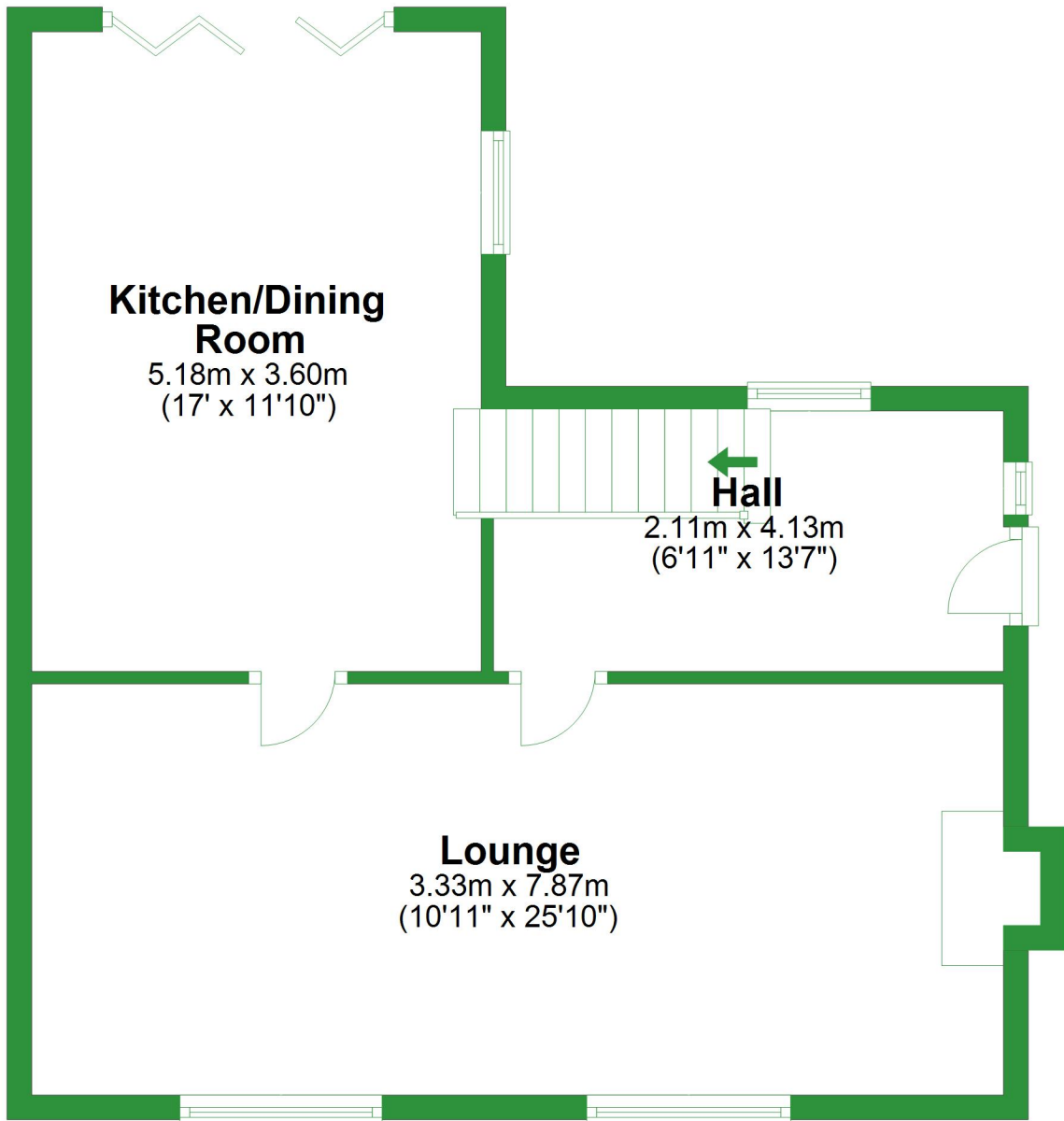

Total area: approx. 123.3 sq. metres (1327.6 sq. feet)

For illustrative purposes only. Not to scale. All sizes are approximate.

Plan produced using PlanUp.

# First Floor

Approx. 43.6 sq. metres (469.1 sq. feet)

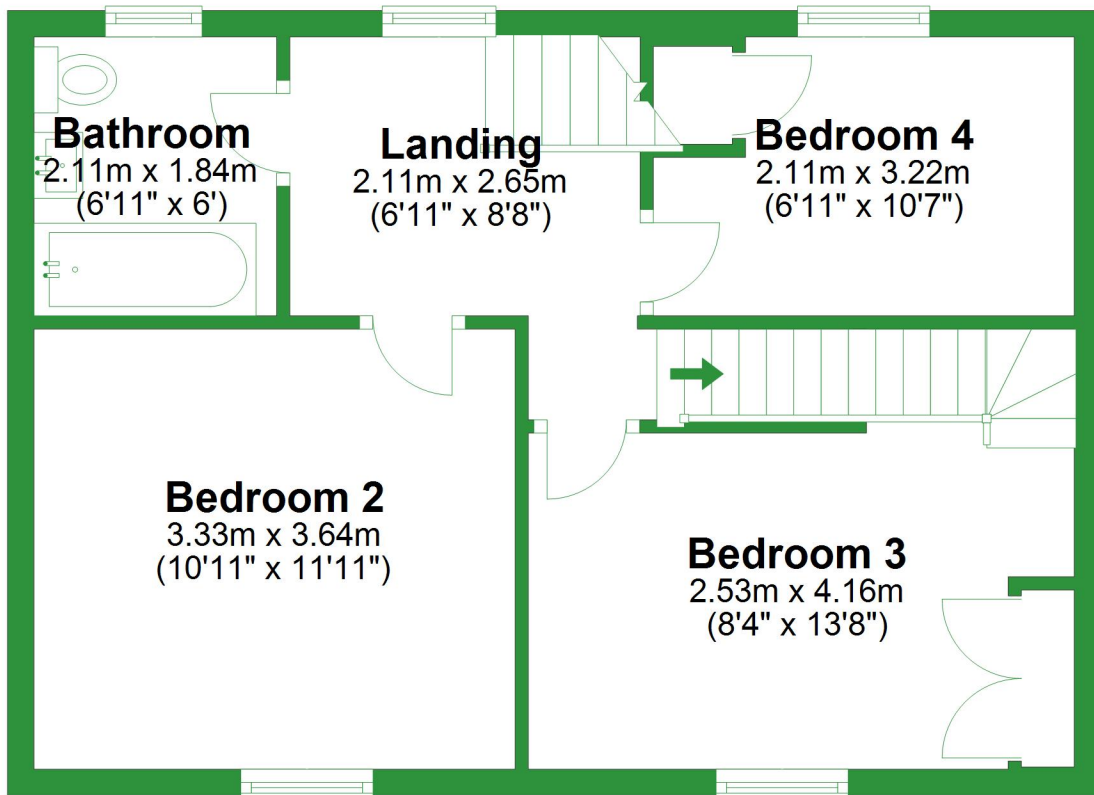

## Second Floor

Approx. 25.0 sq. metres (269.0 sq. feet)

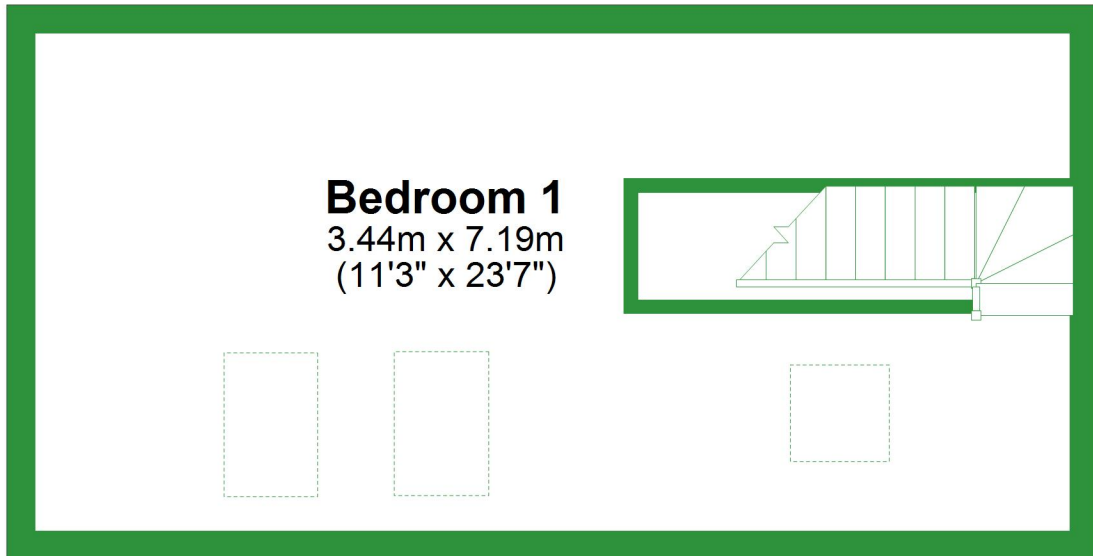

# Ground Floor

Approx. 54.8 sq. metres (589.6 sq. feet)

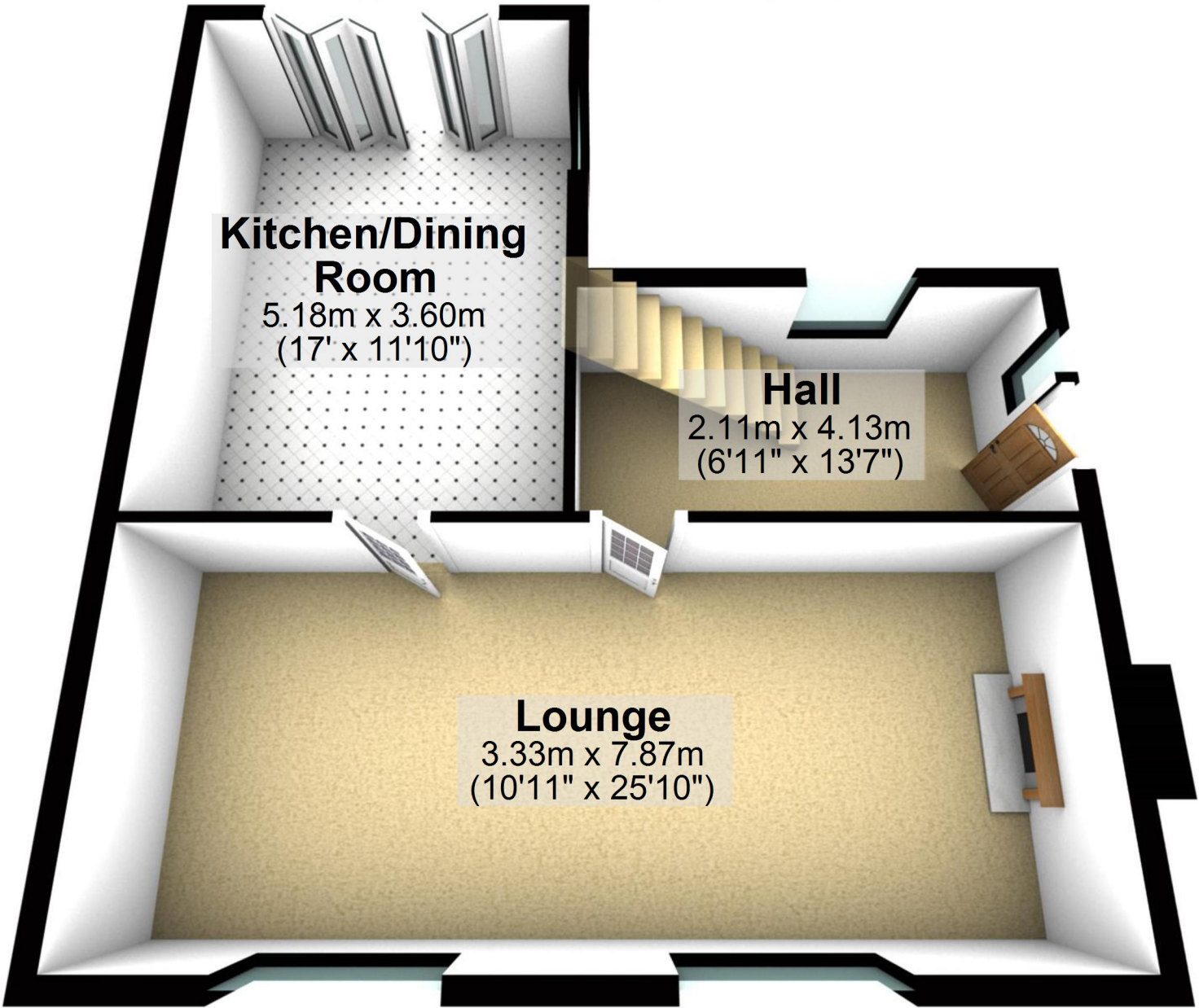

Total area: approx. 123.3 sq. metres (1327.6 sq. feet)

For illustrative purposes only. Not to scale. All sizes are approximate.

Plan produced using PlanUp.

# First Floor

Approx. 43.6 sq. metres (469.1 sq. feet)

## Bathroom

2.11m x 1.84m  
(6'11" x 6')

## Landing

2.11m x 2.65m  
(6'11" x 8'8")

## Bedroom 4

2.11m x 3.22m  
(6'11" x 10'7")

## Bedroom 2

3.33m x 3.64m  
(10'11" x 11'11")

## Bedroom 3

2.53m x 4.16m  
(8'4" x 13'8")

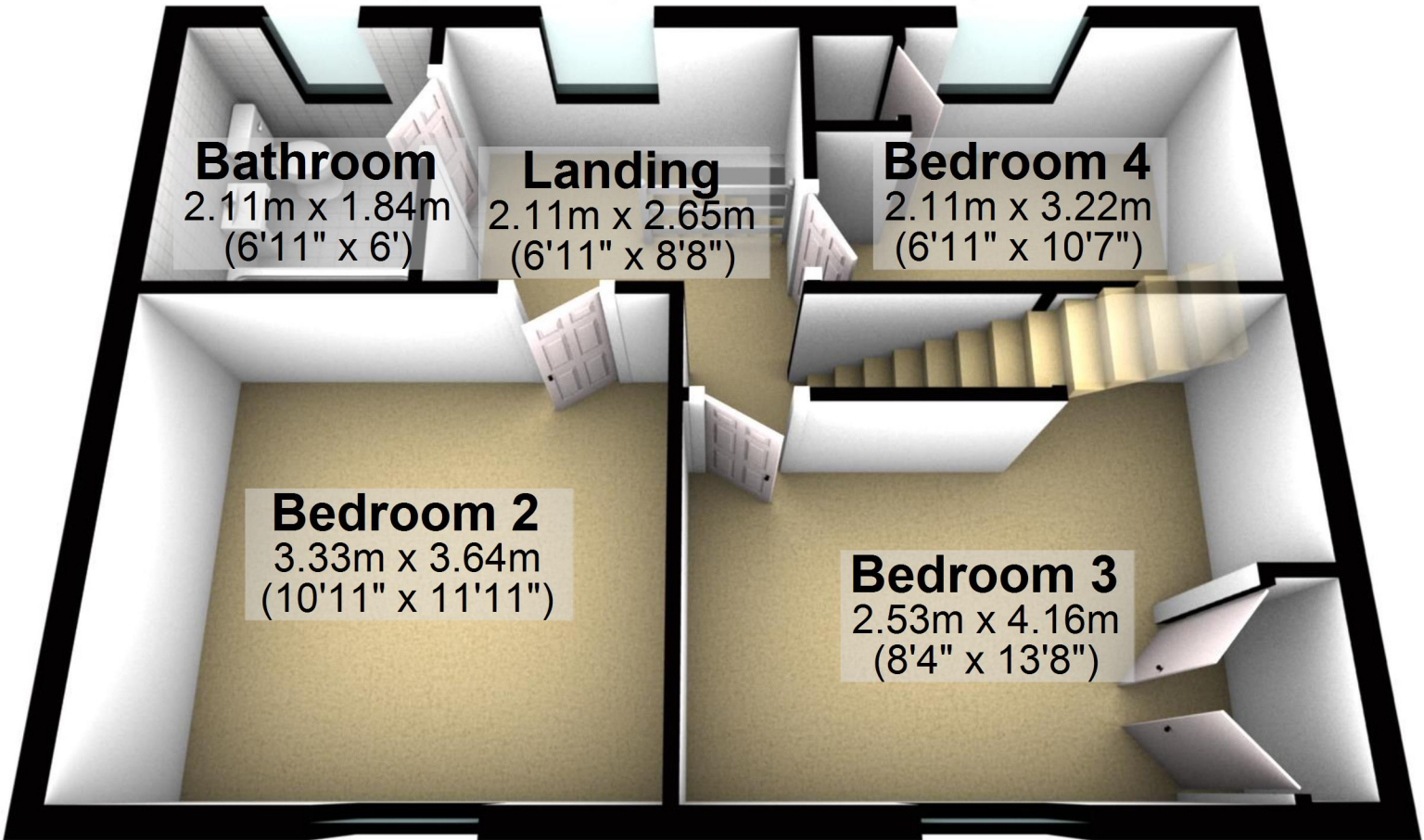

## Second Floor

Approx. 25.0 sq. metres (269.0 sq. feet)

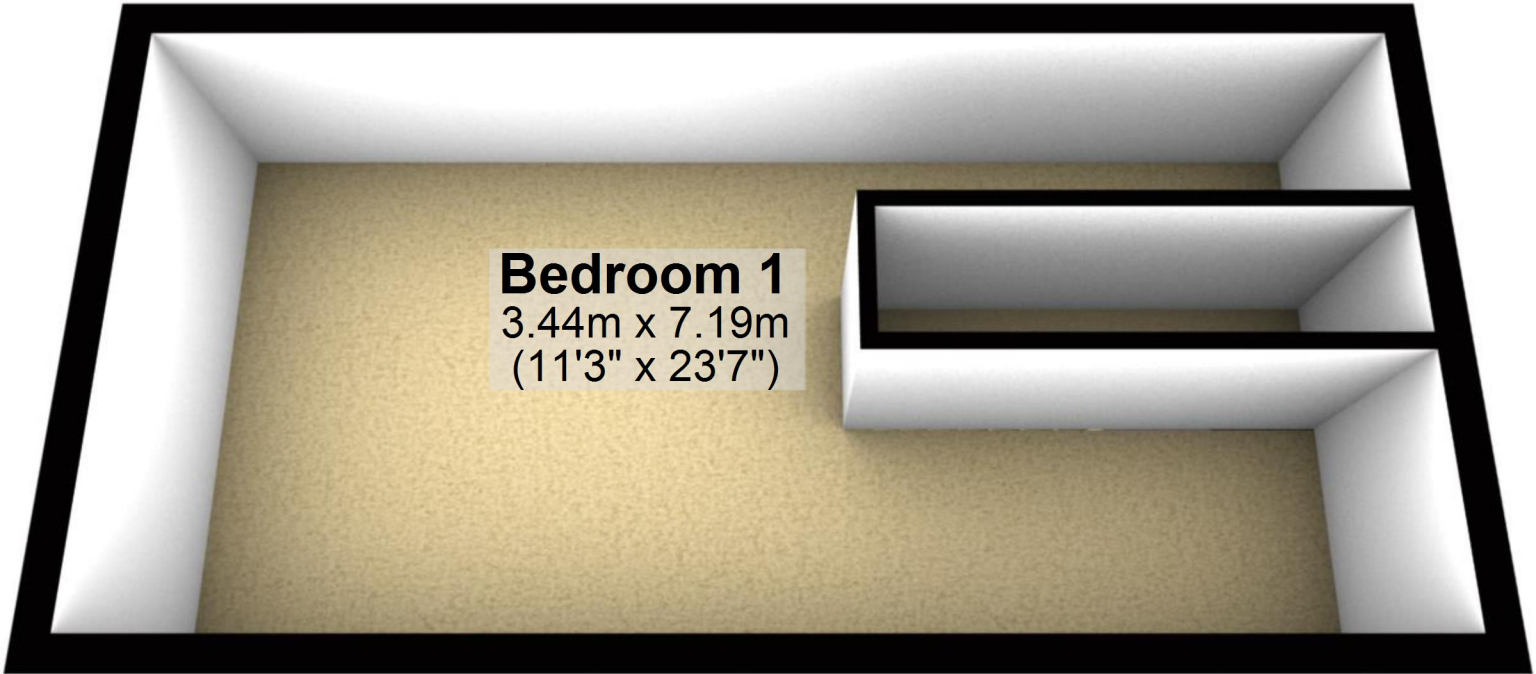

**Bedroom 1**  
3.44m x 7.19m  
(11'3" x 23'7")

A 3D perspective rendering of a bedroom. The room has a light brown carpet and white walls. A built-in white bench with a black top is positioned against the right wall. The room is enclosed by a thick black border, suggesting a cutaway view of a floor slab.