

# Ground Floor

Approx. 33.5 sq. metres (360.5 sq. feet)

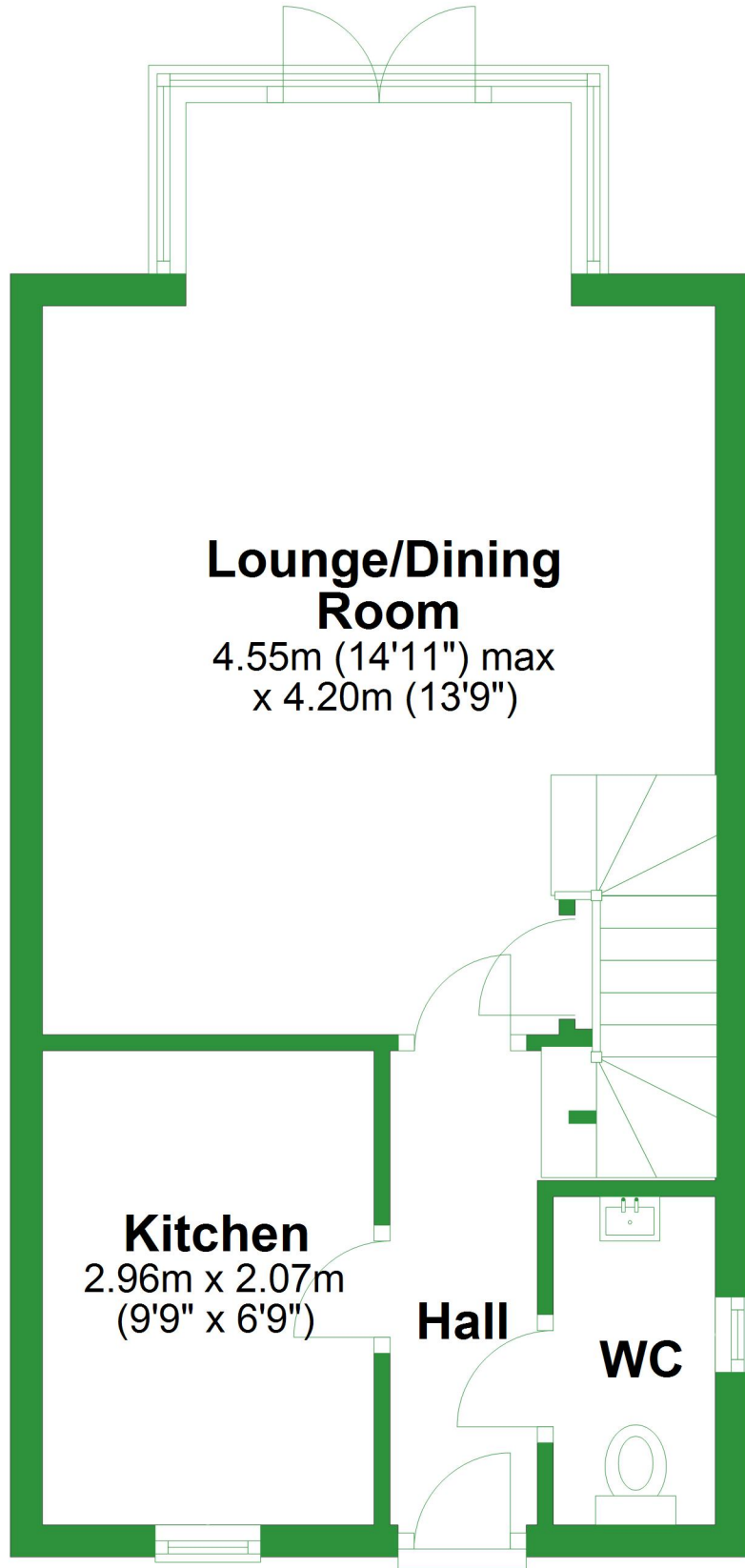

Total area: approx. 65.9 sq. metres (709.4 sq. feet)

For illustrative purposes only. Not to scale. All sizes are approximate.

Plan produced using PlanUp.

# First Floor

Approx. 32.4 sq. metres (348.9 sq. feet)

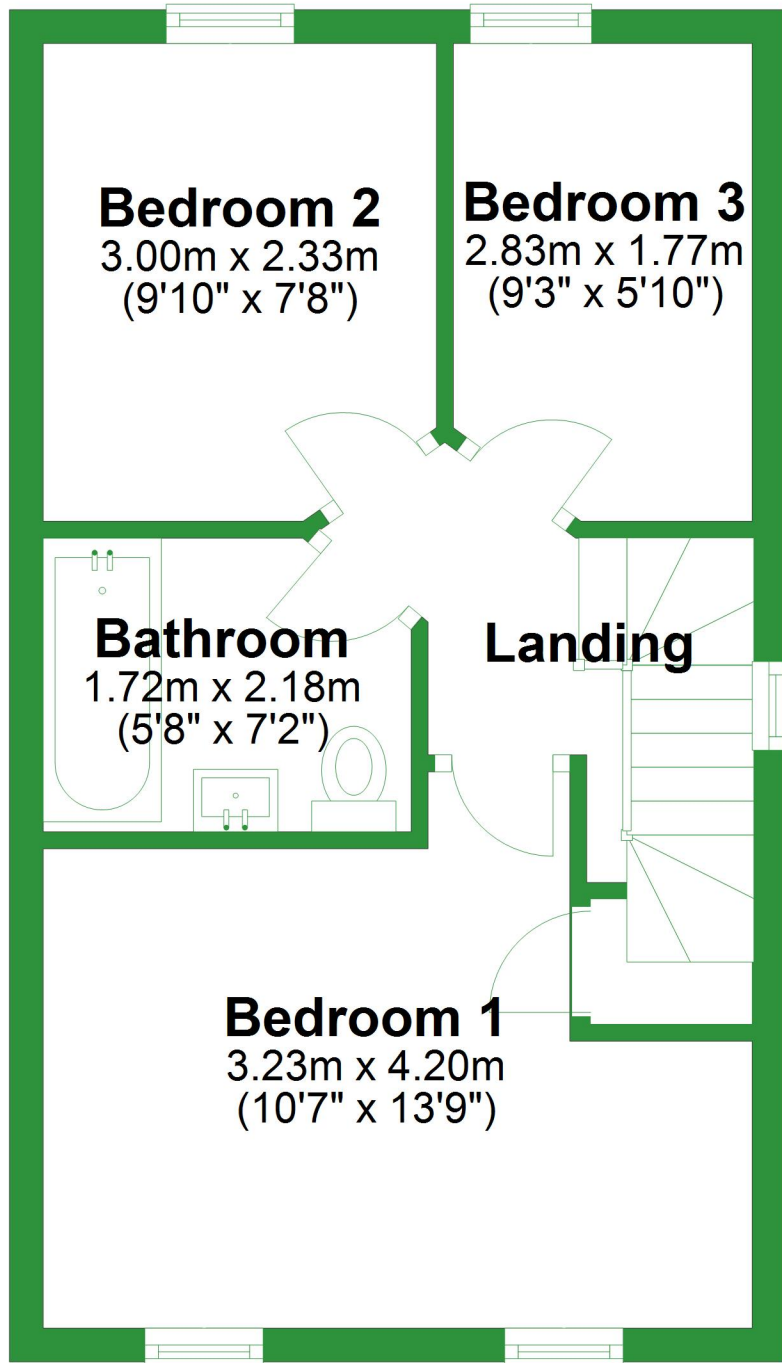

# Ground Floor

Approx. 33.5 sq. metres (360.5 sq. feet)

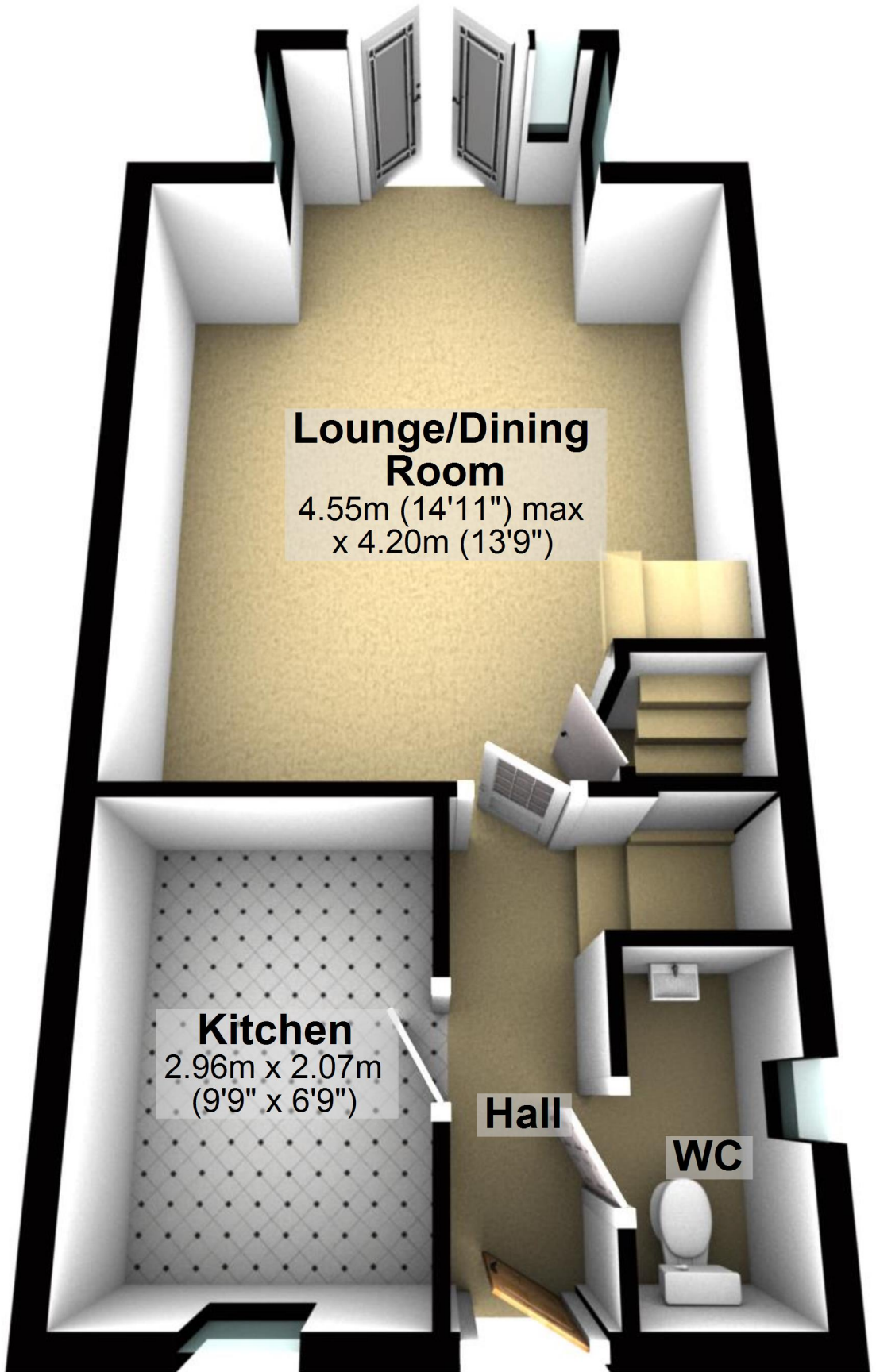

Total area: approx. 65.9 sq. metres (709.4 sq. feet)

For illustrative purposes only. Not to scale. All sizes are approximate.

Plan produced using PlanUp.

# First Floor

Approx. 32.4 sq. metres (348.9 sq. feet)

## Bedroom 2 Bedroom 3

3.00m x 2.33m 2.83m x 1.77m  
(9'10" x 7'8") (9'3" x 5'10")

## Bathroom

1.72m x 2.18m  
(5'8" x 7'2")

## Landing

## Bedroom 1

3.23m x 4.20m  
(10'7" x 13'9")

