

# Ground Floor

Approx. 69.7 sq. metres (749.7 sq. feet)

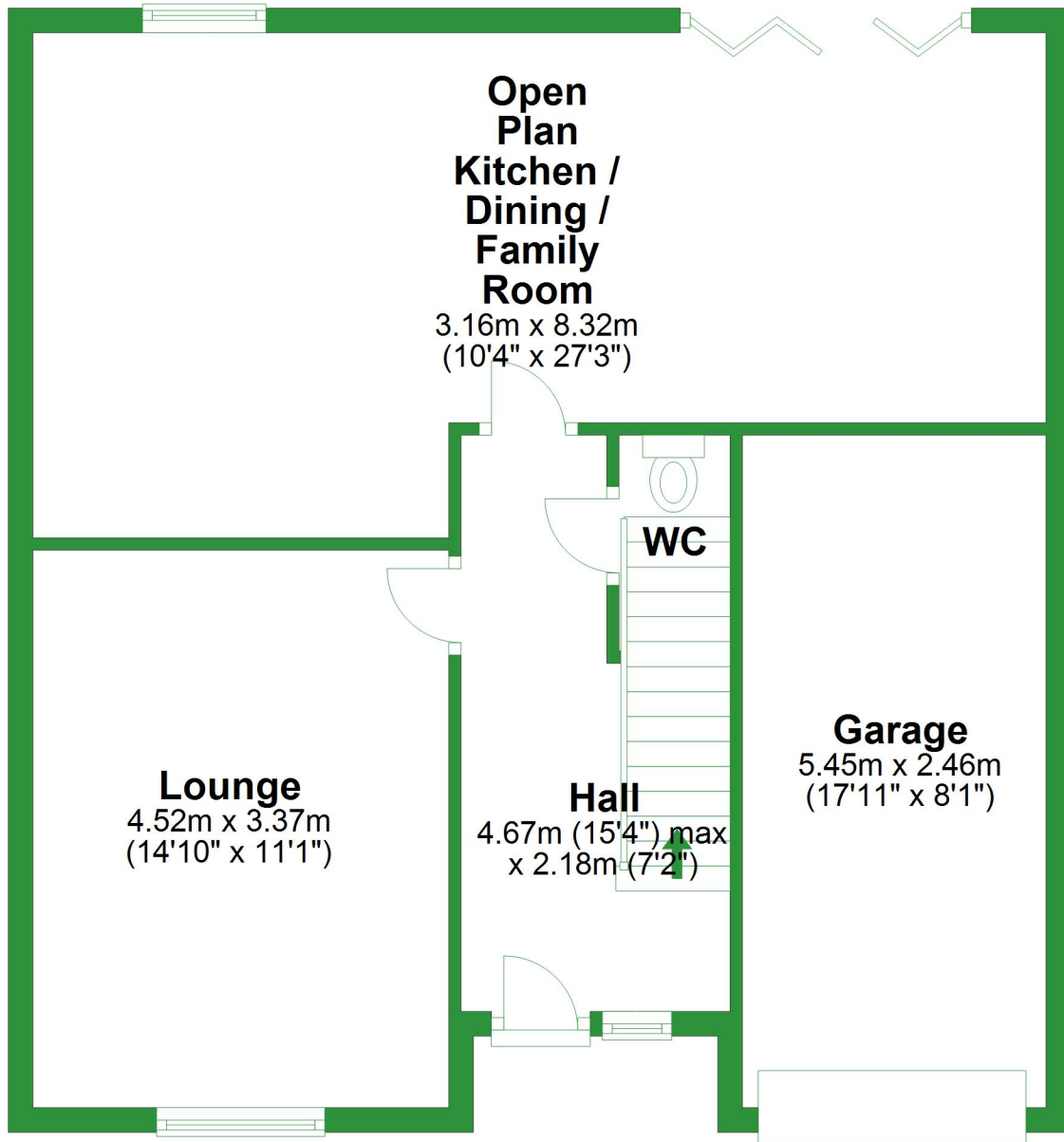

Total area: approx. 136.8 sq. metres (1472.9 sq. feet)

For illustrative purposes only. Not to scale. All sizes are approximate.

Plan produced using PlanUp.

# First Floor

Approx. 67.2 sq. metres (723.2 sq. feet)

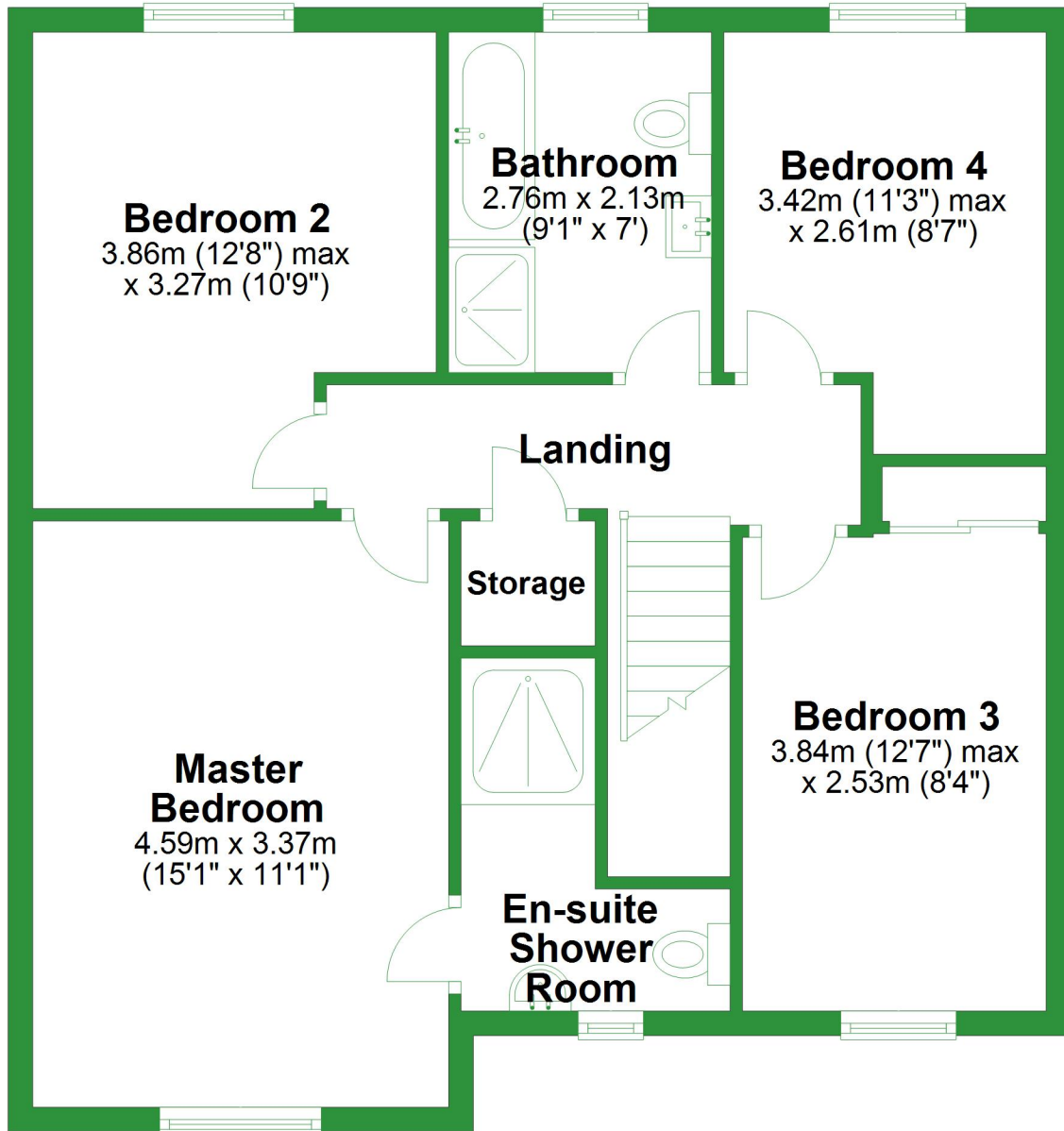

# Ground Floor

Approx. 69.7 sq. metres (749.7 sq. feet)

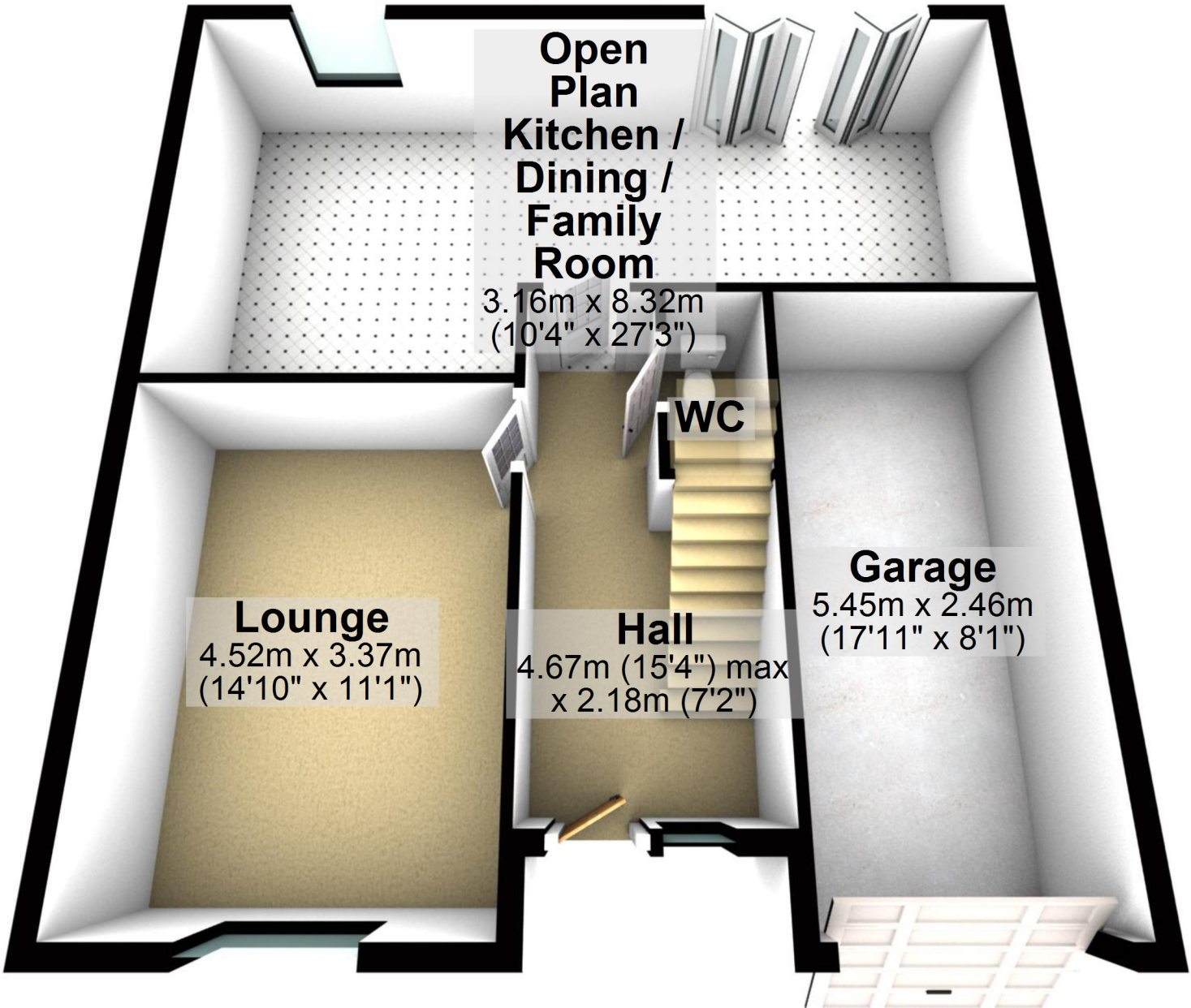

Total area: approx. 136.8 sq. metres (1472.9 sq. feet)

For illustrative purposes only. Not to scale. All sizes are approximate.

Plan produced using PlanUp.

# First Floor

Approx. 67.2 sq. metres (723.2 sq. feet)

**Bedroom 2**  
3.86m (12'8") max  
x 3.27m (10'9")

**Bathroom**  
2.76m x 2.13m  
(9'1" x 7')

**Bedroom 4**  
3.42m (11'3") max  
x 2.61m (8'7")

**Landing**

**Storage**

**Master  
Bedroom**  
4.59m x 3.37m  
(15'1" x 11'1")

**Bedroom 3**  
3.84m (12'7") max  
x 2.53m (8'4")

**En-suite  
Shower  
Room**

