

# First Floor

Approx. 36.4 sq. metres (391.8 sq. feet)



Total area: approx. 36.4 sq. metres (391.8 sq. feet)

For illustrative purposes only. Not to scale. All sizes are approximate.  
Plan produced using PlanUp.

# First Floor

Approx. 36.4 sq. metres (391.8 sq. feet)

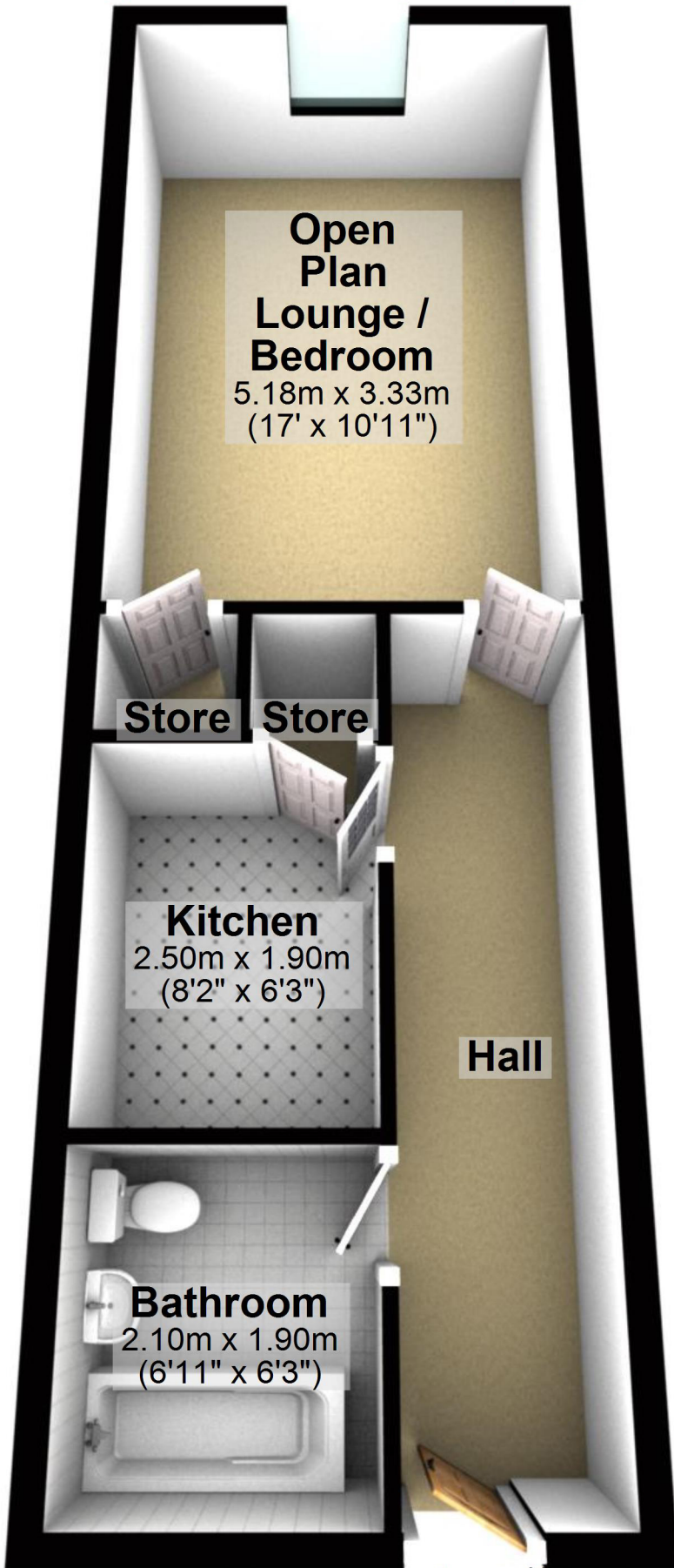

**Open Plan  
Lounge /  
Bedroom**  
5.18m x 3.33m  
(17' x 10'11")

**Store Store**

**Kitchen**  
2.50m x 1.90m  
(8'2" x 6'3")

**Hall**

**Bathroom**  
2.10m x 1.90m  
(6'11" x 6'3")

Total area: approx. 36.4 sq. metres (391.8 sq. feet)

For illustrative purposes only. Not to scale. All sizes are approximate.

Plan produced using PlanUp.