

# Ground Floor

Approx. 46.3 sq. metres (498.7 sq. feet)

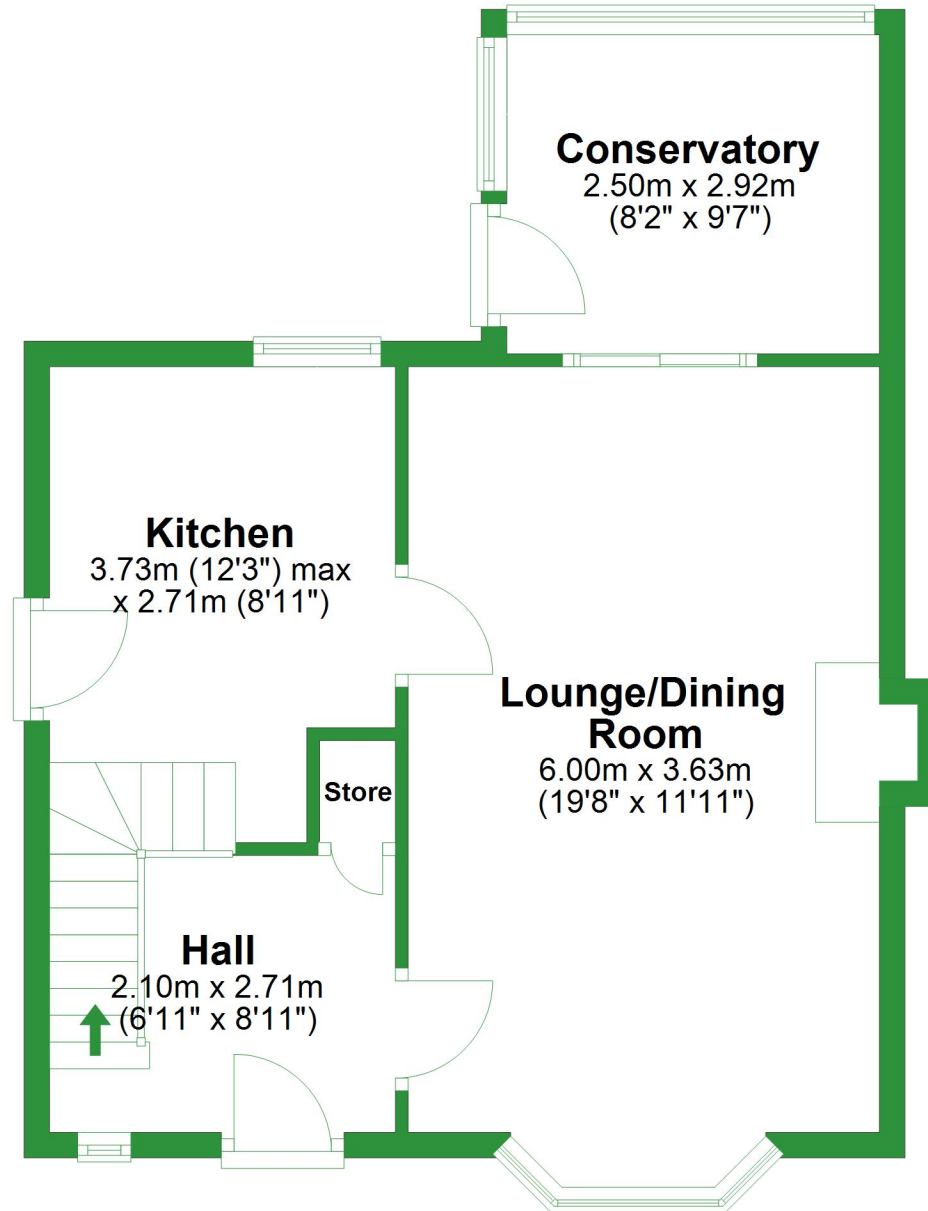

Total area: approx. 85.3 sq. metres (918.7 sq. feet)

For illustrative purposes only. Not to scale. All sizes are approximate.  
Plan produced using PlanUp.

## First Floor

Approx. 39.0 sq. metres (420.0 sq. feet)

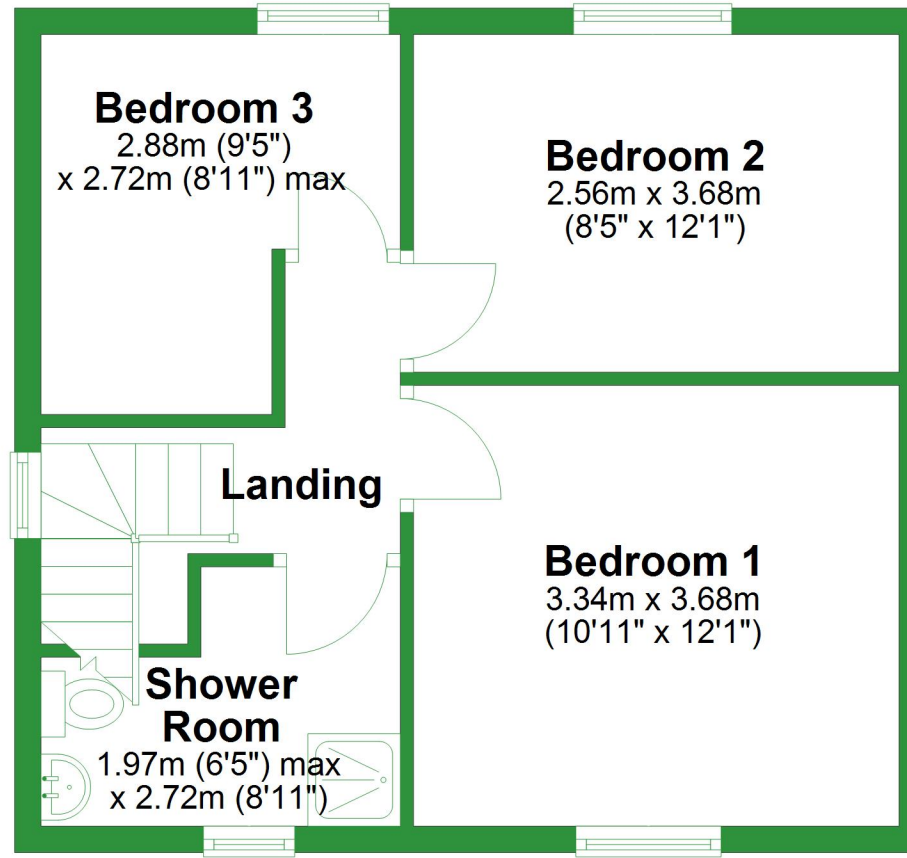

# Ground Floor

Approx. 46.3 sq. metres (498.7 sq. feet)

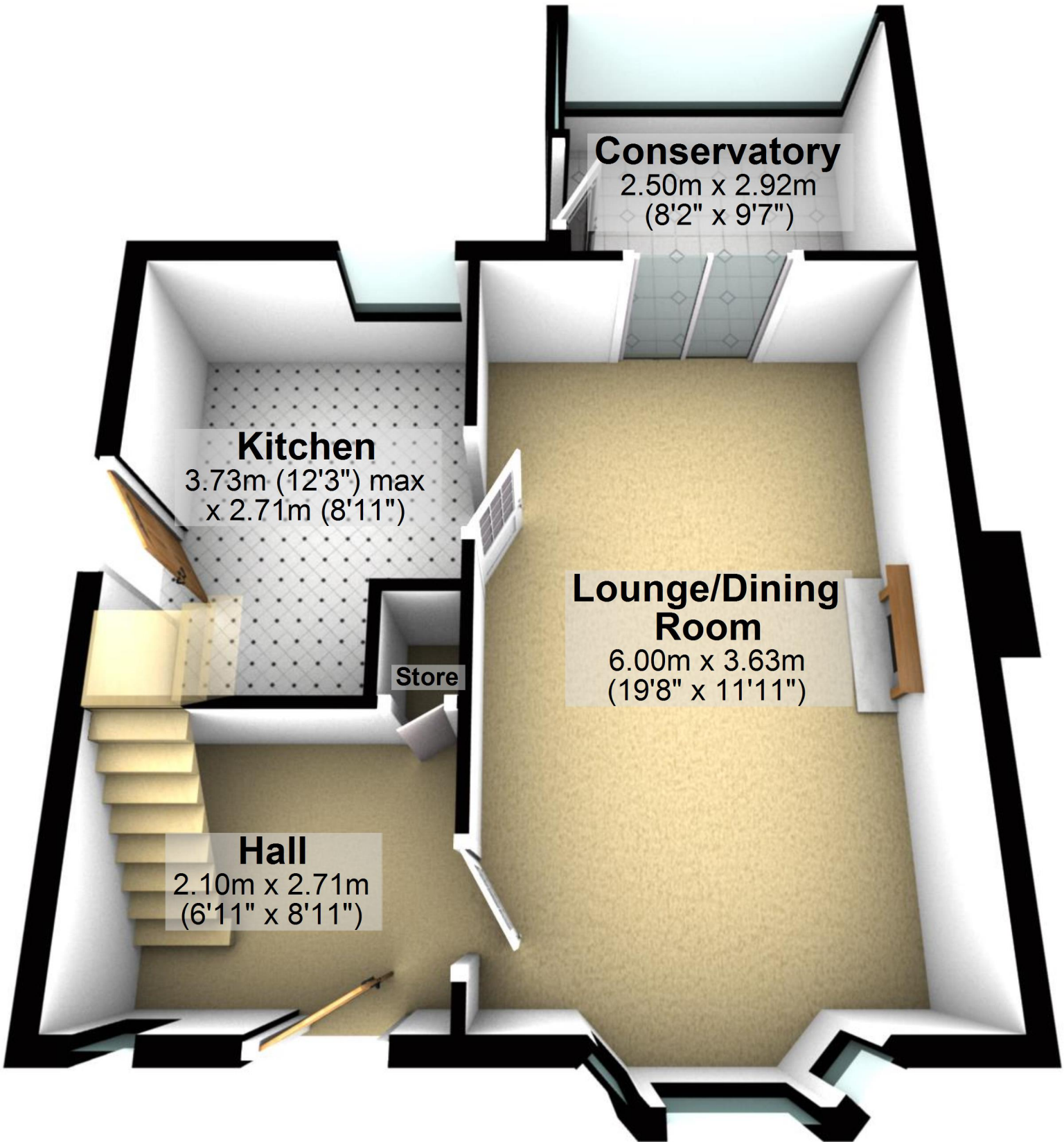

Total area: approx. 85.3 sq. metres (918.7 sq. feet)

For illustrative purposes only. Not to scale. All sizes are approximate.

Plan produced using PlanUp.

# First Floor

Approx. 39.0 sq. metres (420.0 sq. feet)

## Bedroom 3

2.88m (9'5")  
x 2.72m (8'11") max

## Bedroom 2

2.56m x 3.68m  
(8'5" x 12'1")

## Landing

## Bedroom 1

3.34m x 3.68m  
(10'11" x 12'1")

## Shower Room

1.97m (6'5") max  
x 2.72m (8'11")

