

Basement

Approx. 23.3 sq. metres (251.1 sq. feet)

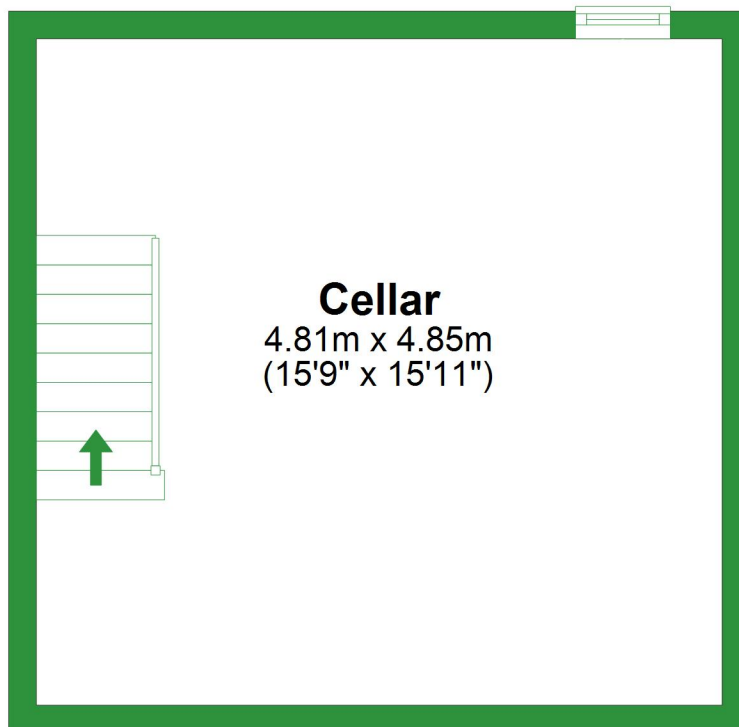

Total area: approx. 128.9 sq. metres (1388.0 sq. feet)

For illustrative purposes only. Not to scale. All sizes are approximate.
Plan produced using PlanUp.

Ground Floor

Approx. 54.5 sq. metres (586.9 sq. feet)

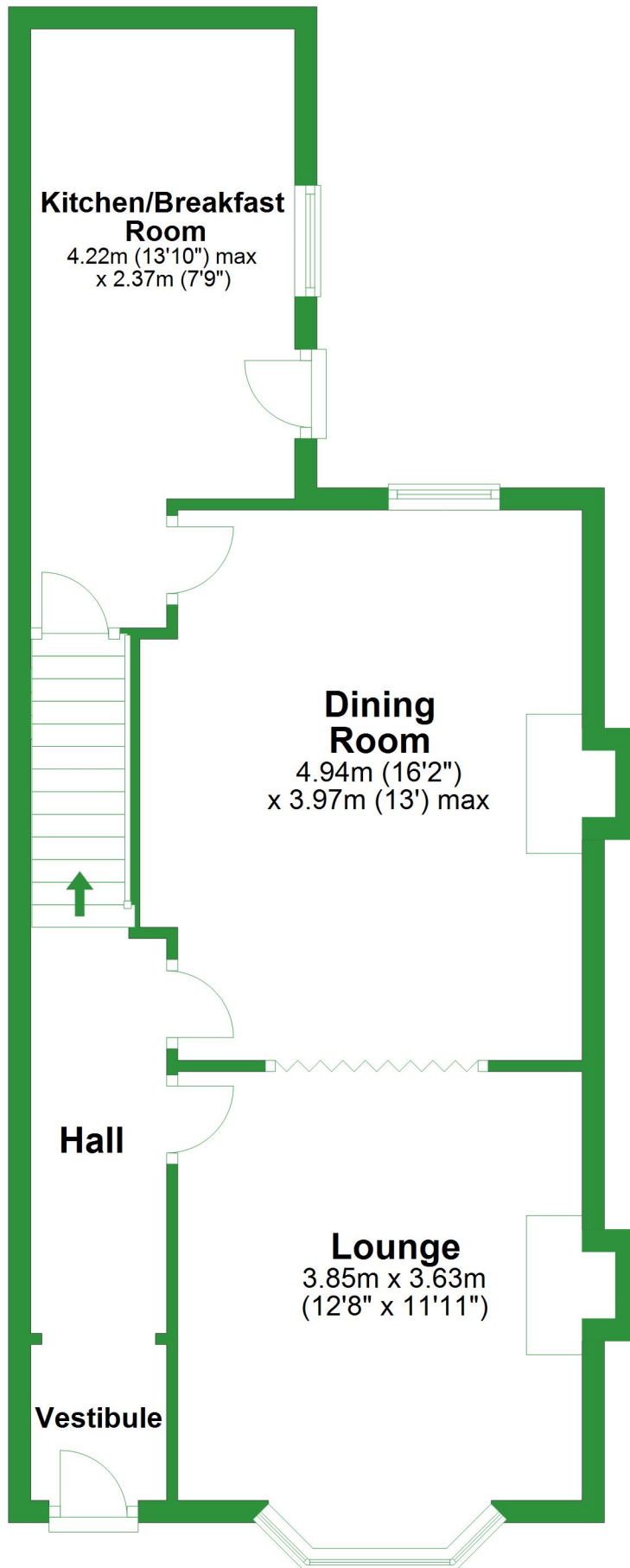

First Floor

Approx. 51.1 sq. metres (549.9 sq. feet)

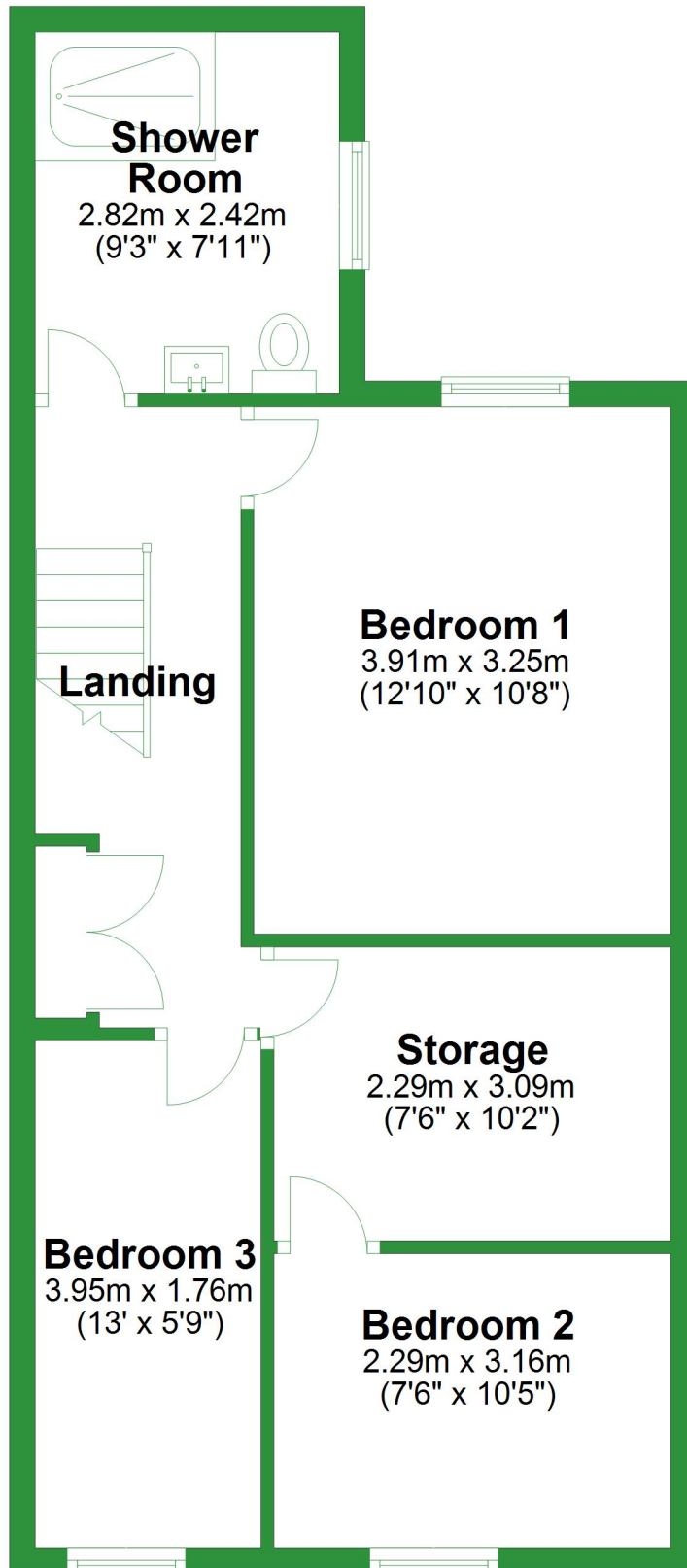

Basement

Approx. 23.3 sq. metres (251.1 sq. feet)

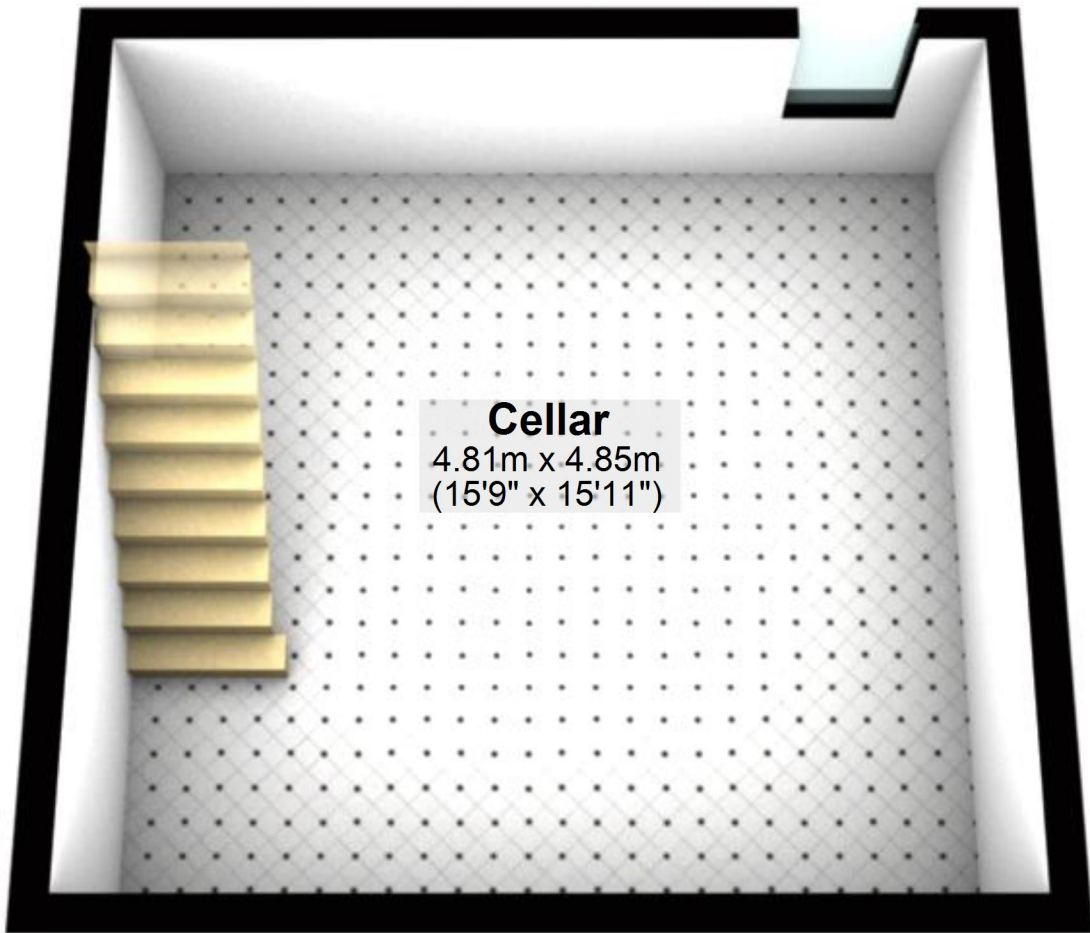

Total area: approx. 128.9 sq. metres (1388.0 sq. feet)

For illustrative purposes only. Not to scale. All sizes are approximate.

Plan produced using PlanUp.

Ground Floor

Approx. 54.5 sq. metres (586.9 sq. feet)

Kitchen/Breakfast Room

4.22m (13'10") max
x 2.37m (7'9")

Dining Room

4.94m (16'2")
x 3.97m (13') max

Hall

Lounge

3.85m x 3.63m
(12'8" x 11'11")

Vestibule

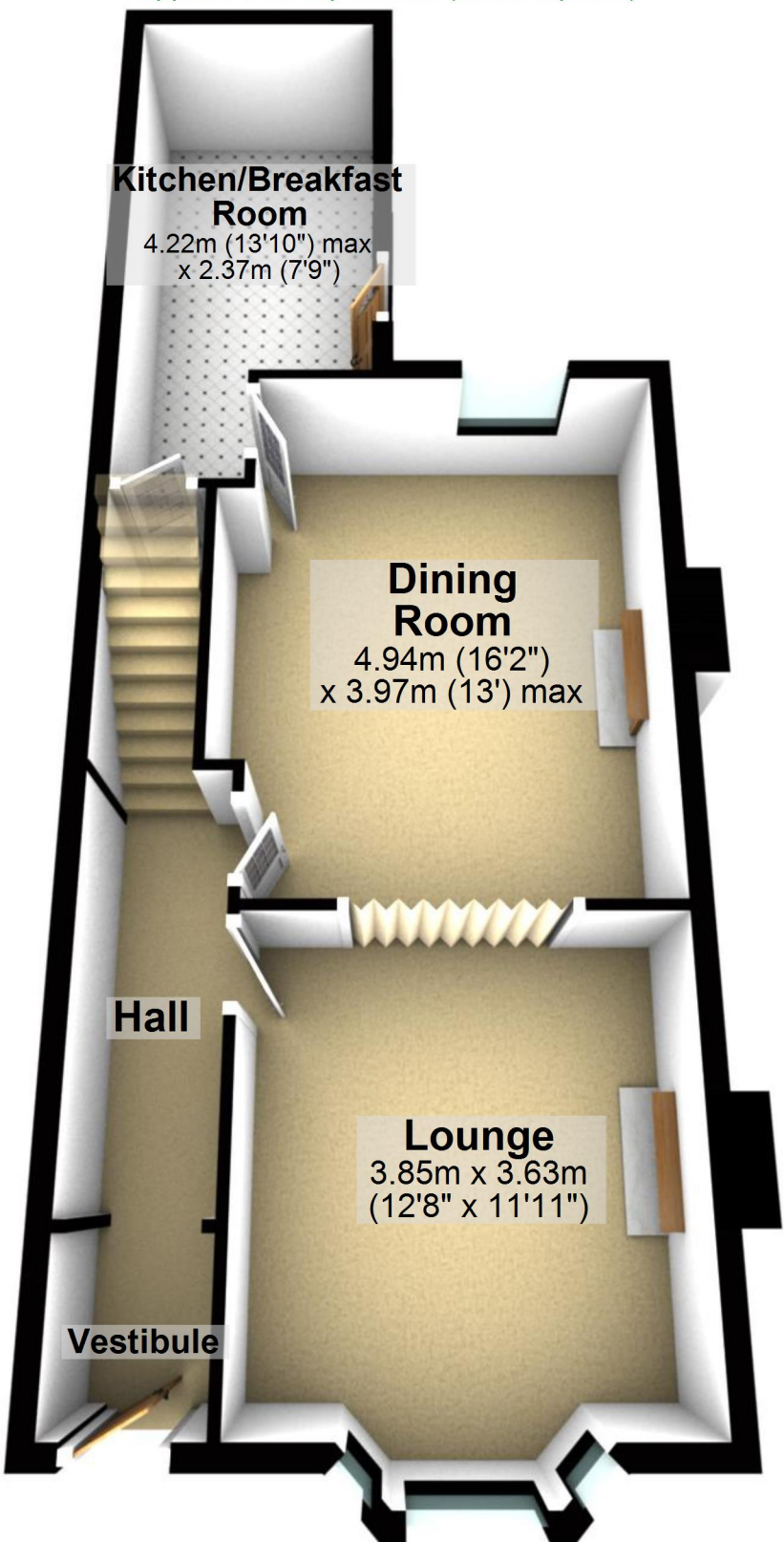

First Floor

Approx. 51.1 sq. metres (549.9 sq. feet)

