

Ground Floor

Approx. 112.5 sq. metres (1211.4 sq. feet)

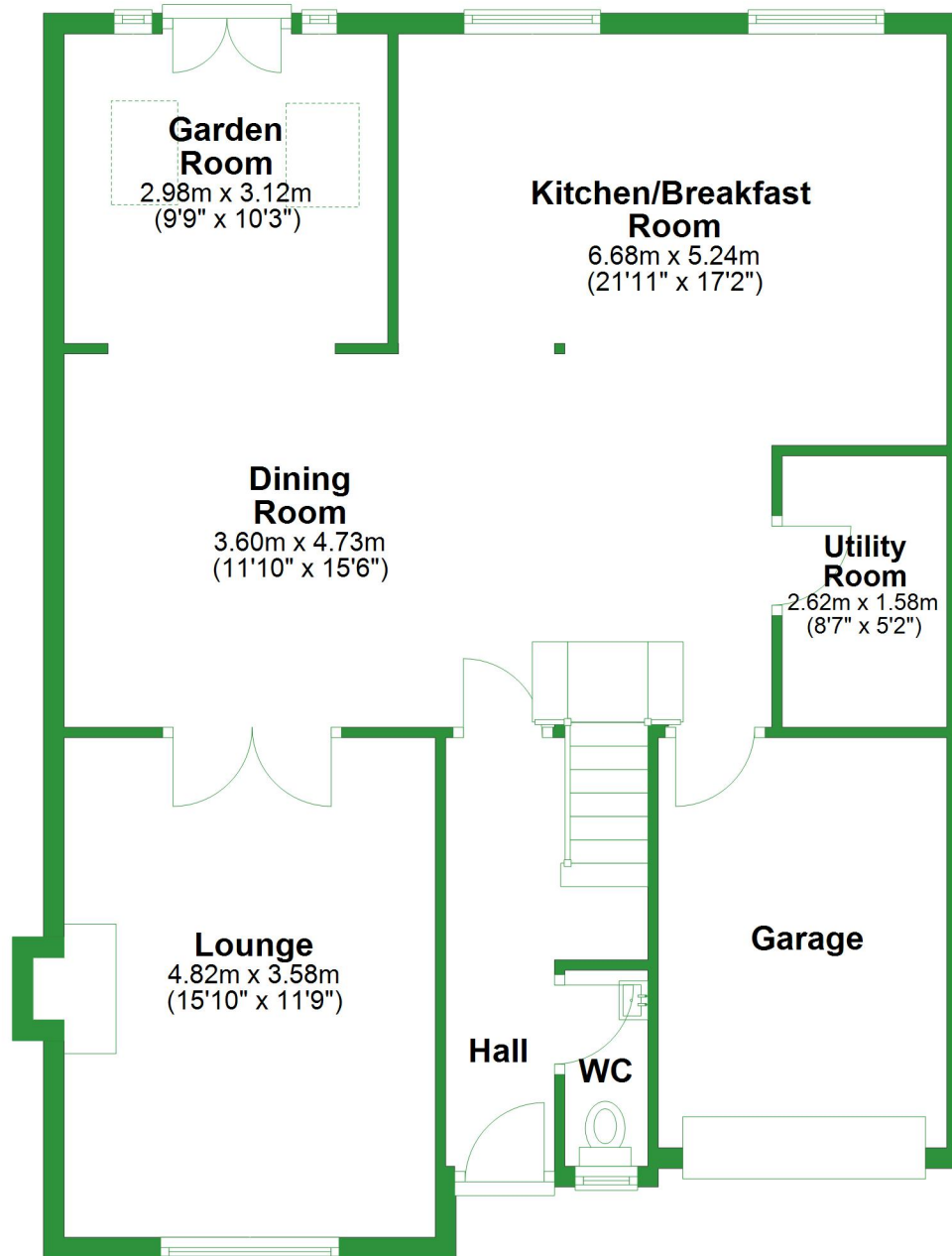

Total area: approx. 193.2 sq. metres (2080.1 sq. feet)

For illustrative purposes only. Not to scale. All sizes are approximate.
Plan produced using PlanUp.

First Floor

Approx. 80.7 sq. metres (868.7 sq. feet)

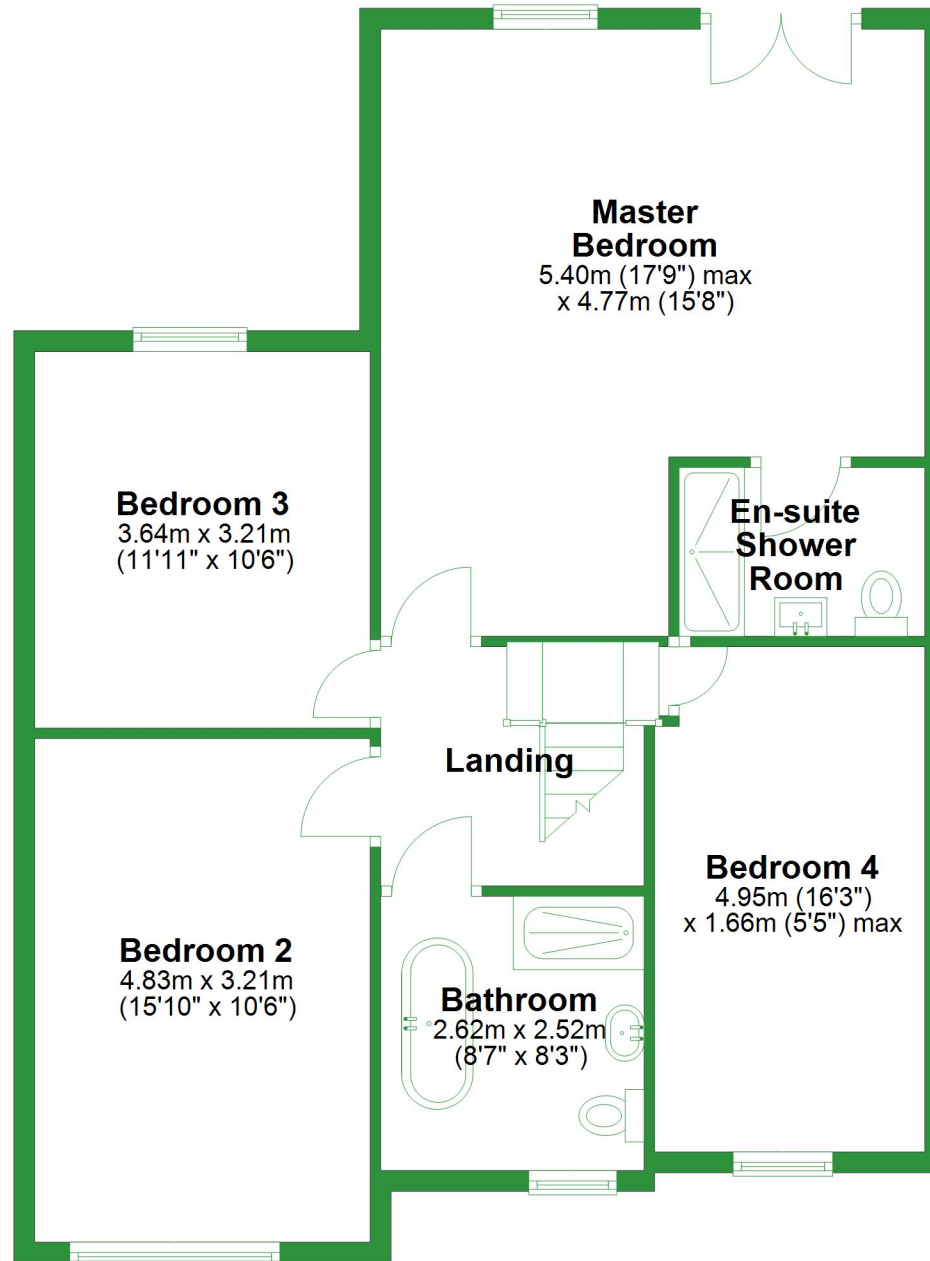

Master Bedroom
5.40m (17'9") max
x 4.77m (15'8")

Bedroom 3
3.64m x 3.21m
(11'11" x 10'6")

En-suite Shower Room

Landing

Bedroom 2
4.83m x 3.21m
(15'10" x 10'6")

Bathroom
2.62m x 2.52m
(8'7" x 8'3")

Bedroom 4
4.95m (16'3")
x 1.66m (5'5") max

Ground Floor

Approx. 112.5 sq. metres (1211.4 sq. feet)

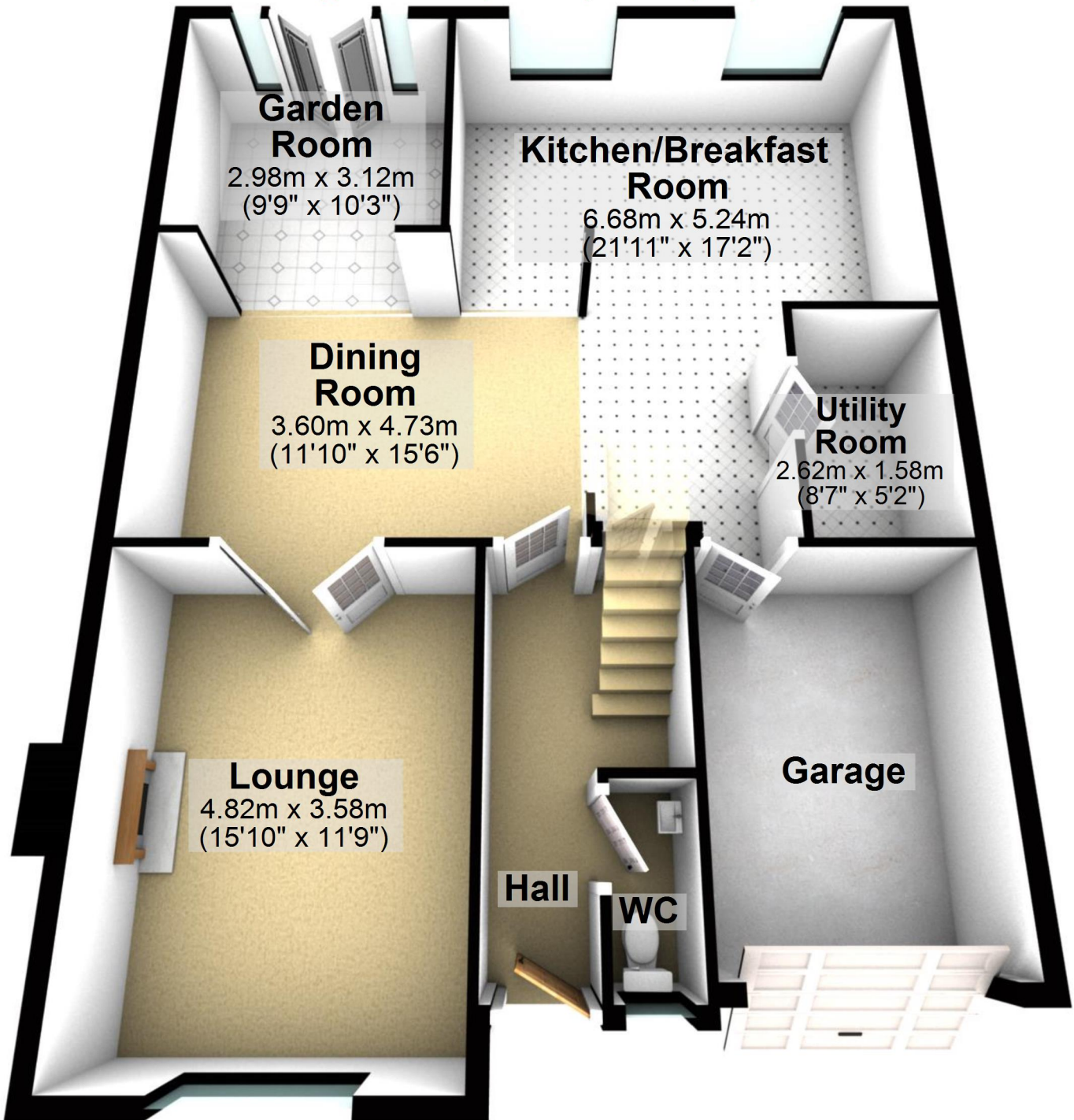

Total area: approx. 193.2 sq. metres (2080.1 sq. feet)

For illustrative purposes only. Not to scale. All sizes are approximate.
Plan produced using PlanUp.

First Floor

Approx. 80.7 sq. metres (868.7 sq. feet)

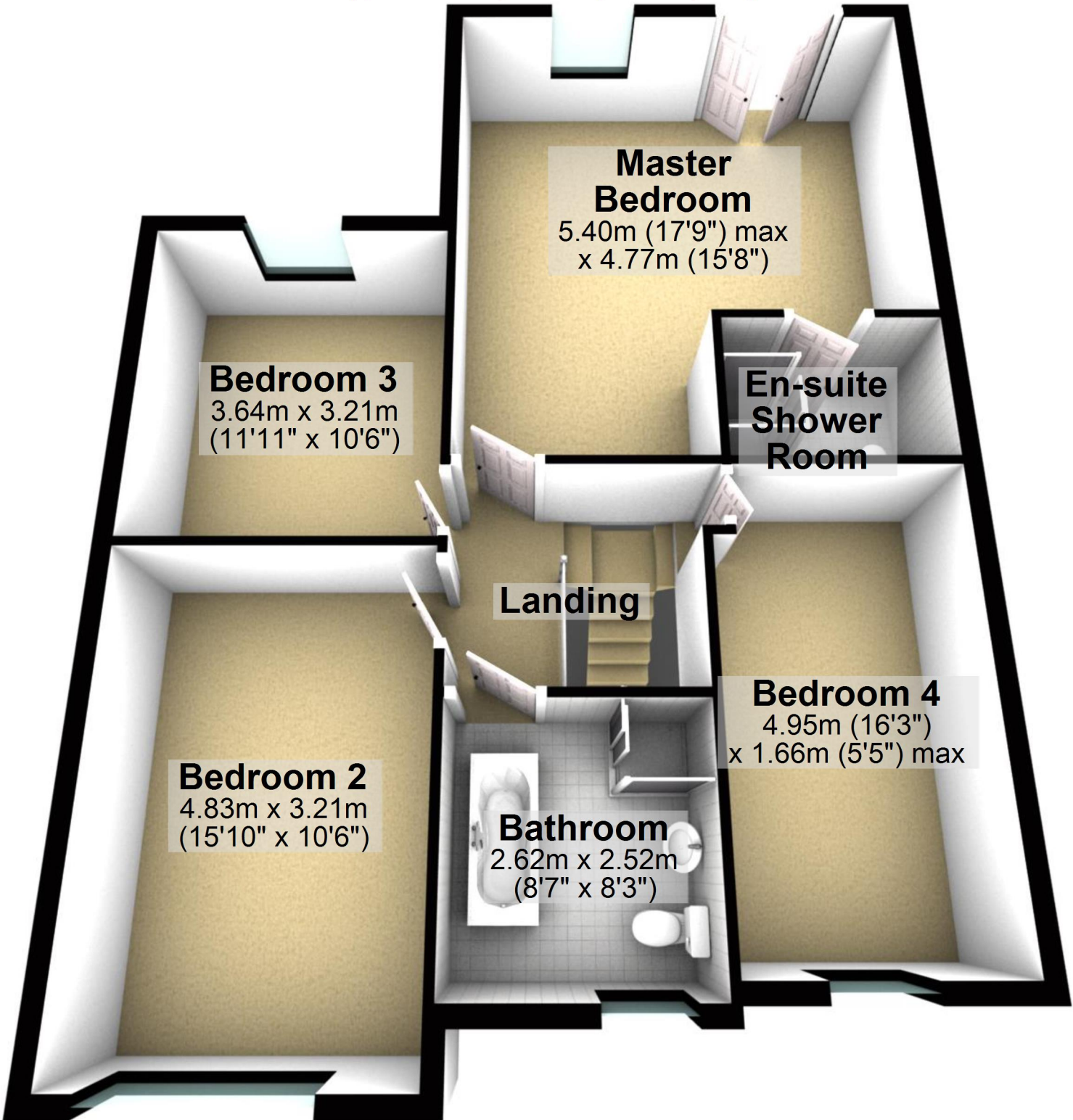

Master Bedroom
5.40m (17'9") max
x 4.77m (15'8")

Bedroom 3
3.64m x 3.21m
(11'11" x 10'6")

En-suite Shower Room

Landing

Bedroom 4
4.95m (16'3")
x 1.66m (5'5") max

Bedroom 2
4.83m x 3.21m
(15'10" x 10'6")

Bathroom
2.62m x 2.52m
(8'7" x 8'3")