

## Ground Floor

Approx. 40.5 sq. metres (435.6 sq. feet)

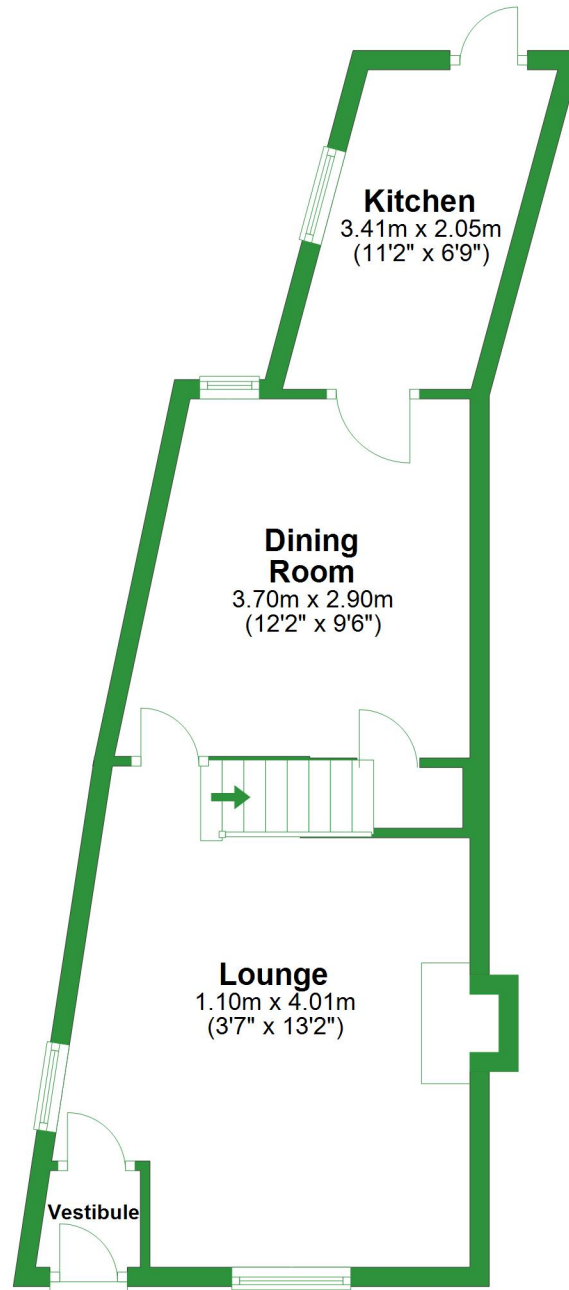

Total area: approx. 74.3 sq. metres (800.0 sq. feet)

For illustrative purposes only. Not to scale. All sizes are approximate.  
Plan produced using PlanUp.

## First Floor

Approx. 33.9 sq. metres (364.4 sq. feet)

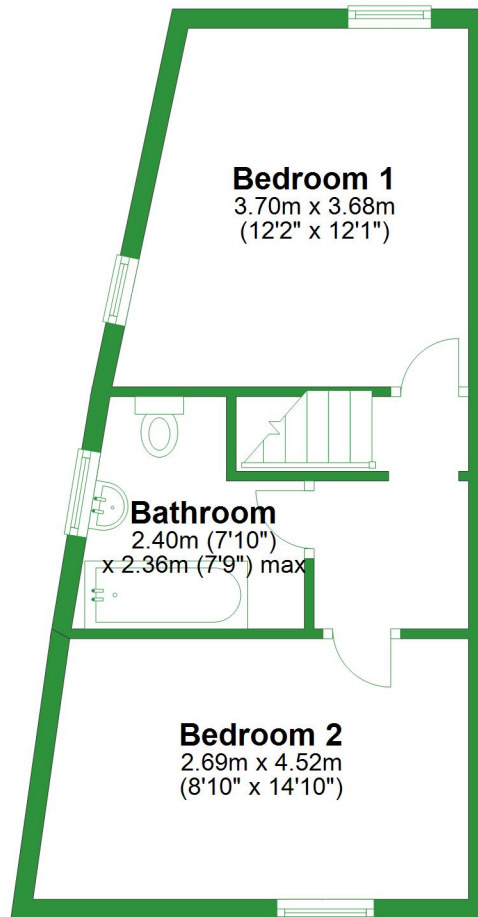

# Ground Floor

Approx. 40.5 sq. metres (435.6 sq. feet)

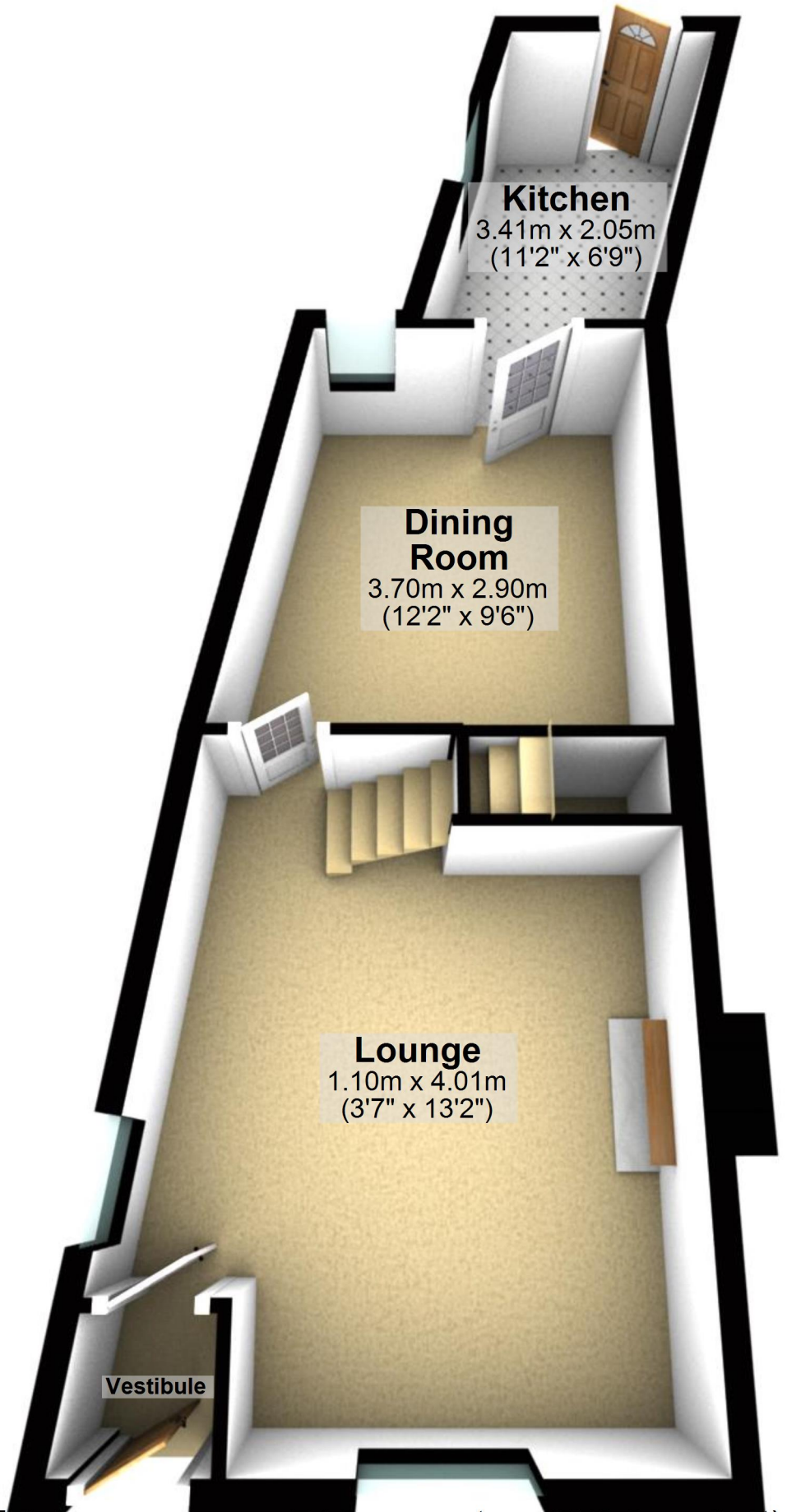

Total area: approx. 74.3 sq. metres (800.0 sq. feet)

For illustrative purposes only. Not to scale. All sizes are approximate.

Plan produced using PlanUp.

## First Floor

Approx. 33.9 sq. metres (364.4 sq. feet)

### Bedroom 1

3.70m x 3.68m  
(12'2" x 12'1")

### Bathroom

2.40m (7'10")  
x 2.36m (7'9") max

### Bedroom 2

2.69m x 4.52m  
(8'10" x 14'10")

