

# Ground Floor

Approx. 40.6 sq. metres (437.4 sq. feet)

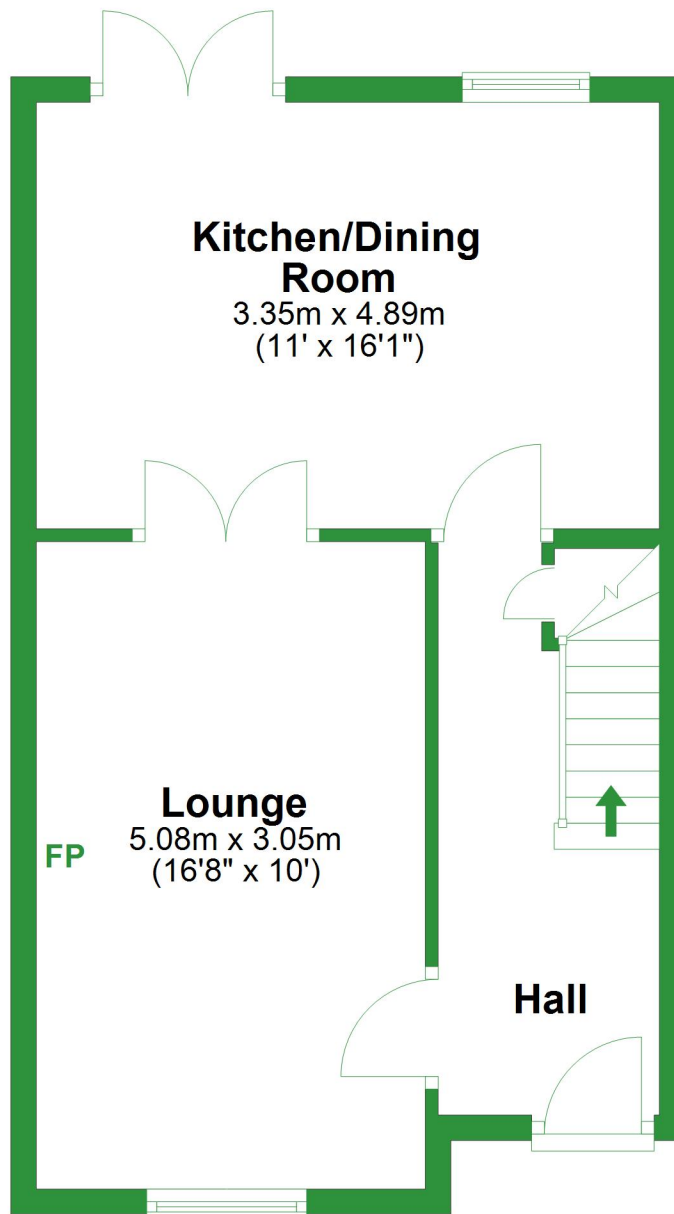

Total area: approx. 81.3 sq. metres (874.9 sq. feet)

For illustrative purposes only. Not to scale. All sizes are approximate.

Plan produced using PlanUp.

# First Floor

Approx. 40.6 sq. metres (437.4 sq. feet)

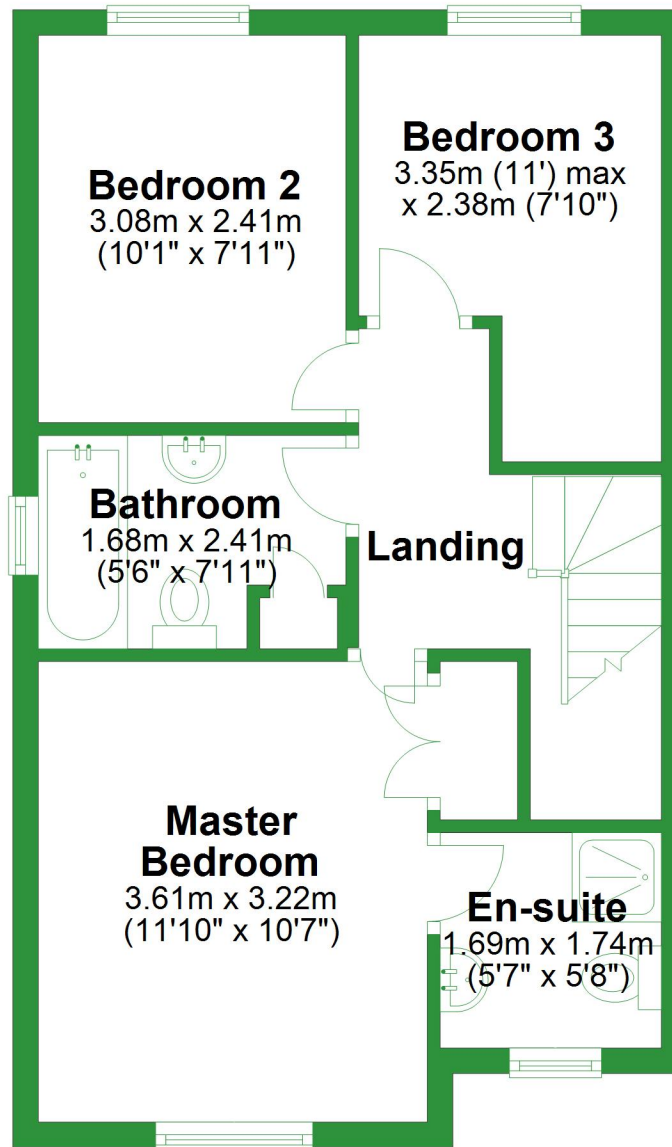

# Ground Floor

Approx. 40.6 sq. metres (437.4 sq. feet)

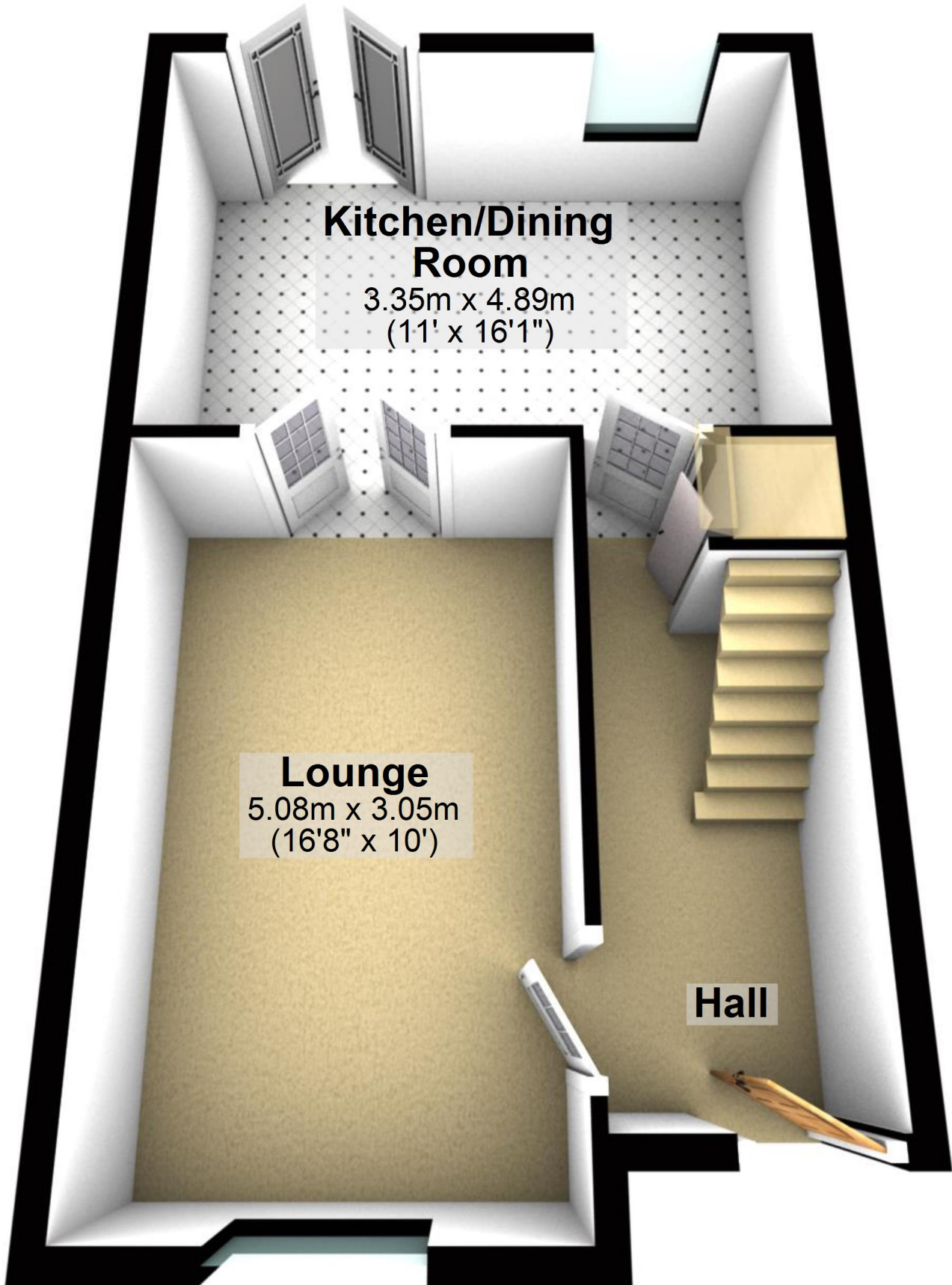

## Kitchen/Dining Room

3.35m x 4.89m  
(11' x 16'1")

## Lounge

5.08m x 3.05m  
(16'8" x 10')

Hall

Total area: approx. 81.3 sq. metres (874.9 sq. feet)

For illustrative purposes only. Not to scale. All sizes are approximate.

Plan produced using PlanUp.

# First Floor

Approx. 40.6 sq. metres (437.4 sq. feet)

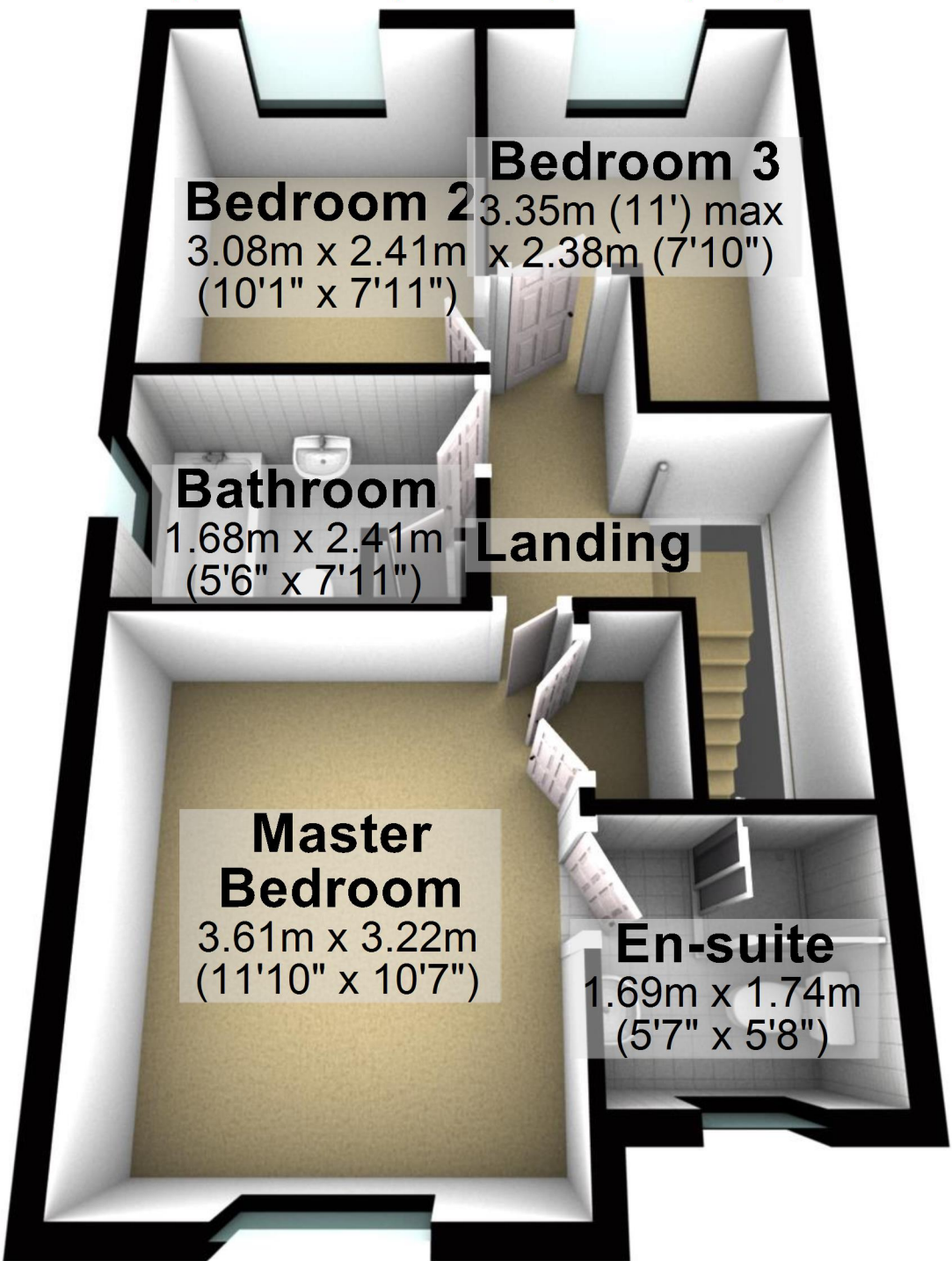

**Bedroom 2**  
3.35m (11') max  
3.08m x 2.41m x 2.38m (7'10")  
(10'1" x 7'11")

**Bedroom 3**

**Bathroom**  
1.68m x 2.41m  
(5'6" x 7'11")

**Landing**

**Master  
Bedroom**  
3.61m x 3.22m  
(11'10" x 10'7")

**En-suite**  
1.69m x 1.74m  
(5'7" x 5'8")