

# Ground Floor

Approx. 55.9 sq. metres (601.6 sq. feet)

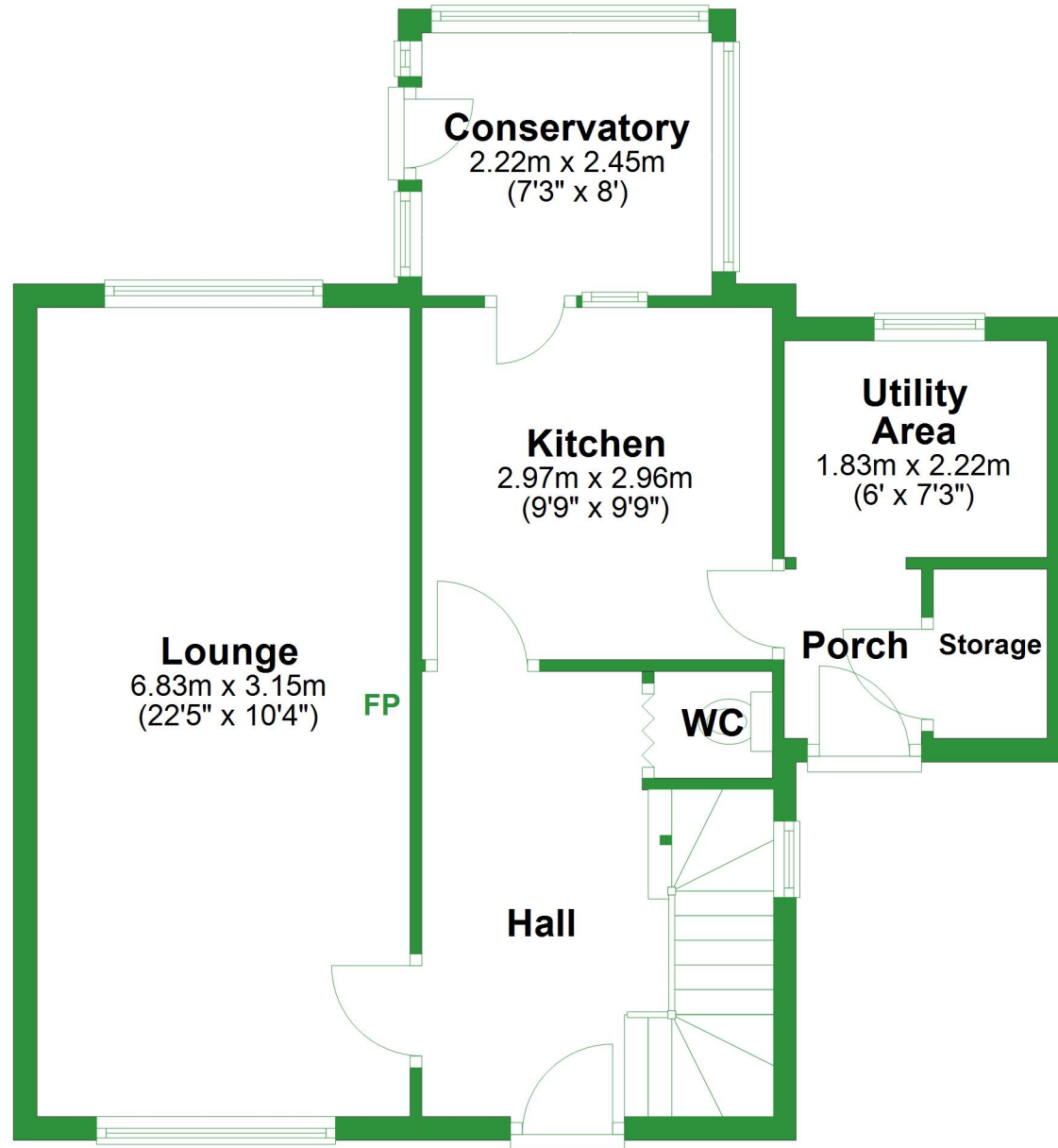

Total area: approx. 98.3 sq. metres (1058.1 sq. feet)

For illustrative purposes only. Not to scale. All sizes are approximate.

Plan produced using PlanUp.

## First Floor

Approx. 42.4 sq. metres (456.5 sq. feet)

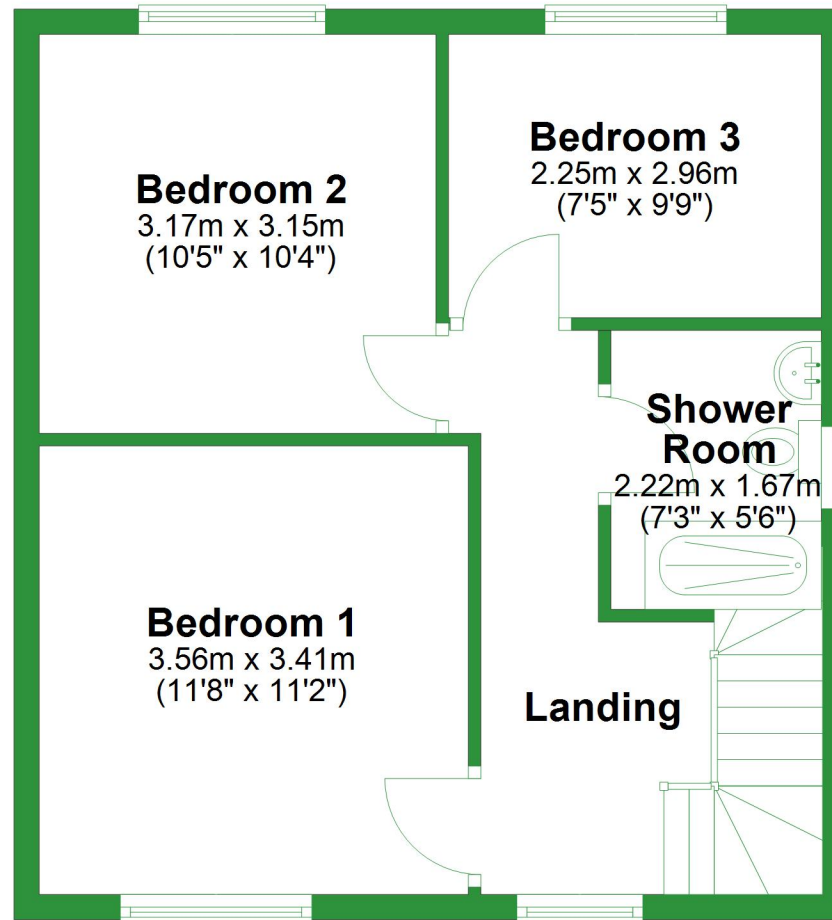

# Ground Floor

Approx. 55.9 sq. metres (601.6 sq. feet)

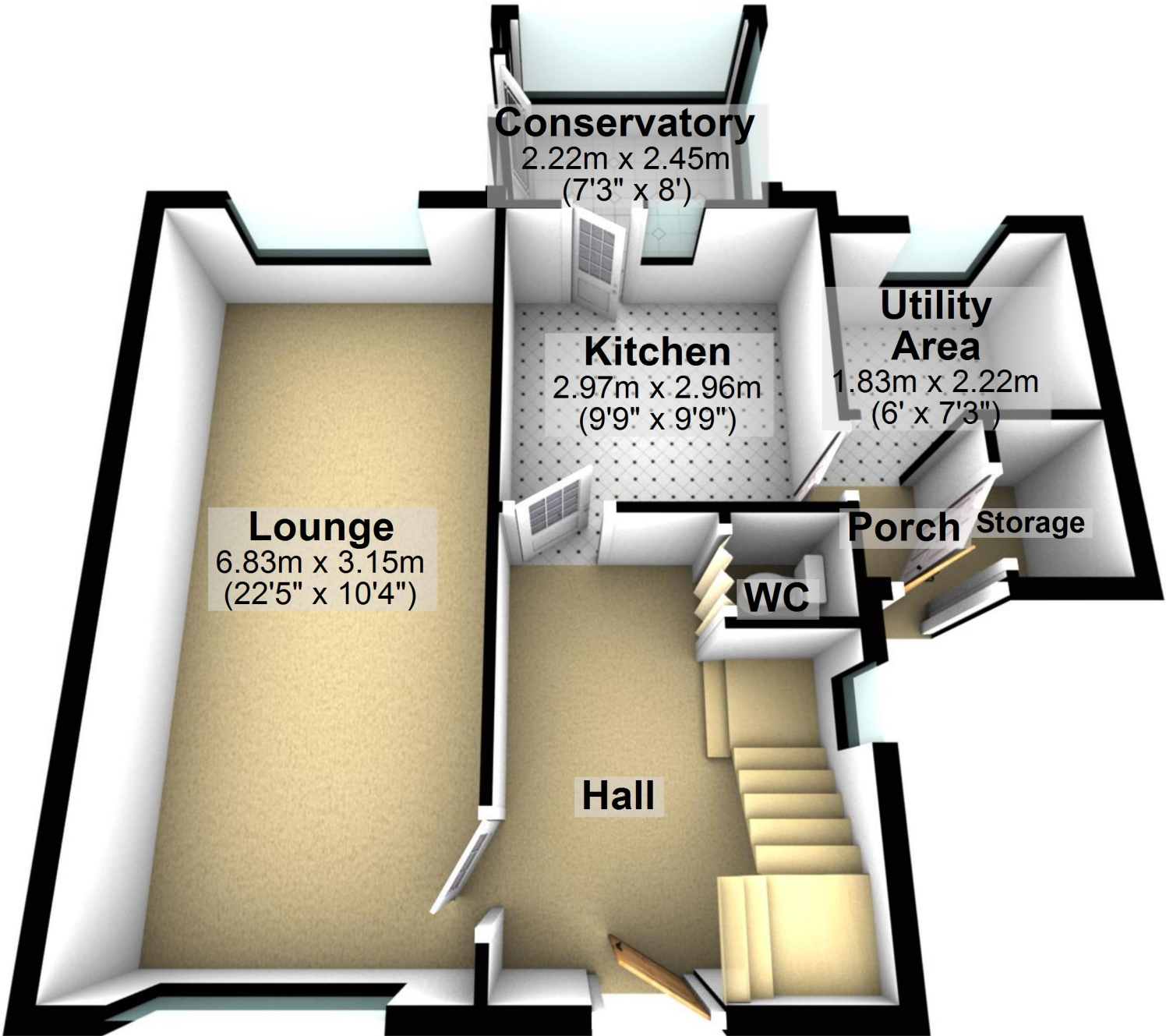

Total area: approx. 98.3 sq. metres (1058.1 sq. feet)

For illustrative purposes only. Not to scale. All sizes are approximate.

Plan produced using PlanUp.

# First Floor

Approx. 42.4 sq. metres (456.5 sq. feet)

**Bedroom 2**  
3.17m x 3.15m  
(10'5" x 10'4")

**Bedroom 3**  
2.25m x 2.96m  
(7'5" x 9'9")

**Shower Room**  
2.22m x 1.67m  
(7'3" x 5'6")

**Bedroom 1**  
3.56m x 3.41m  
(11'8" x 11'2")

**Landing**

