

# Ground Floor

Approx. 75.3 sq. metres (810.0 sq. feet)

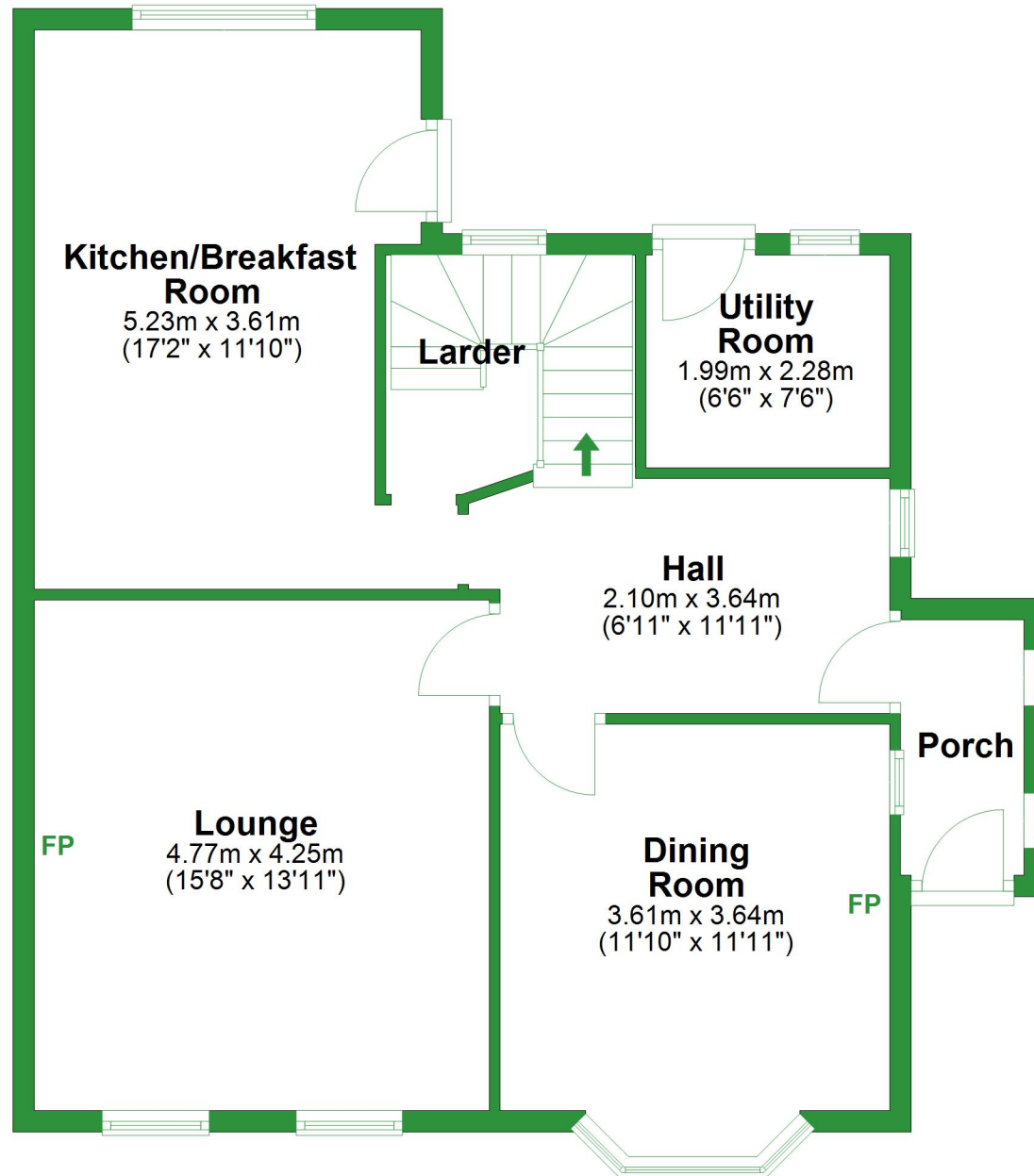

Total area: approx. 139.4 sq. metres (1500.3 sq. feet)

For illustrative purposes only. Not to scale. All sizes are approximate.

Plan produced using PlanUp.

## First Floor

Approx. 64.1 sq. metres (690.3 sq. feet)

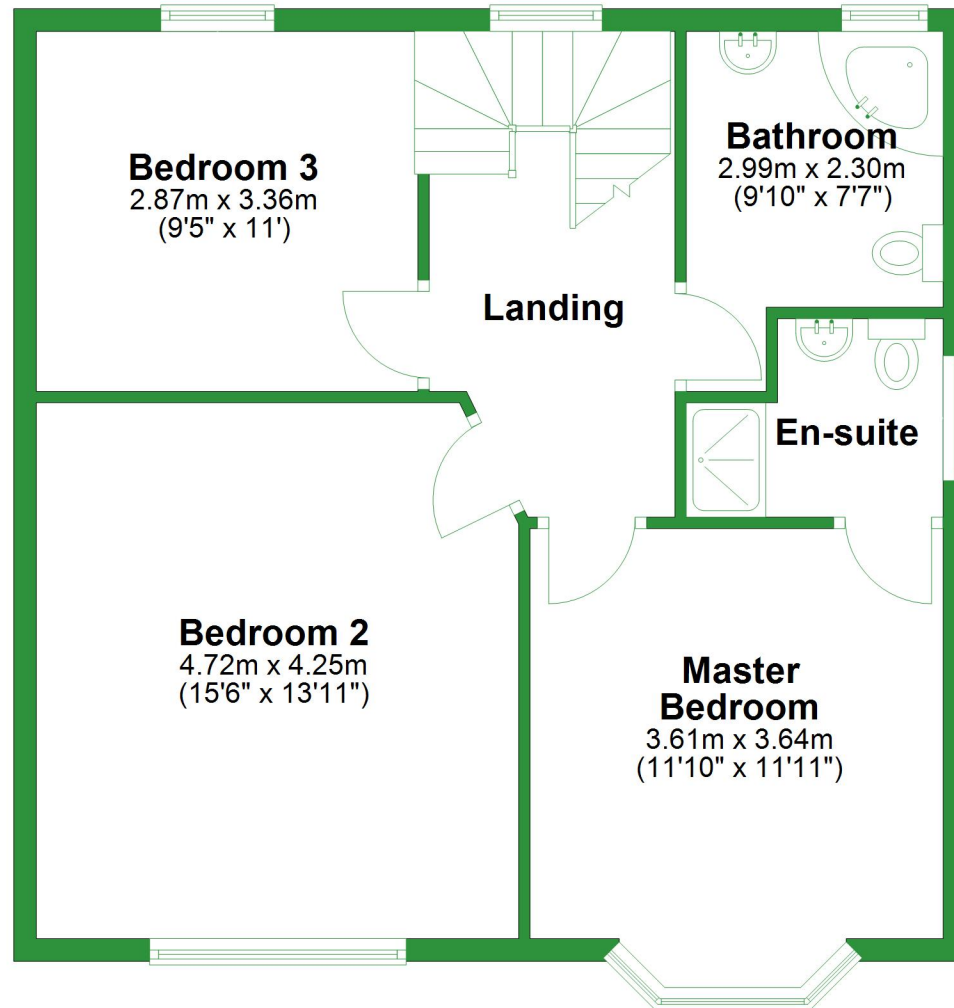

## Ground Floor

Approx. 75.3 sq. metres (810.0 sq. feet)

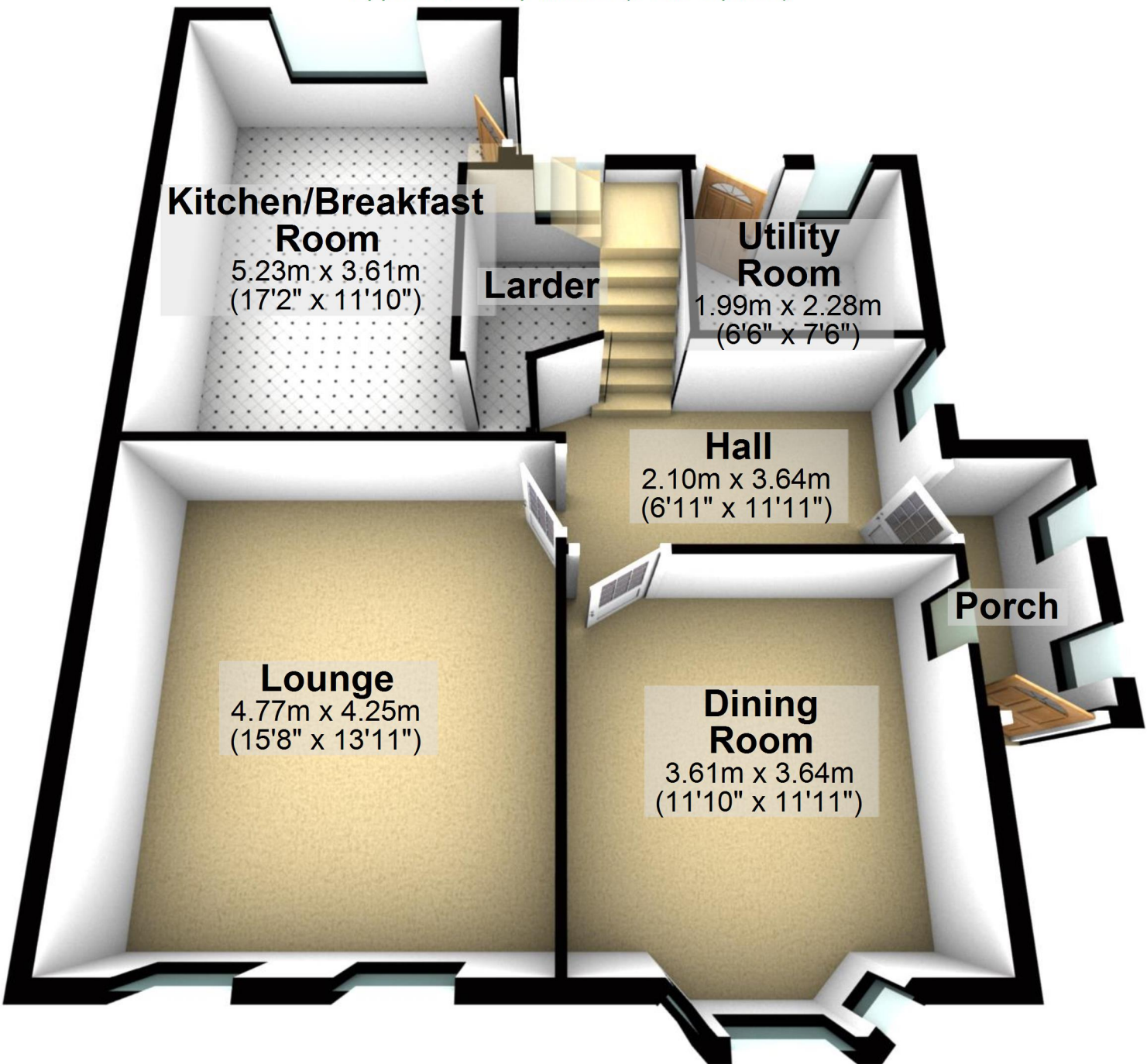

Total area: approx. 139.4 sq. metres (1500.3 sq. feet)

For illustrative purposes only. Not to scale. All sizes are approximate.  
Plan produced using PlanUp.

# First Floor

Approx. 64.1 sq. metres (690.3 sq. feet)

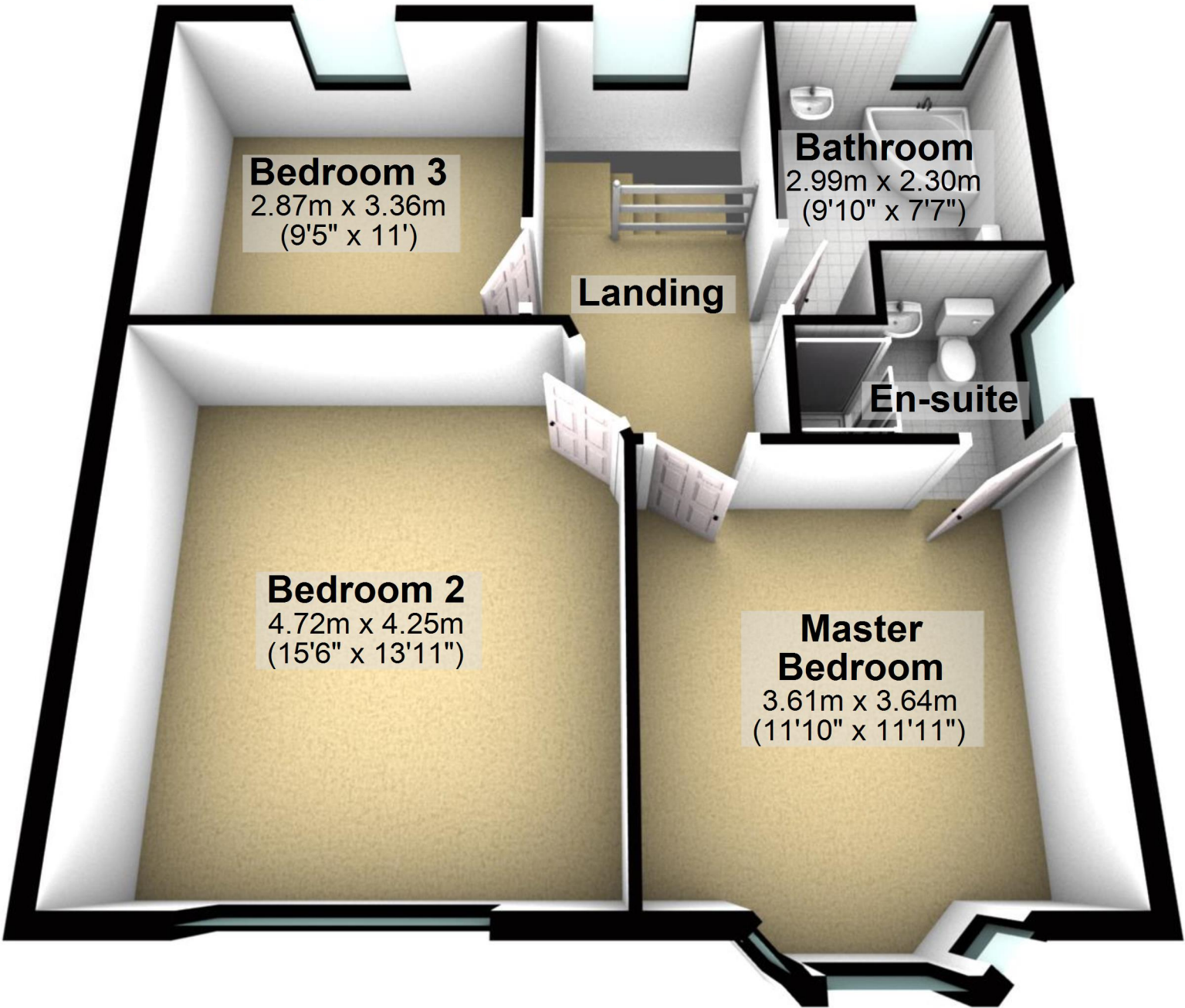

**Bedroom 3**  
2.87m x 3.36m  
(9'5" x 11')

**Landing**

**Bathroom**  
2.99m x 2.30m  
(9'10" x 7'7")

**En-suite**

**Bedroom 2**  
4.72m x 4.25m  
(15'6" x 13'11")

**Master  
Bedroom**  
3.61m x 3.64m  
(11'10" x 11'11")