

# Ground Floor

Approx. 88.4 sq. metres (951.6 sq. feet)

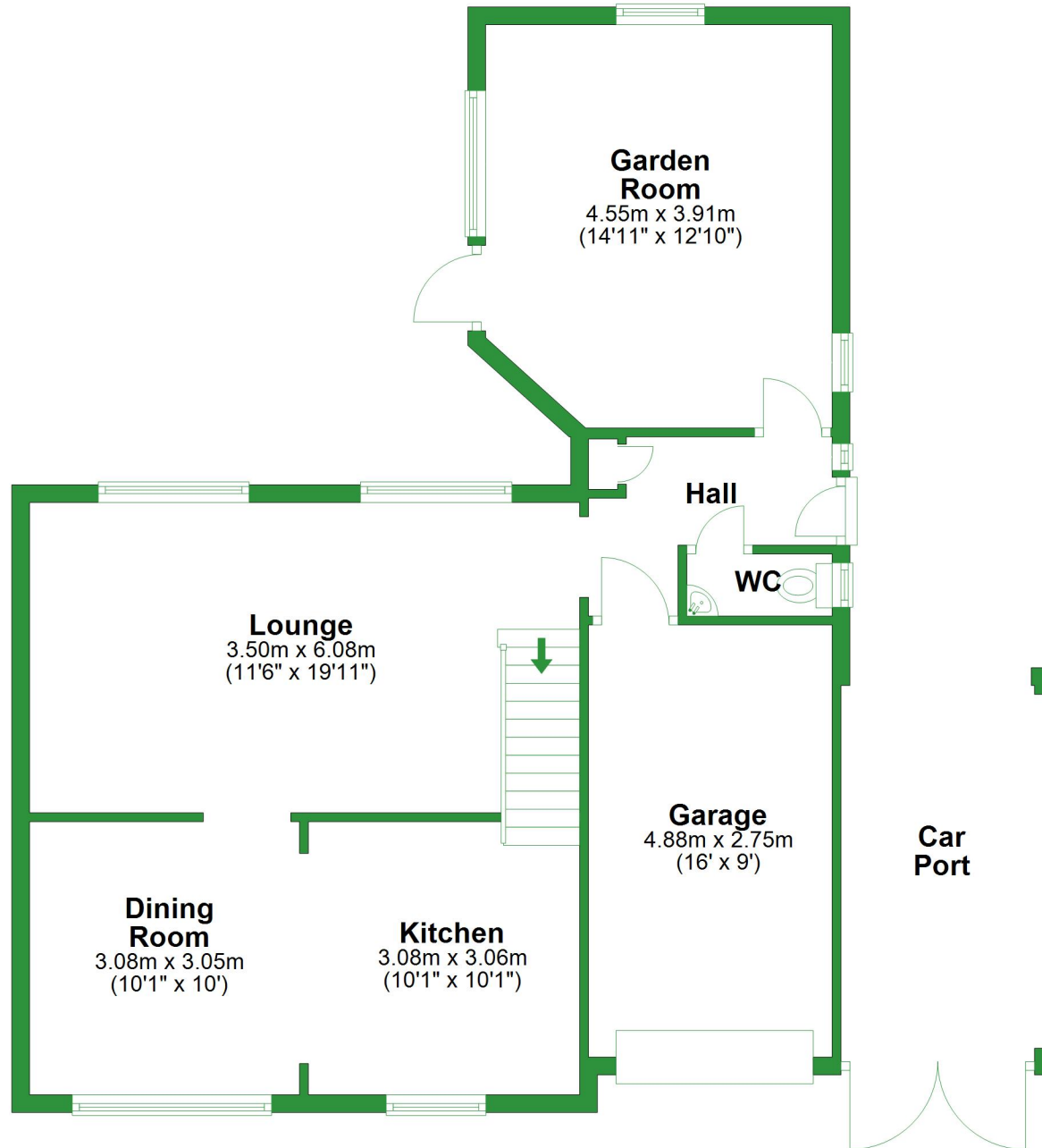

Total area: approx. 151.2 sq. metres (1627.9 sq. feet)

For illustrative purposes only. Not to scale. All sizes are approximate.  
Plan produced using PlanUp.

## First Floor

Approx. 41.5 sq. metres (446.4 sq. feet)

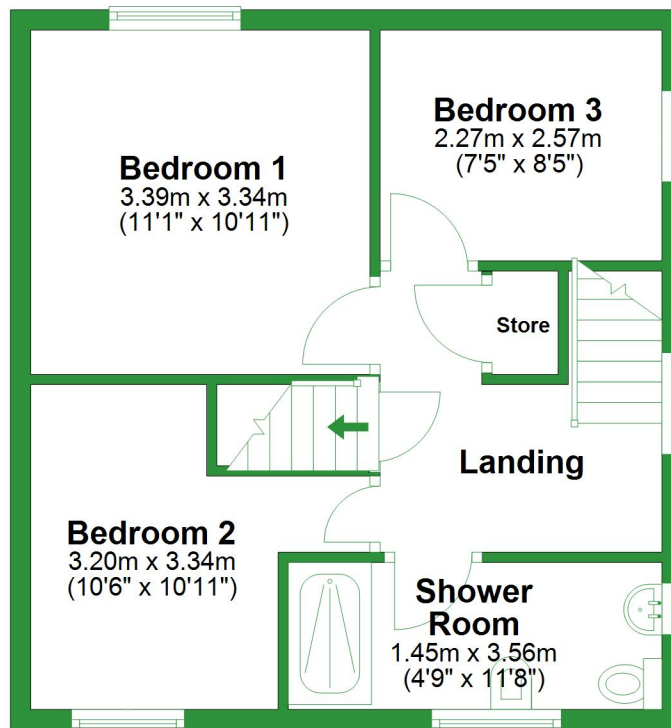

## Second Floor

Approx. 21.3 sq. metres (229.8 sq. feet)

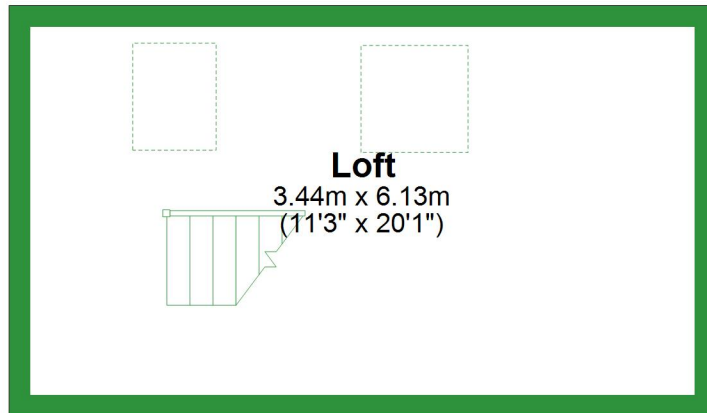

## Ground Floor

Approx. 88.4 sq. metres (951.6 sq. feet)

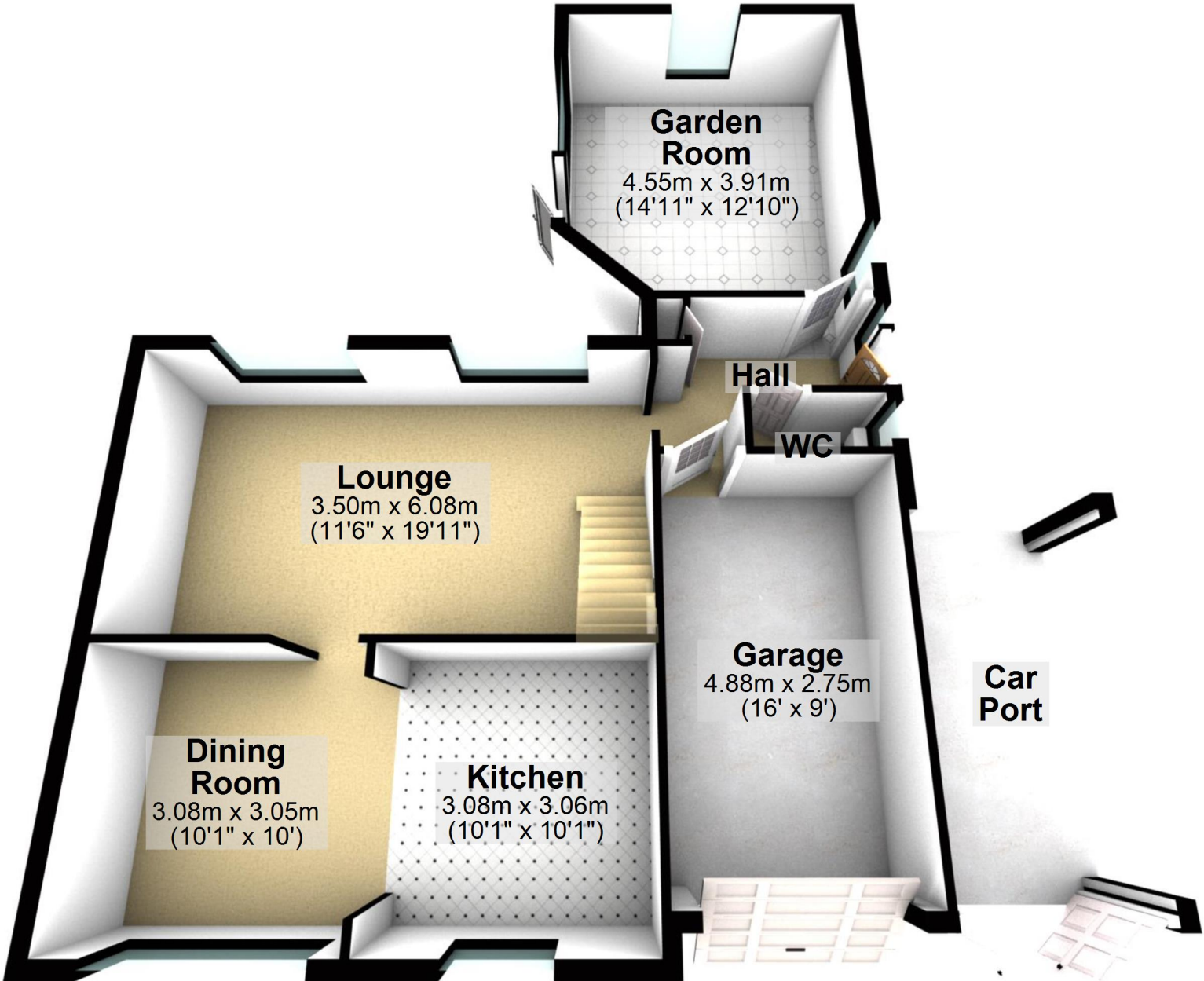

Total area: approx. 151.2 sq. metres (1627.9 sq. feet)

For illustrative purposes only. Not to scale. All sizes are approximate.  
Plan produced using PlanUp.

## First Floor

Approx. 41.5 sq. metres (446.4 sq. feet)

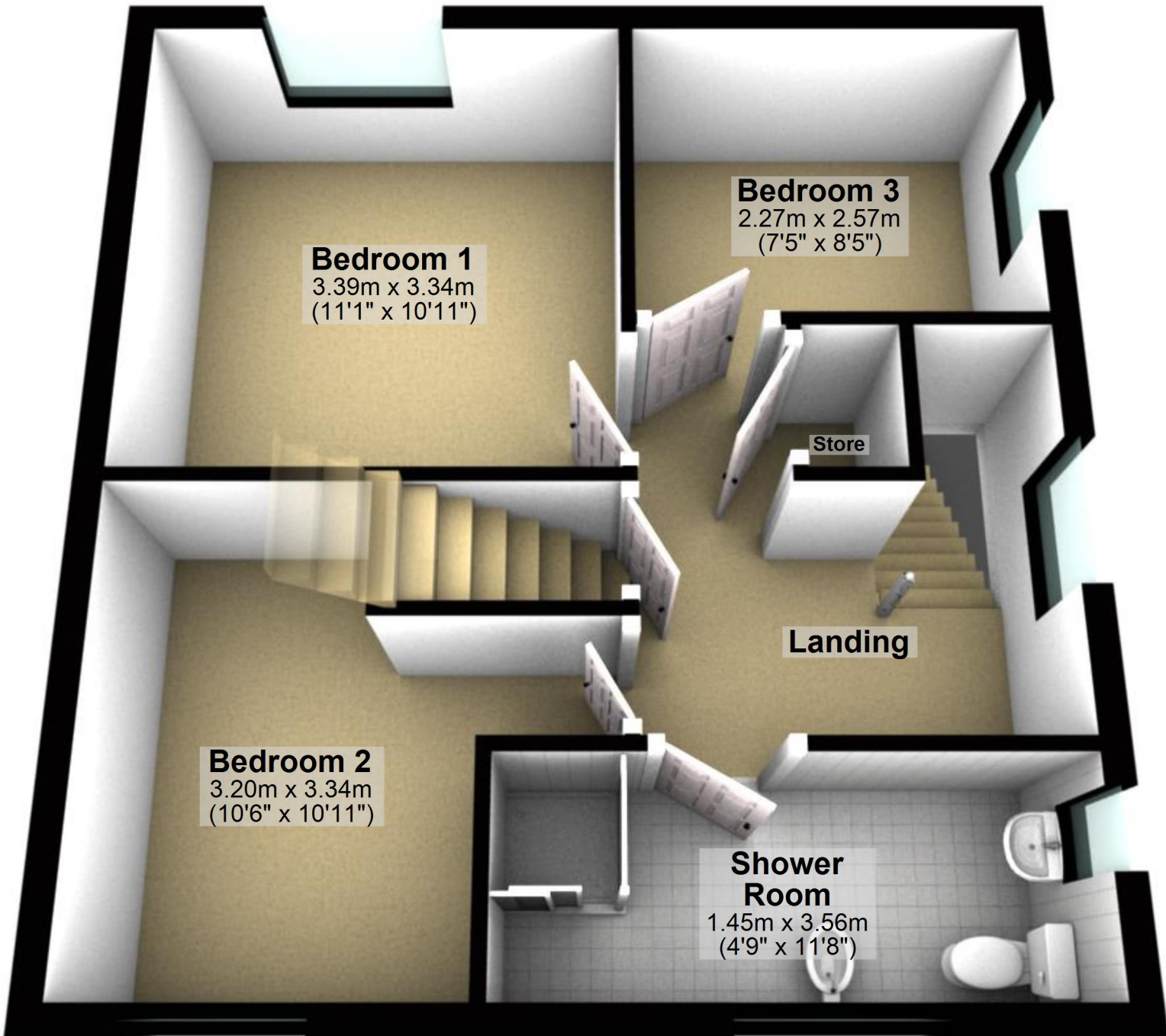

## Second Floor

Approx. 21.3 sq. metres (229.8 sq. feet)

### Loft

3.44m x 6.13m  
(11'3" x 20'1")

