

# Ground Floor

Approx. 28.6 sq. metres (308.0 sq. feet)

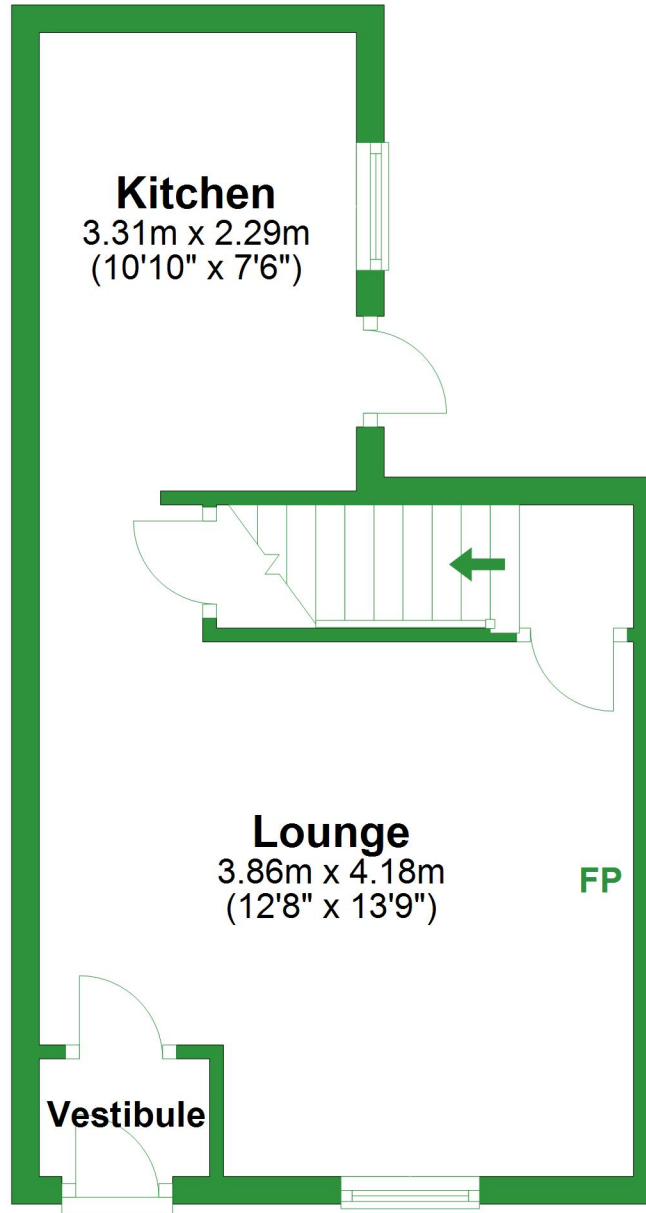

Total area: approx. 56.9 sq. metres (611.9 sq. feet)

For illustrative purposes only. Not to scale. All sizes are approximate.  
Plan produced using PlanUp.

# First Floor

Approx. 28.2 sq. metres (303.9 sq. feet)

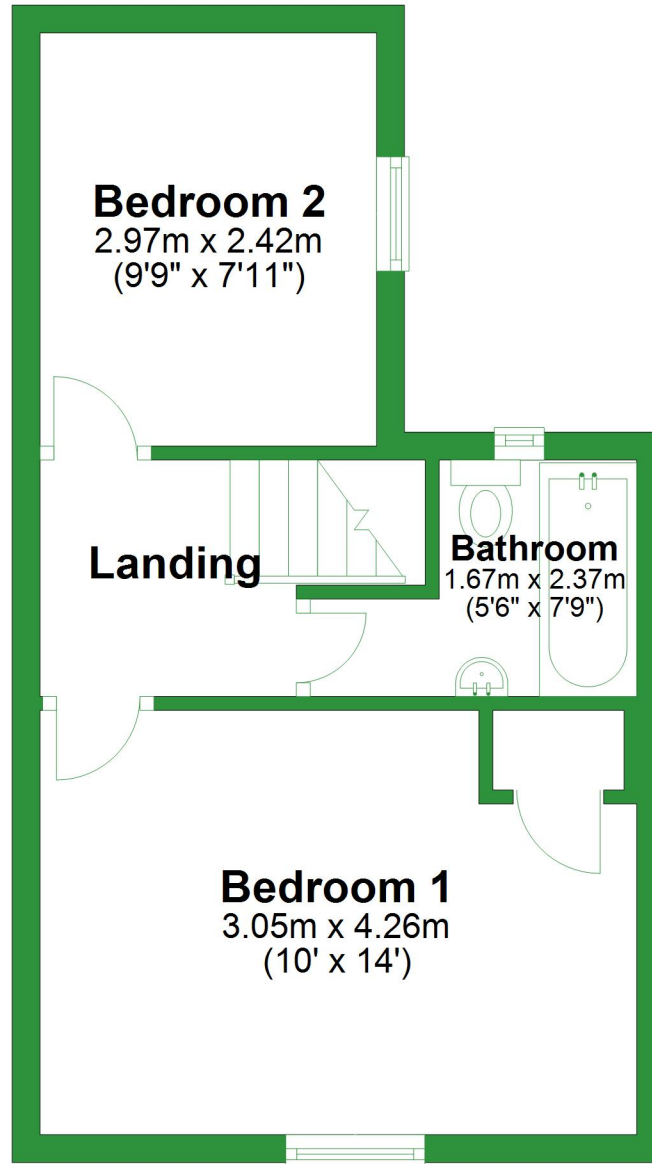

# Ground Floor

Approx. 28.6 sq. metres (308.0 sq. feet)

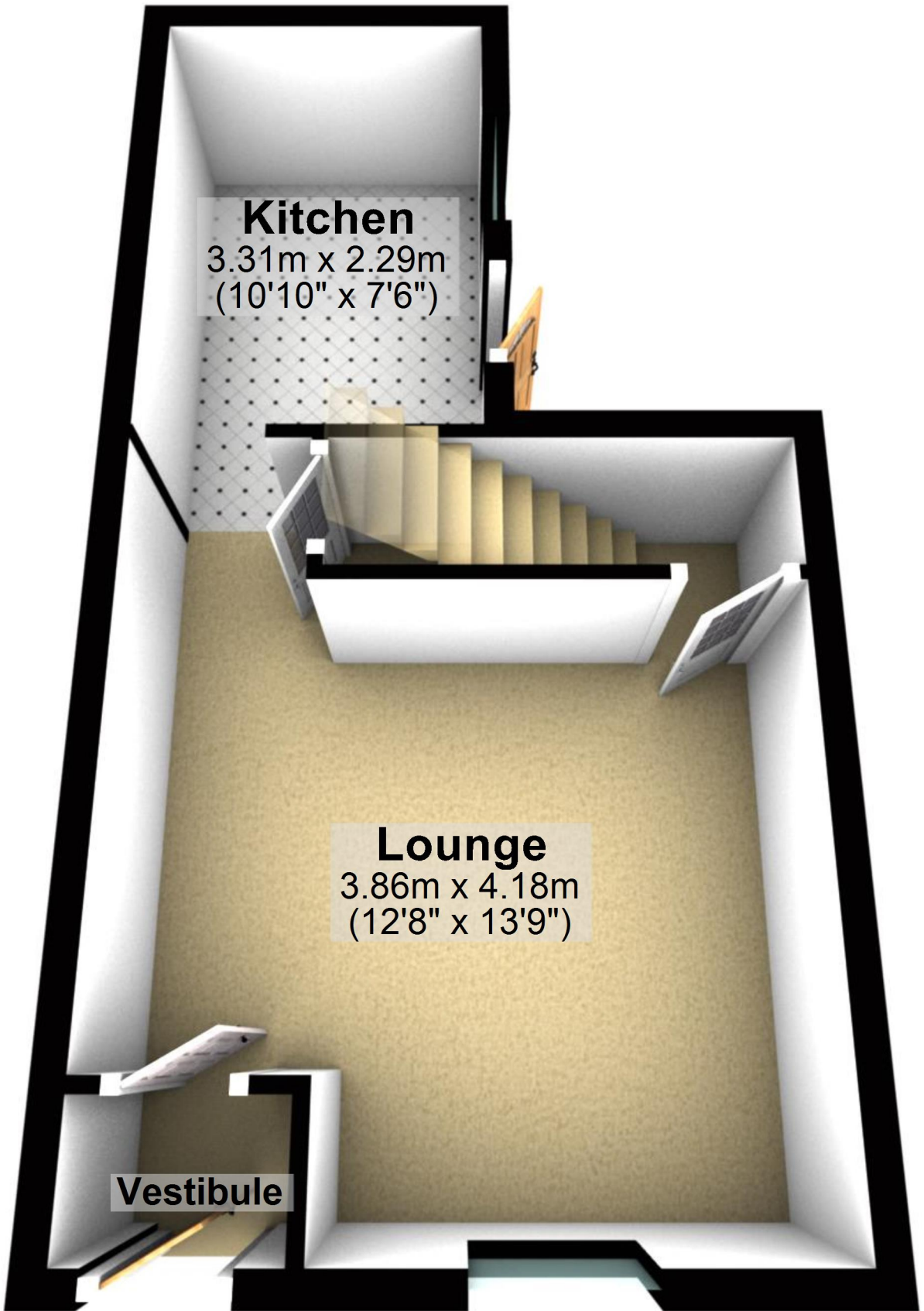

Total area: approx. 56.9 sq. metres (611.9 sq. feet)

For illustrative purposes only. Not to scale. All sizes are approximate.

Plan produced using PlanUp.

# First Floor

Approx. 28.2 sq. metres (303.9 sq. feet)

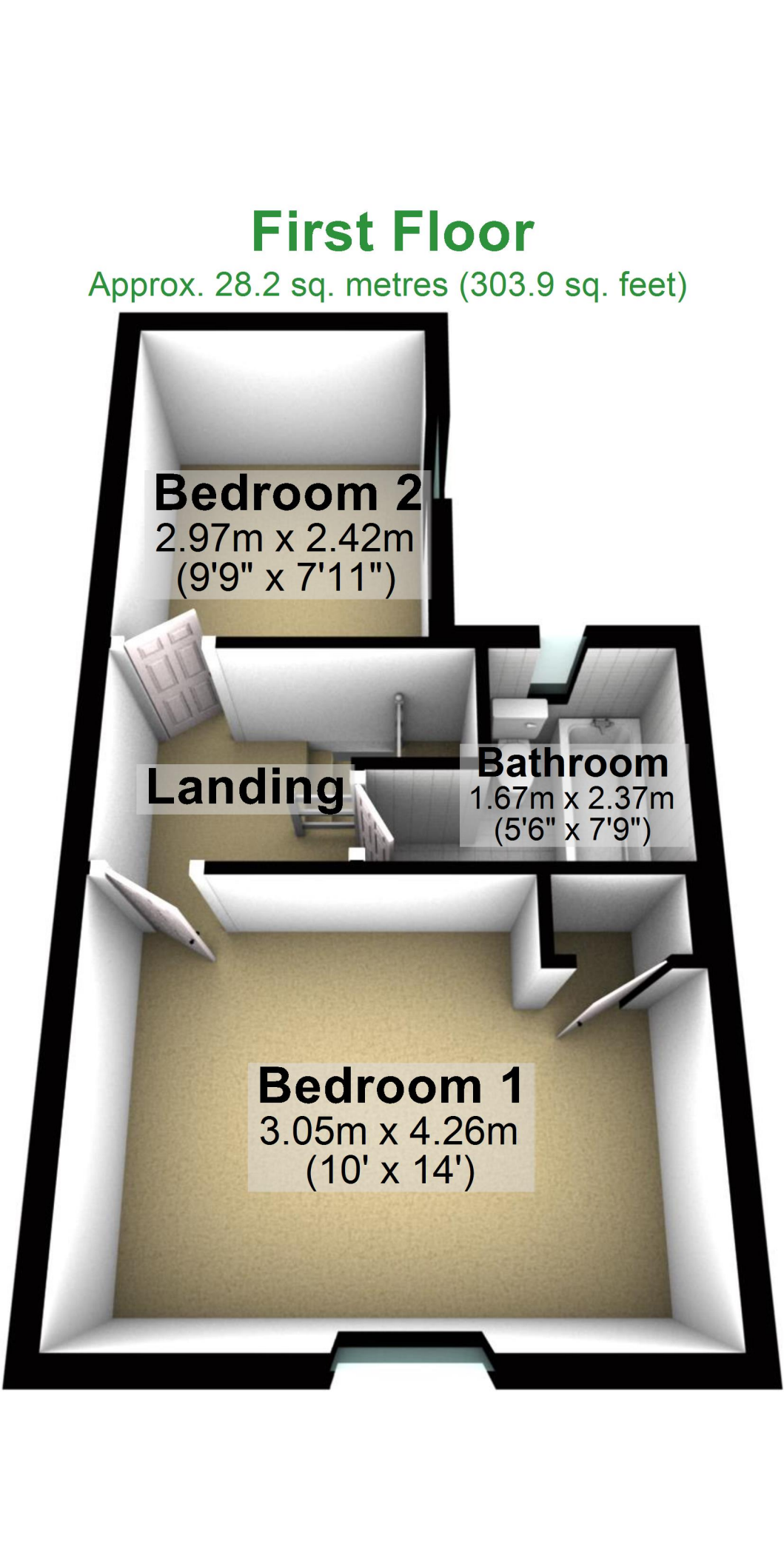

**Bedroom 2**  
2.97m x 2.42m  
(9'9" x 7'11")

**Landing**

**Bathroom**  
1.67m x 2.37m  
(5'6" x 7'9")

**Bedroom 1**  
3.05m x 4.26m  
(10' x 14')