

## Ground Floor

Approx. 58.0 sq. metres (624.3 sq. feet)

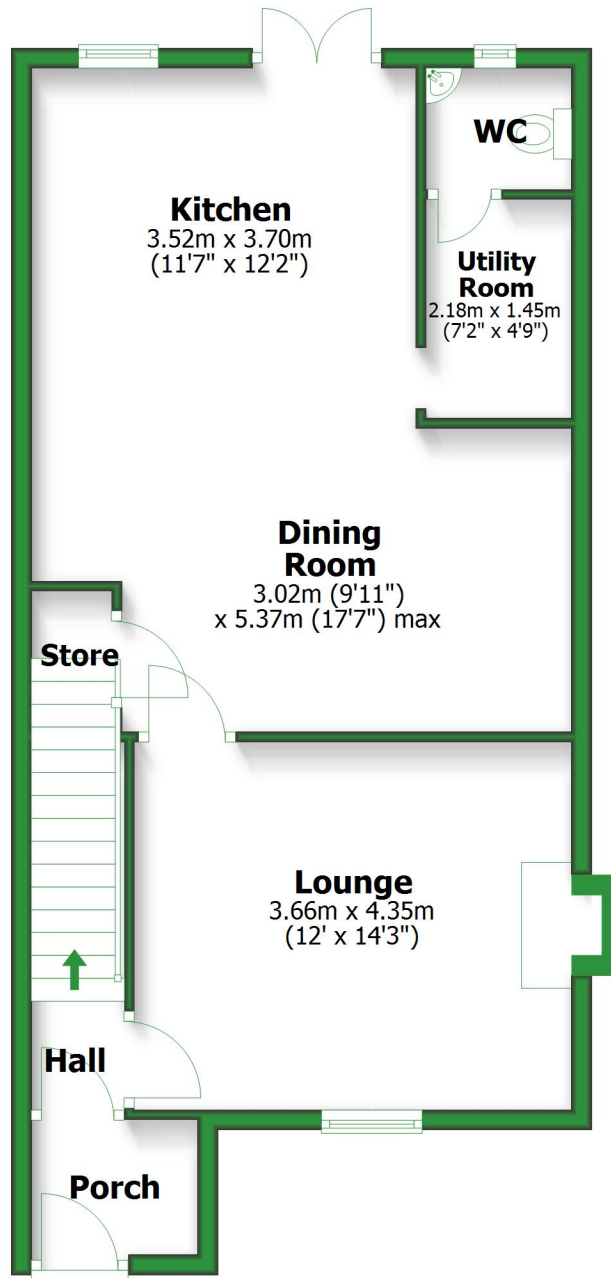

Total area: approx. 113.6 sq. metres (1223.0 sq. feet)

For illustrative purposes only. Not to scale. All sizes are approximate.  
Plan produced using PlanUp.

# First Floor

Approx. 55.6 sq. metres (598.7 sq. feet)

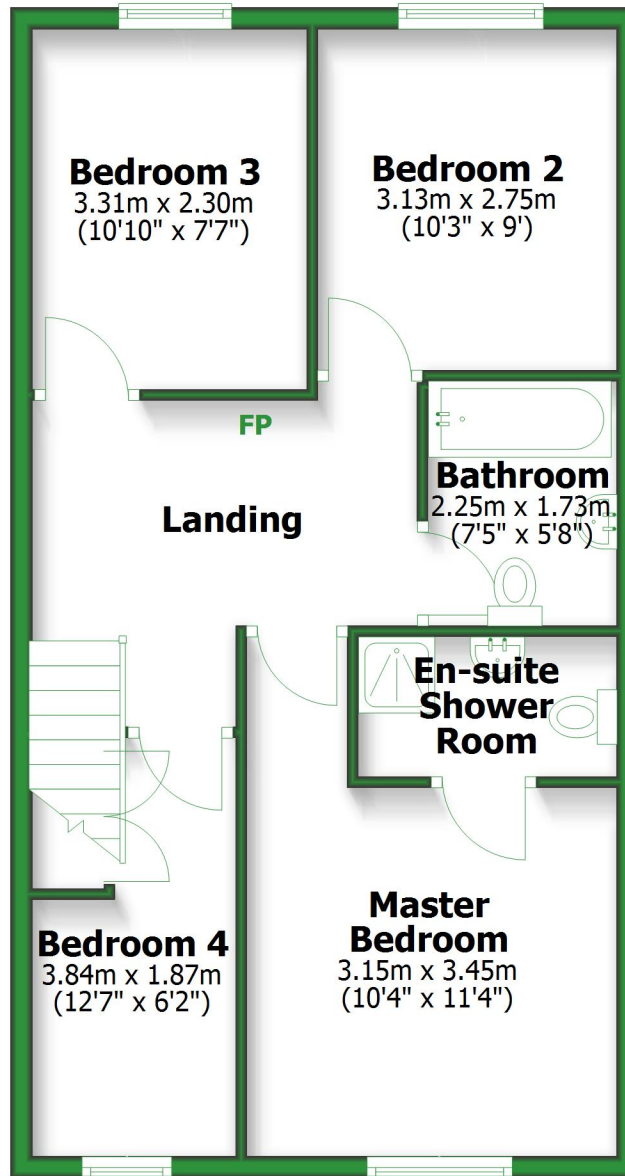

# Ground Floor

Approx. 58.0 sq. metres (624.3 sq. feet)

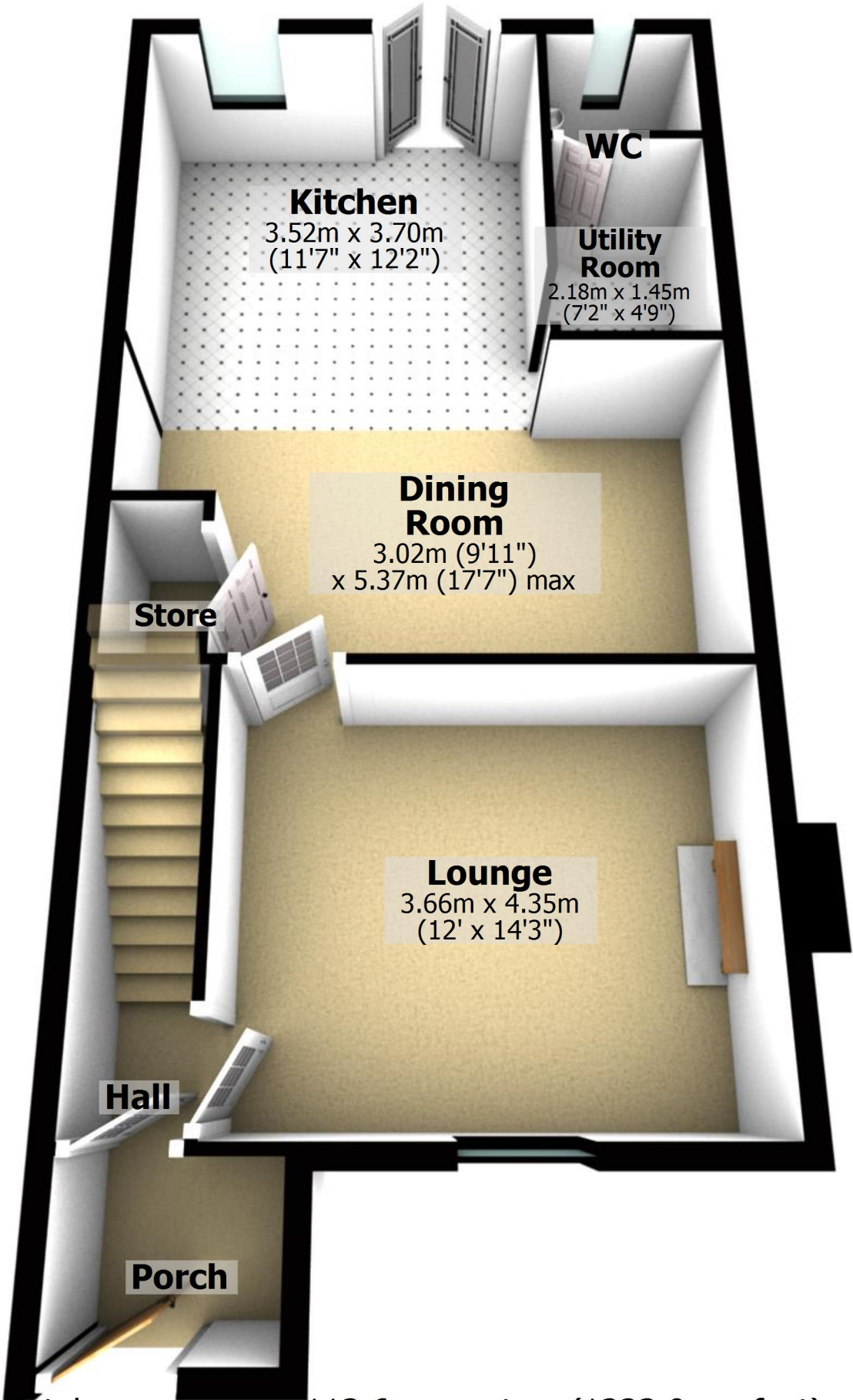

Total area: approx. 113.6 sq. metres (1223.0 sq. feet)

For illustrative purposes only. Not to scale. All sizes are approximate.

Plan produced using PlanUp.

# First Floor

Approx. 55.6 sq. metres (598.7 sq. feet)

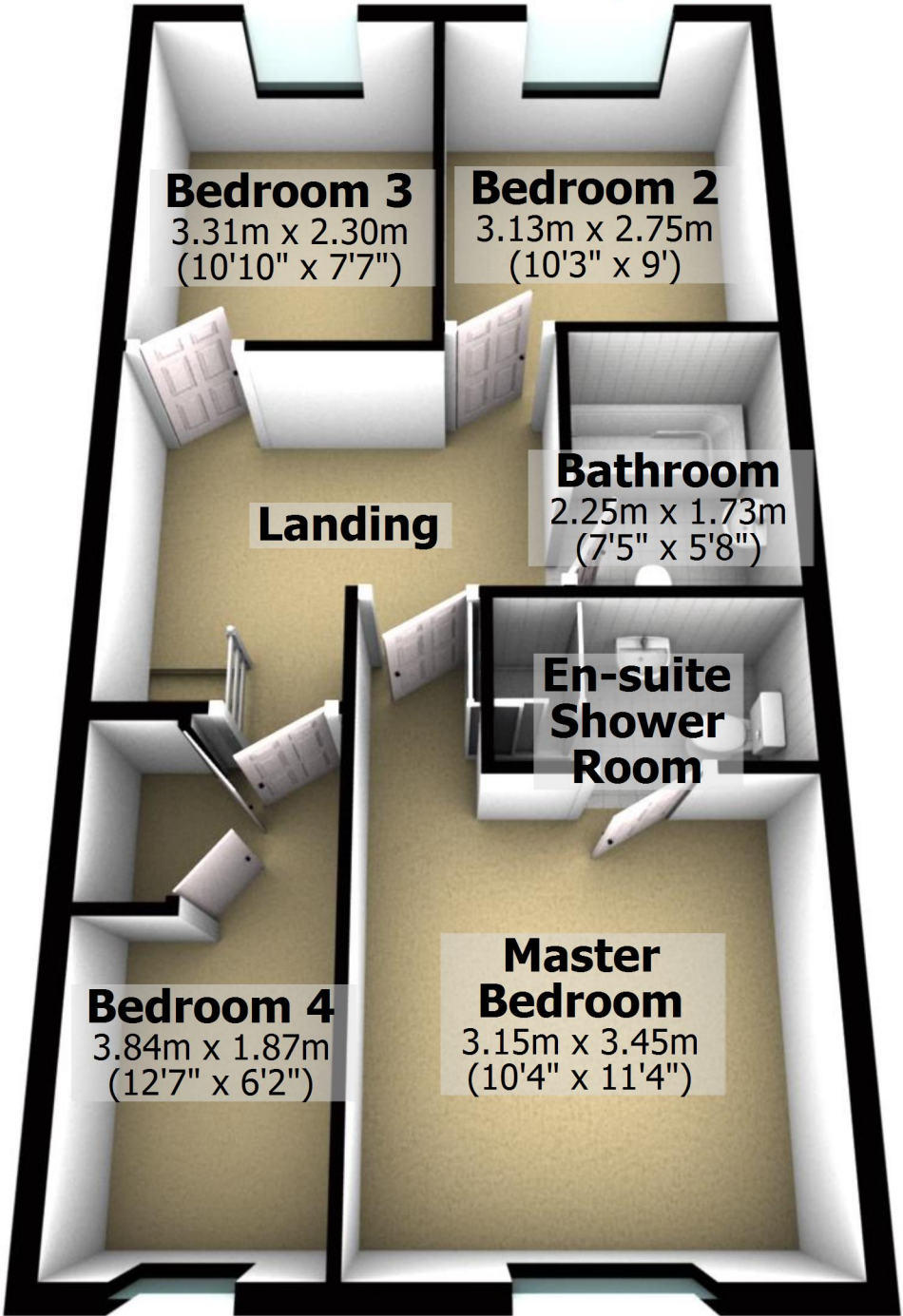

**Bedroom 3**  
3.31m x 2.30m  
(10'10" x 7'7")

**Bedroom 2**  
3.13m x 2.75m  
(10'3" x 9')

**Landing**

**Bathroom**  
2.25m x 1.73m  
(7'5" x 5'8")

**En-suite  
Shower  
Room**

**Bedroom 4**  
3.84m x 1.87m  
(12'7" x 6'2")

**Master  
Bedroom**  
3.15m x 3.45m  
(10'4" x 11'4")