

# Ground Floor

Approx. 38.4 sq. metres (412.9 sq. feet)

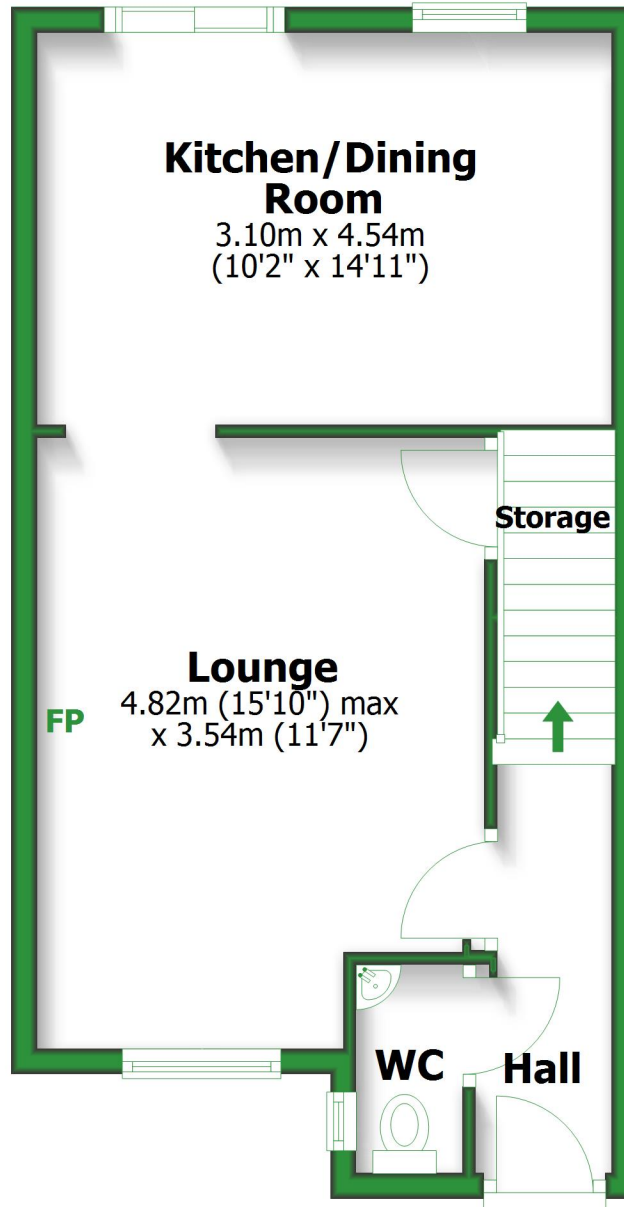

Total area: approx. 74.7 sq. metres (804.4 sq. feet)

For illustrative purposes only. Not to scale. All sizes are approximate.  
Plan produced using PlanUp.

# First Floor

Approx. 36.4 sq. metres (391.6 sq. feet)

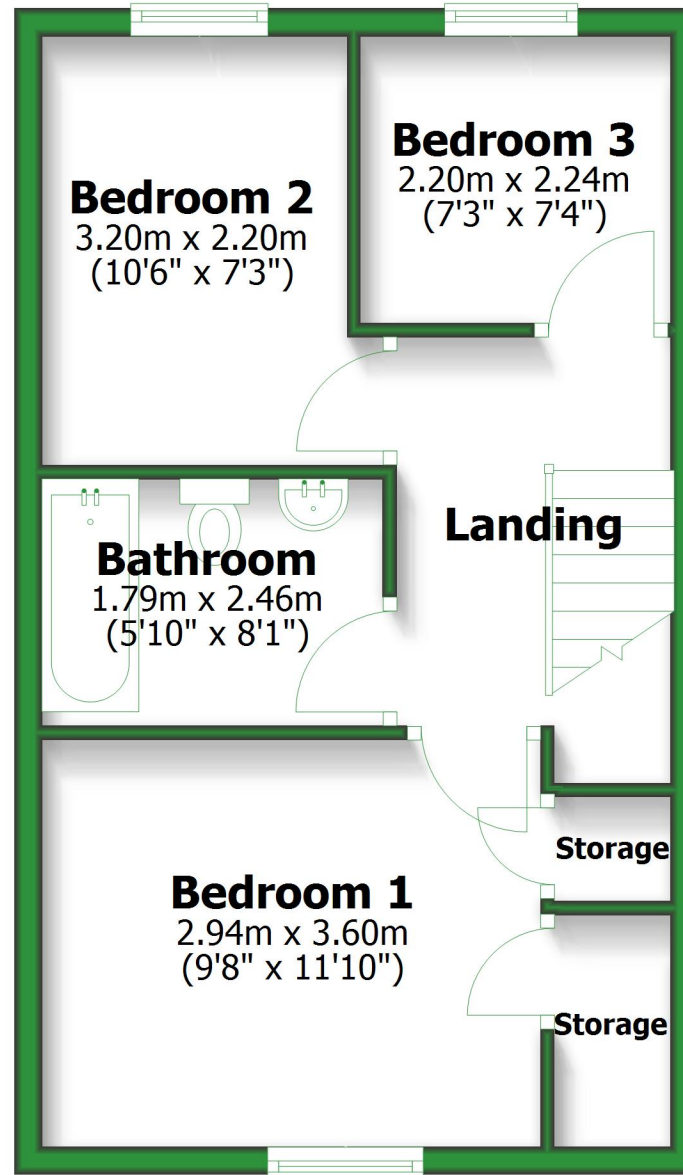

# Ground Floor

Approx. 38.4 sq. metres (412.9 sq. feet)

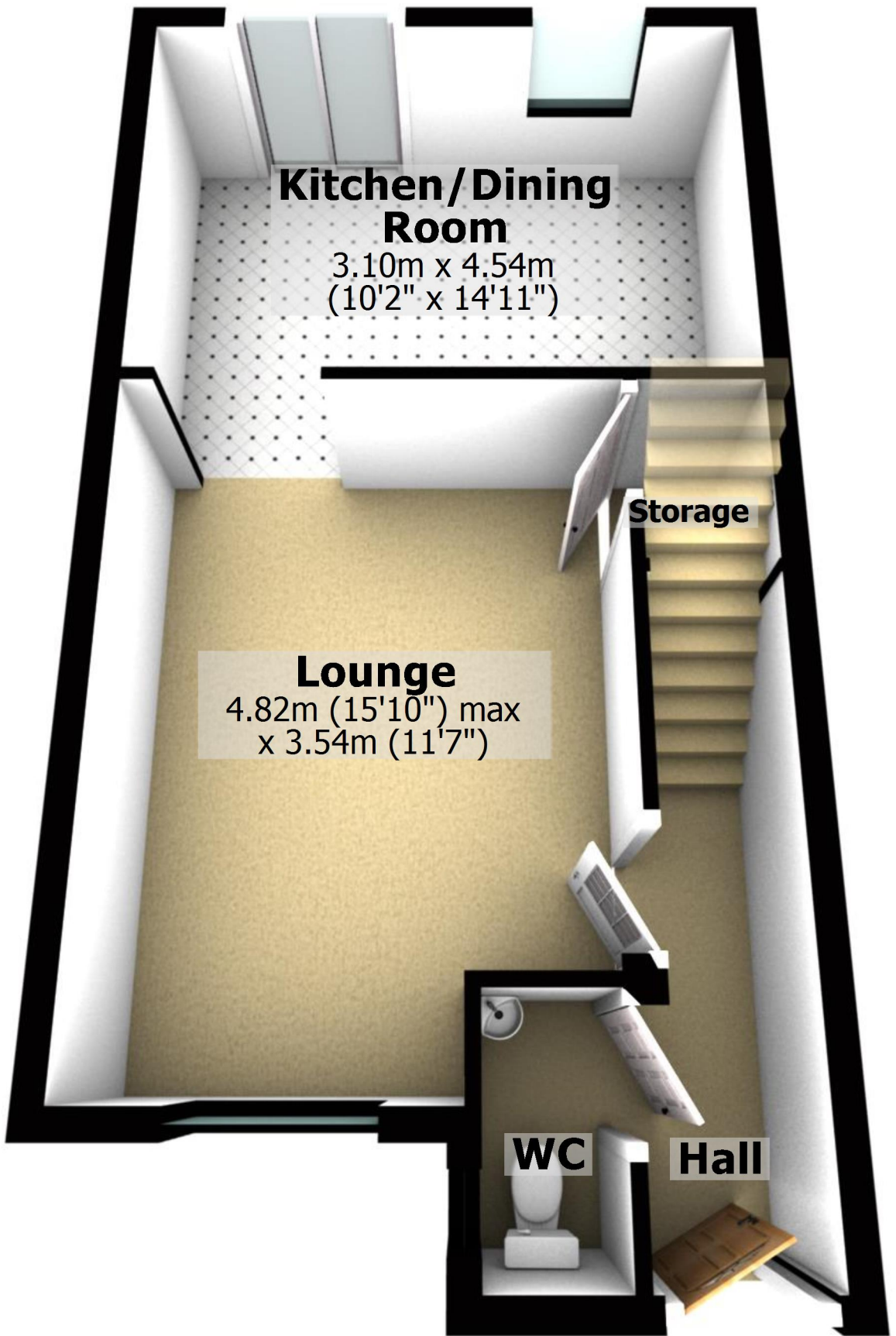

## Kitchen/Dining Room

3.10m x 4.54m  
(10'2" x 14'11")

## Lounge

4.82m (15'10") max  
x 3.54m (11'7")

Storage

WC

Hall

Total area: approx. 74.7 sq. metres (804.4 sq. feet)

For illustrative purposes only. Not to scale. All sizes are approximate.

Plan produced using PlanUp.

# First Floor

Approx. 36.4 sq. metres (391.6 sq. feet)

