

# Ground Floor

Approx. 66.2 sq. metres (712.3 sq. feet)

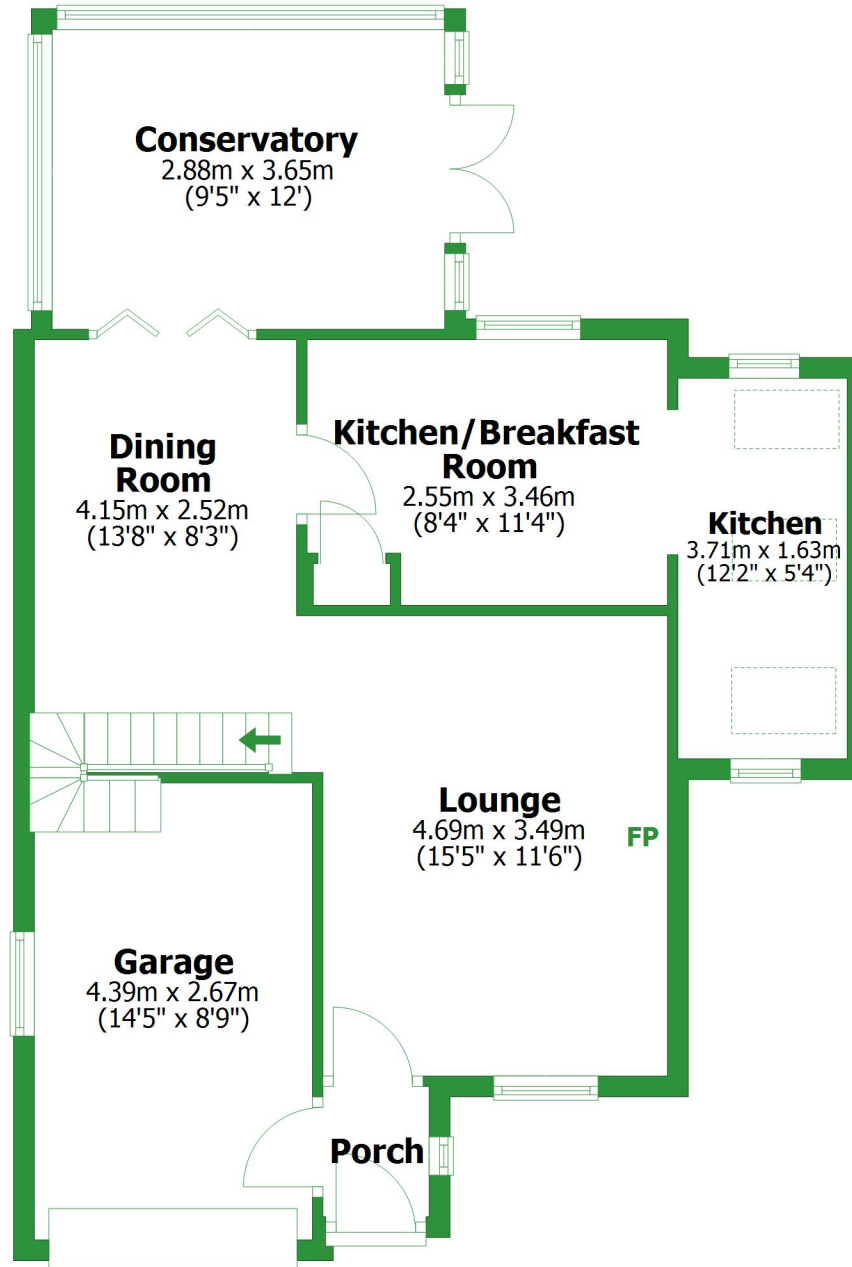

Total area: approx. 109.1 sq. metres (1174.6 sq. feet)

For illustrative purposes only. Not to scale. All sizes are approximate.  
Plan produced using PlanUp.

# First Floor

Approx. 42.9 sq. metres (462.3 sq. feet)

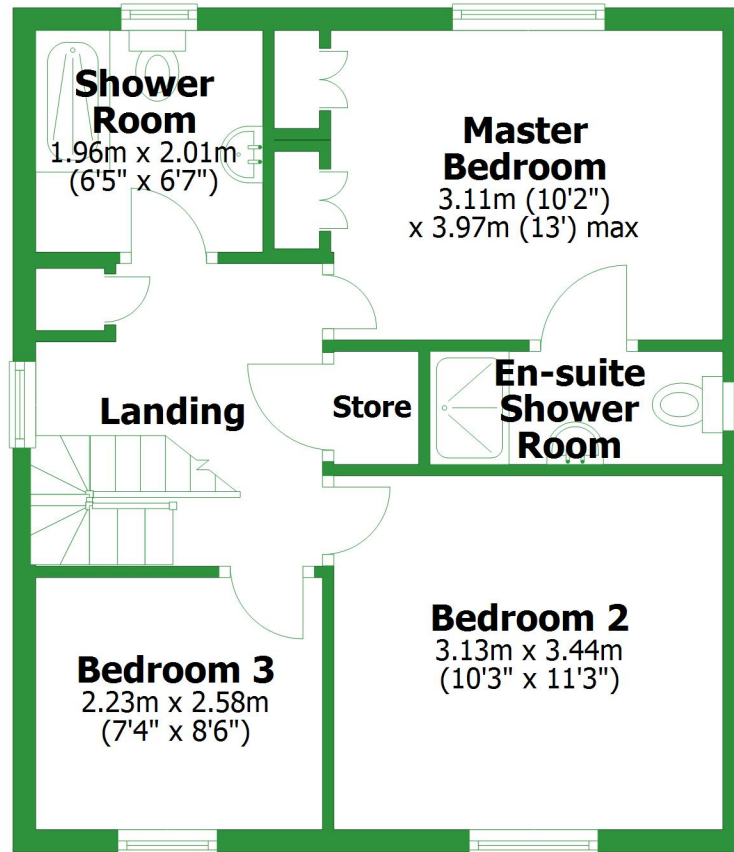

## Ground Floor

Approx. 66.2 sq. metres (712.3 sq. feet)

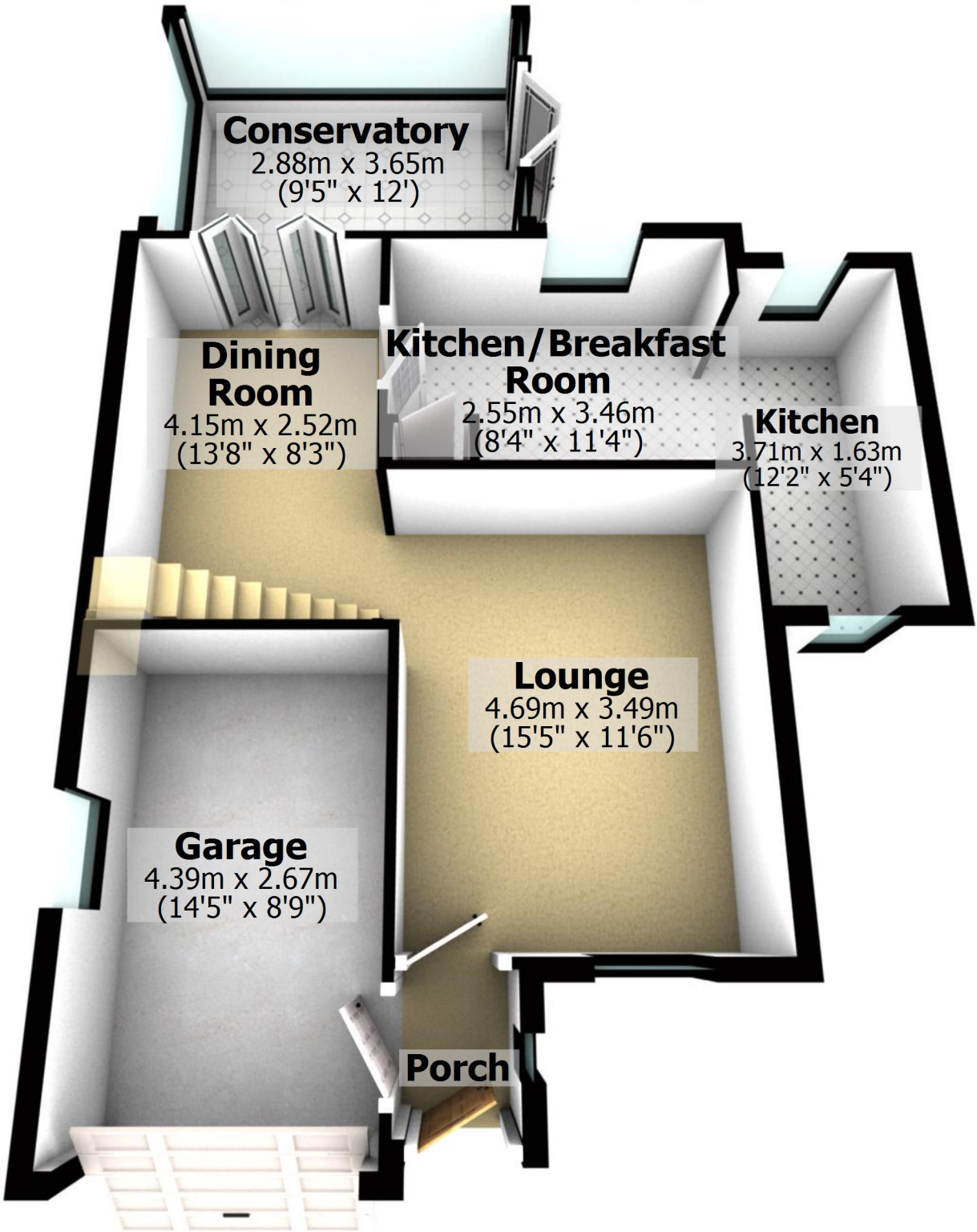

Total area: approx. 109.1 sq. metres (1174.6 sq. feet)

For illustrative purposes only. Not to scale. All sizes are approximate.

Plan produced using PlanUp.

## First Floor

Approx. 42.9 sq. metres (462.3 sq. feet)

