

## Ground Floor

Approx. 105.6 sq. metres (1136.6 sq. feet)

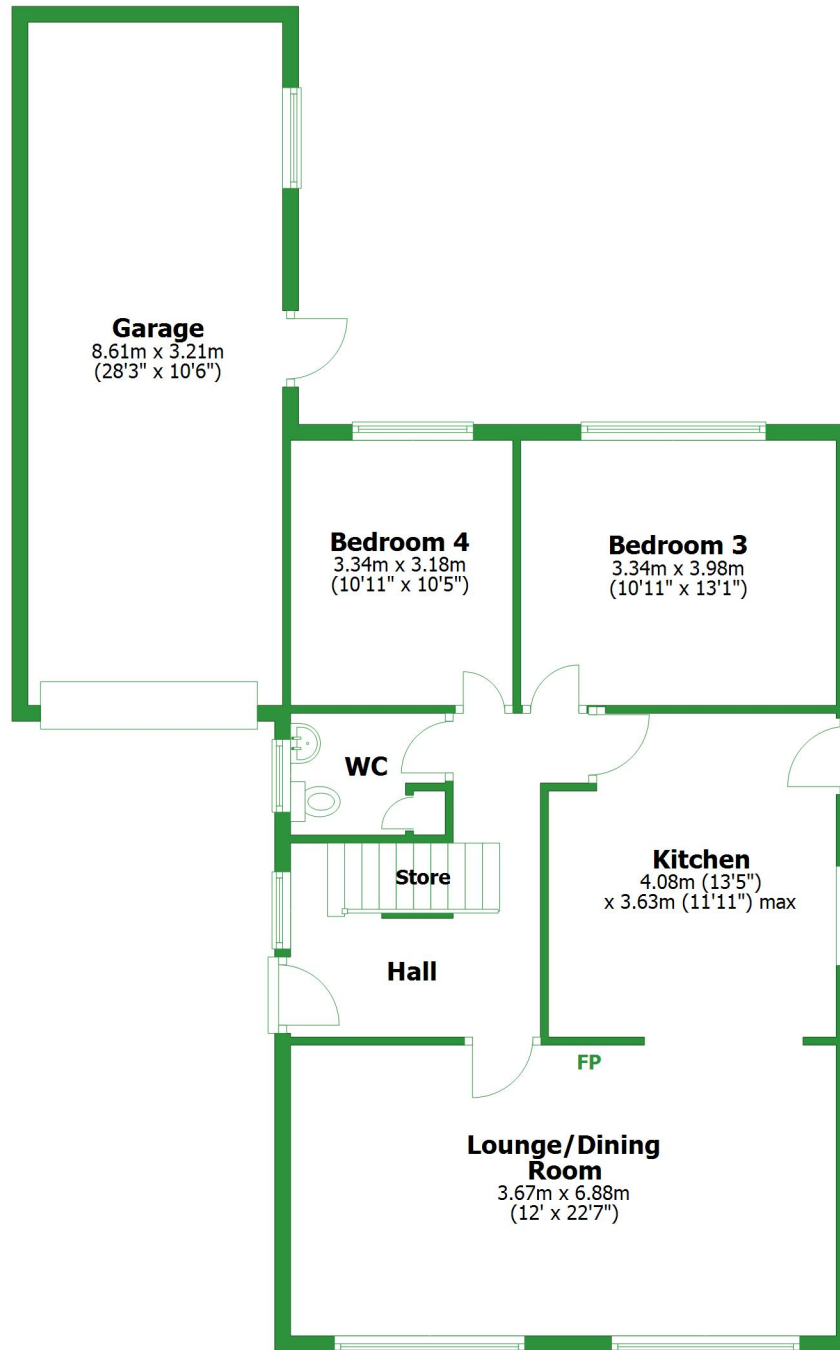

Total area: approx. 150.6 sq. metres (1621.0 sq. feet)

For illustrative purposes only. Not to scale. All sizes are approximate.  
Plan produced using PlanUp.

## First Floor

Approx. 45.0 sq. metres (484.3 sq. feet)

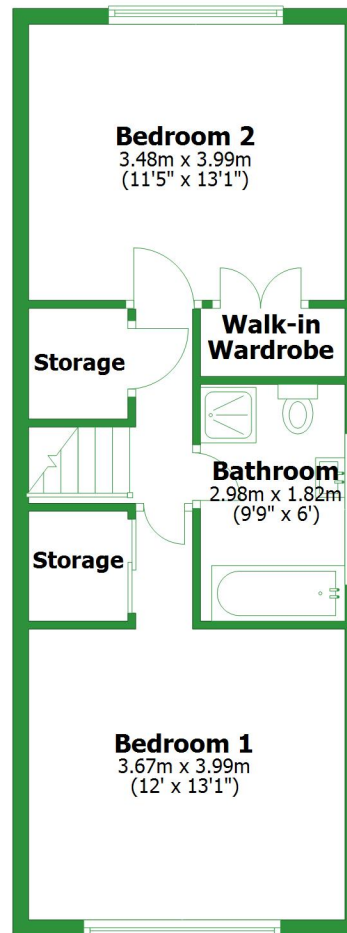

## Ground Floor

Approx. 105.6 sq. metres (1136.6 sq. feet)

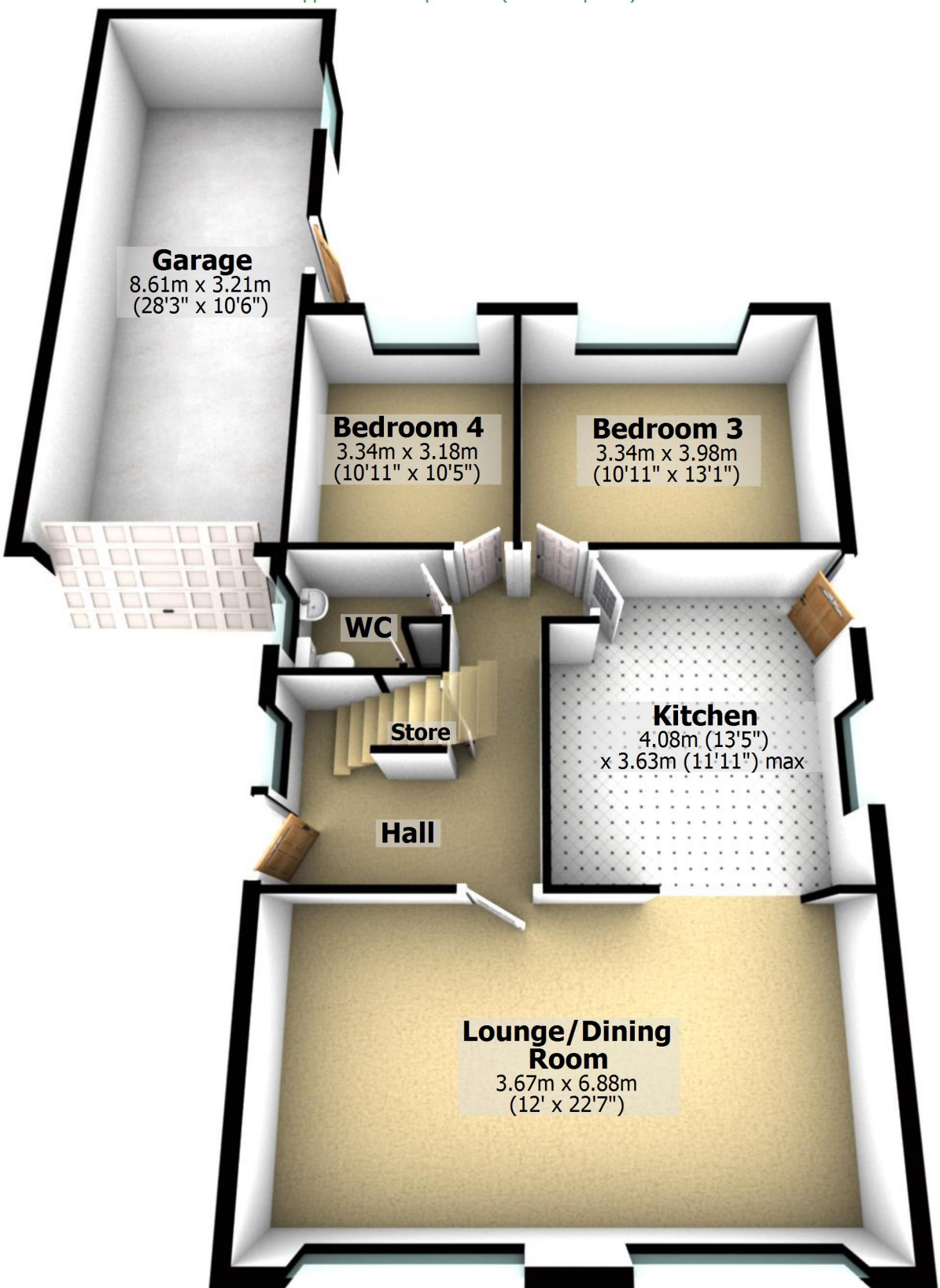

Total area: approx. 150.6 sq. metres (1621.0 sq. feet)

For illustrative purposes only. Not to scale. All sizes are approximate.

Plan produced using PlanUp.

# First Floor

Approx. 45.0 sq. metres (484.3 sq. feet)

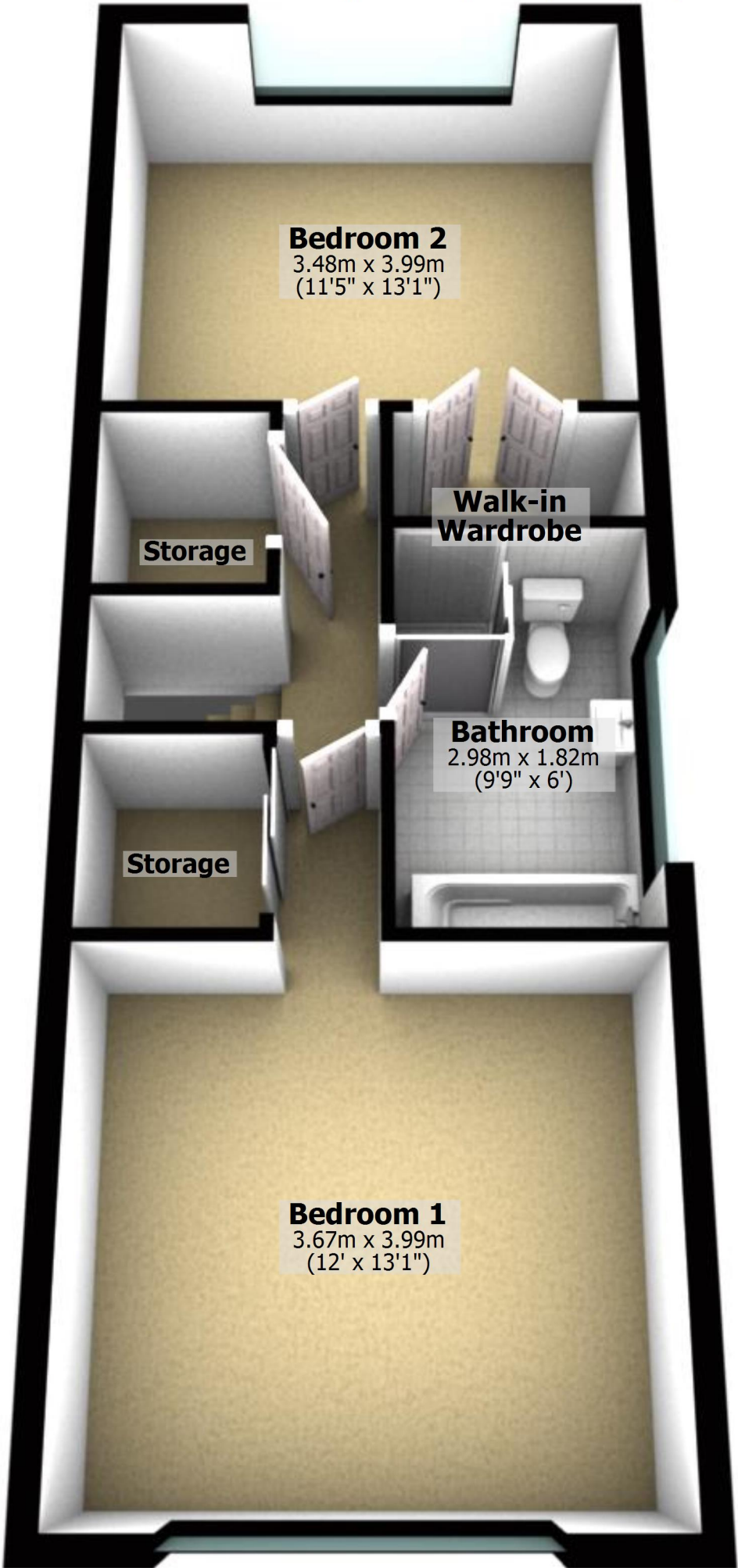

**Bedroom 2**  
3.48m x 3.99m  
(11'5" x 13'1")

**Storage**

**Walk-in  
Wardrobe**

**Bathroom**  
2.98m x 1.82m  
(9'9" x 6')

**Storage**

**Bedroom 1**  
3.67m x 3.99m  
(12' x 13'1")